

39°07'30" N
103°00' W

UNITED STATES
DEPARTMENT OF THE INTERIOR
GEOLOGICAL SURVEY



STRATTON 3 SW QUADRANGLE
COLORADO
7.5 MINUTE SERIES (TOPOGRAPHIC)

39°07'30" N
102°52'30" W

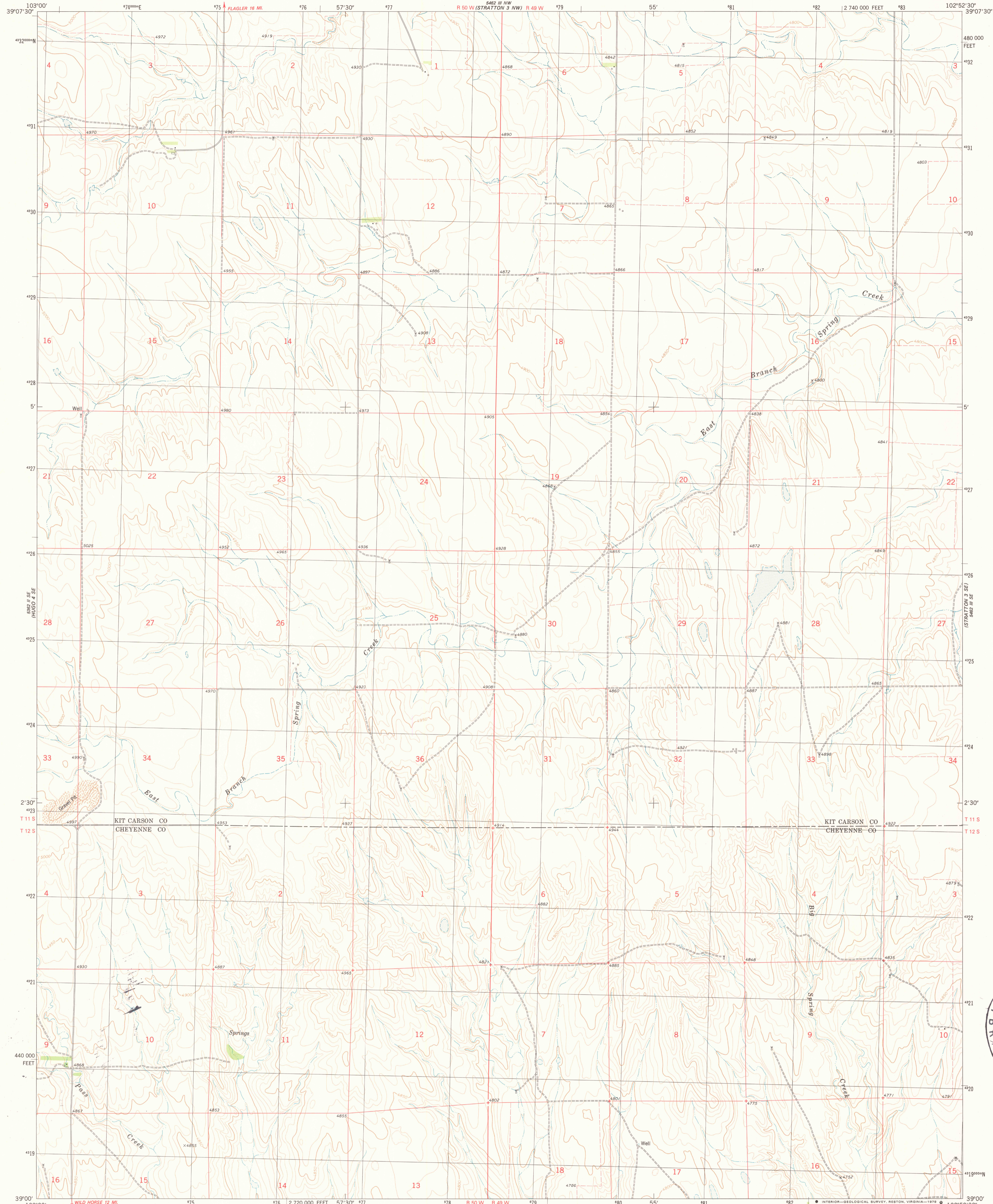

Mapped, edited, and published by the Geological Survey
Control by USGS and NOS/NOAA
Topography by photogrammetric methods from aerial photographs
taken 1973. Field checked 1975. Map edited 1979
Projection and 10,000-foot grid ticks. Colorado
coordinate system, central zone (Lambert conformal conic)
1000-meter Universal Transverse Mercator grid, zone 13
1927 North American datum
Fine red dashed lines indicate selected fence lines

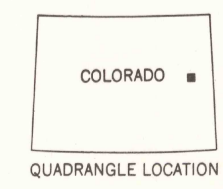
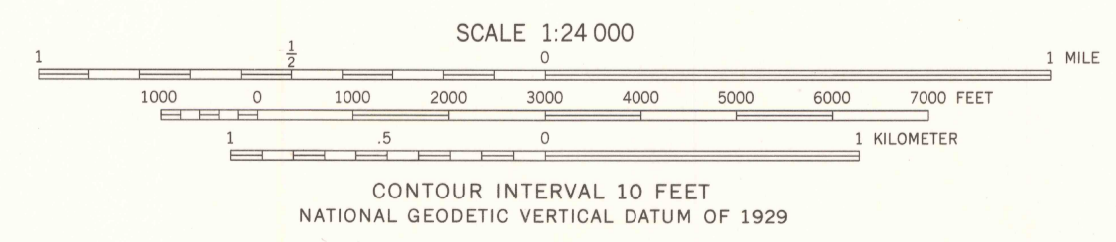
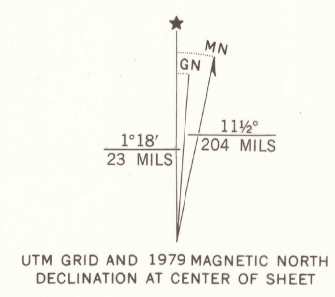

ROAD CLASSIFICATION
Primary highway, hard surface
Secondary highway, hard surface
Light-duty road, hard or improved surface
Unimproved road
Interstate Route
U.S. Route
State Route

STRATTON 3 SW, COLO.
N3900-W10252.5/7.5

1979

DMA 5462 III SW—SERIES V877

THIS MAP COMPLIES WITH NATIONAL MAP ACCURACY STANDARDS
FOR SALE BY U.S. GEOLOGICAL SURVEY, DENVER, COLORADO 80225, OR RESTON, VIRGINIA 22092
A FOLDER DESCRIBING TOPOGRAPHIC MAPS AND SYMBOLS IS AVAILABLE ON REQUEST

