

U. S. G. S.
FILE COPY

UNITED STATES
DEPARTMENT OF THE INTERIOR
GEOLOGICAL SURVEY

STATE OF COLORADO
STATE HIGHWAY DEPARTMENT CITY AND COUNTY OF DENVER
DENVER BOARD OF WATER COMMISSIONERS

COLORADO
(ADAMS COUNTY)
EASTLAKE QUADRANGLE

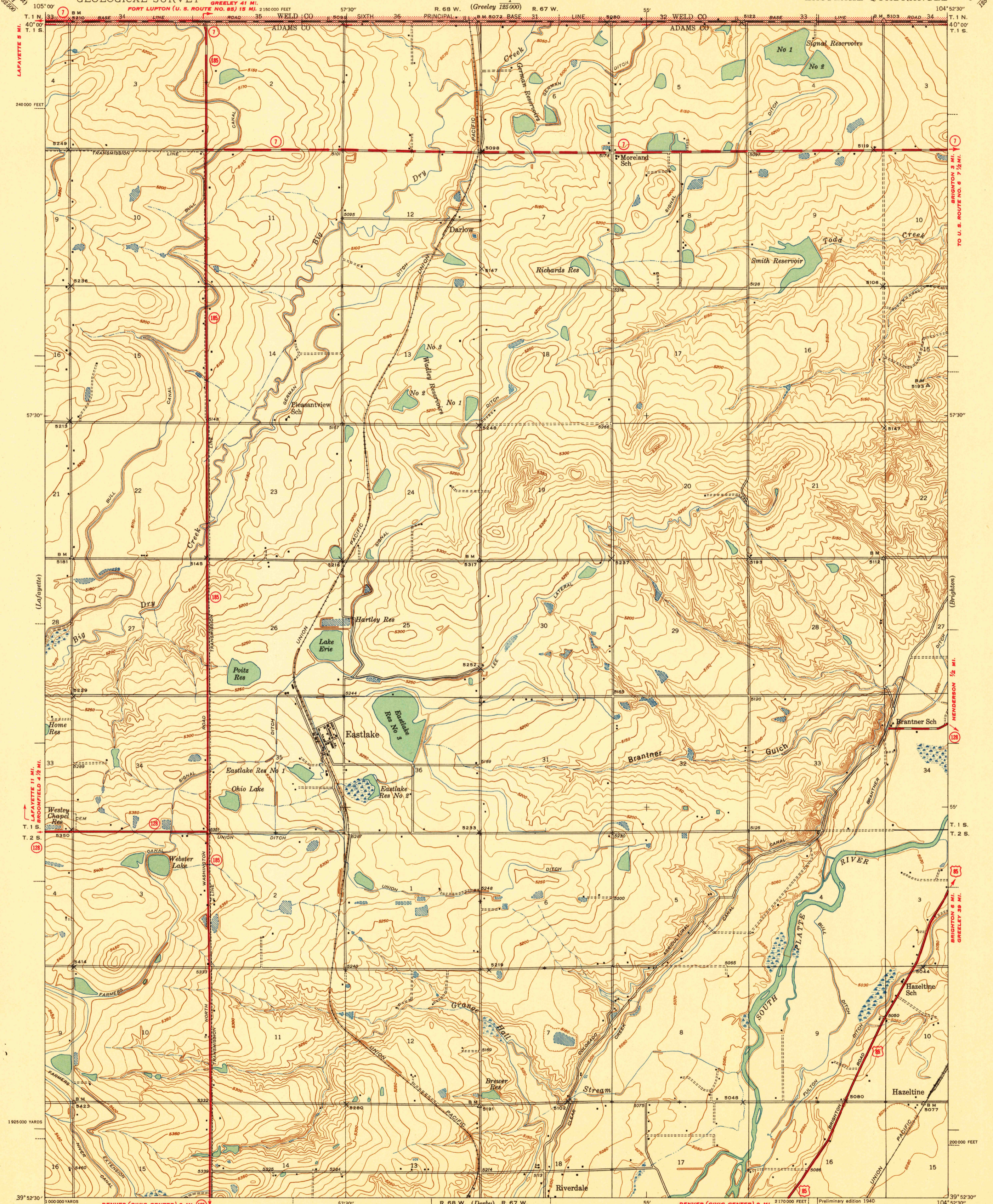

Glenn S. Smith, Division Engineer
Topography by B. A. McNally, and J. H. Summers
Surveyed in 1938
Work Projects Administration Nos. 2552-3031-3687
Colorado State Highway Department, City and County of Denver,
Denver Board of Water Commissioners, Sponsors
Fred Graf, Jr., Geological Survey, Supervisor

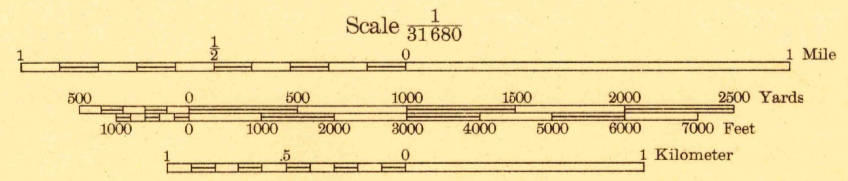

Contour interval 10 feet
Datum is mean sea level

USGS
Historical File
Topographic Division

HARD IMPERVIOUS SURFACES
OTHER SURFACE IMPROVEMENTS
1940
② U. S. ROUTE
③ STATE ROUTE

EASTLAKE, COLO.

N 3952.5 - W 10452.5 / 7.5
DEC 13 1940

U. S. G. S.
FILE COPY
Inspection and Filing