

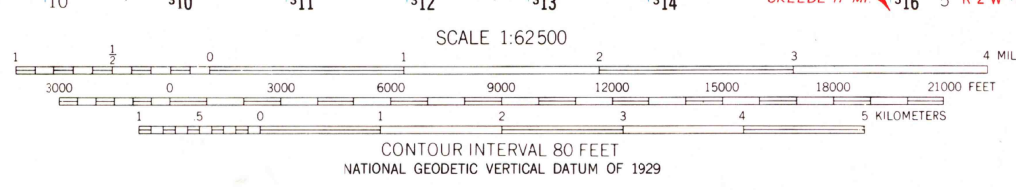

Maped, edited, and published by the Geological Survey
Control by USGS and USCGS
Topography from aerial photographs by photogrammetric methods
Aerial photographs taken 1951. Field check 1959
Polyconic projection. 1927 North American Datum
10 000 foot grid based on Colorado coordinate system,
south zone
1000 meter Universal Transverse Mercator grid ticks,
zone 13, shown in blue
Dashed land lines indicate approximate locations
Land lines surveyed in T. 42 N. - R. 1 W.
Land lines omitted in T. 42 and 43 N. - R. 2 W. and
in T. 43 N. - R. 1 W. because of insufficient data
Areas covered by dashed light blue pattern are subject
to controlled inundation
To place on the predicted North American Datum 1983
move the projection lines 3 meters north and
53 meters east
There may be private inholdings within the boundaries of
the National or State reservations shown on this map

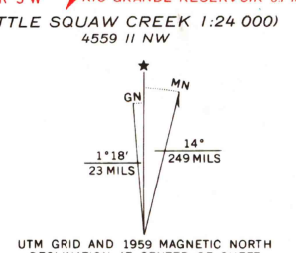

THIS MAP COMPLIES WITH NATIONAL MAP ACCURACY STANDARDS
FOR SALE BY U. S. GEOLOGICAL SURVEY, DENVER, COLORADO 80225, OR RESTON, VIRGINIA 22092
A FOLDER DESCRIBING TOPOGRAPHIC MAPS AND SYMBOLS IS AVAILABLE ON REQUEST

ROAD CLASSIFICATION
Light duty ——— Unimproved dirt - - - - -

COLORADO
QUADRANGLE LOCATION

BRISTOL HEAD, COLO.
37107-61-TF-062
1959
FEB 20 1987
DMA 4559 - SERIES V777