

MAPPED BY U.S.G.S. IN 1887

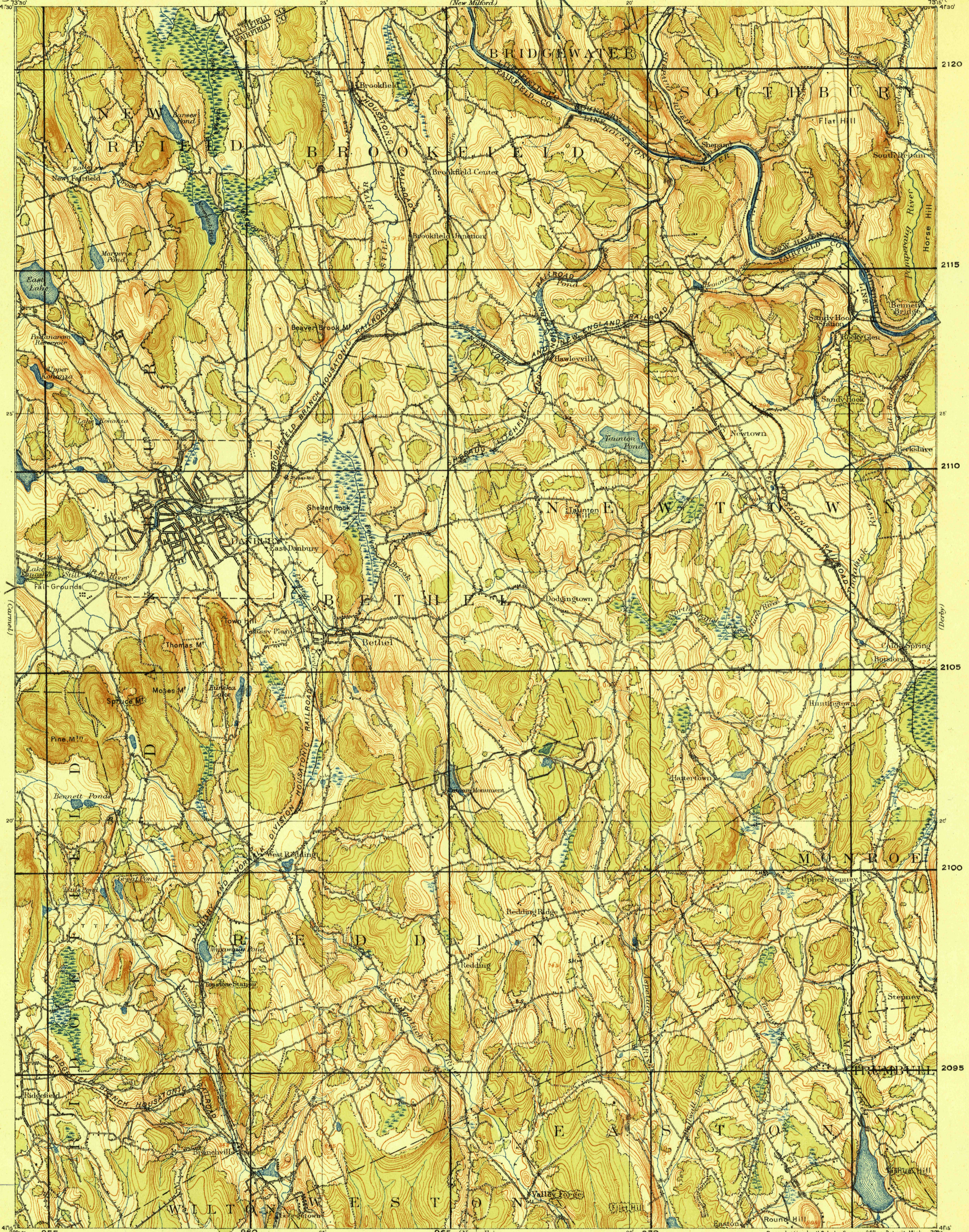

Base map from U. S. G. S. engravings.
Corrections and additions by Department Engineer,
Eastern Department.
Additional field work and compilation under the direction of
Colonel H. Taylor, Corps of Engineers, U. S. Army,
Department Engineer, Eastern Department.
Additional field work under the immediate supervision of
1st. Lieut. G. F. Lewis, C. of E., Detach. of Co. D,
1st. Battalion Engineers, Dec. 1915.

Reprint E. R. P. 1921

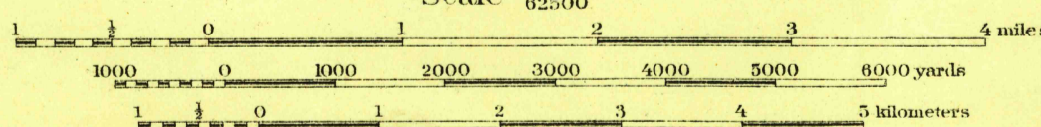

Contour Interval 20 feet

Datum is mean sea level

FIVE THOUSAND YARD GRID COMPUTED FROM "GRID SYSTEM FOR PROGRESSIVE MAPS
IN THE U.S." ZONE A, U.S.C. & G.S. SPECIAL PUBLICATION NO. 59.
(THE LAST THREE DIGITS OF THE GRID NUMBERS ARE OMITTED)

NOTE: OFFICERS USING THIS MAP WILL MARK HEREON CORRECTIONS AND ADDITIONS WHICH COME
TO THEIR ATTENTION AND MAIL DIRECT TO "THE CHIEF OF ENGINEERS, WASHINGTON, D.C."

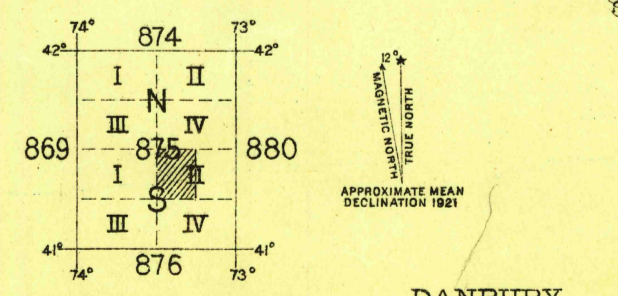

APPROXIMATE MEAN DECLINATION 1921

DANBURY

FILE COPY
RETURN TO:
HISTORICAL MAP ARCHIVES
USGS NATIONAL CENTER, MS-522
RESTON, VA 22092

HISTORICAL FILES
(DO NOT REMOVE)