

Base map from U. S. G. S. engravings.
Corrections and additions by Department Engineer,
Eastern Department.
Additional field work and compilation under the
direction of Col. W. M. Black, Corps of Engineers,
U.S.A., Department Engineer, Eastern Department.
June 23, 1914.

Additional field work under the immediate supervision
of 1st Lieut. R. R. Lyon, C. A. C.
Soundings expressed in feet and referred to mean
low water, are from U. S. C. & G. S. Charts,
Nos. 260, 261 & 362.

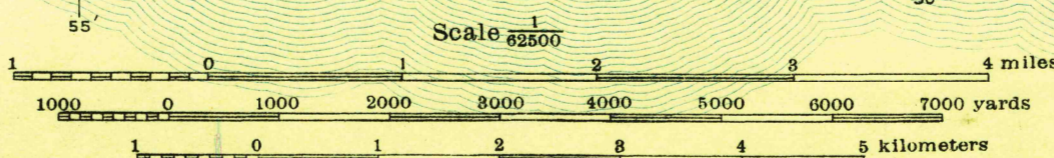

Contour Interval 20 feet
Datum is mean sea level

FIVE THOUSAND YARD GRID COMPUTED FROM "GRID SYSTEM FOR PROGRESSIVE MAPS
IN THE U.S." ZONE A. U.S.C.&G.S. SPECIAL PUBLICATION NO. 59.
(THE LAST THREE DIGITS OF THE GRID NUMBERS ARE OMITTED)

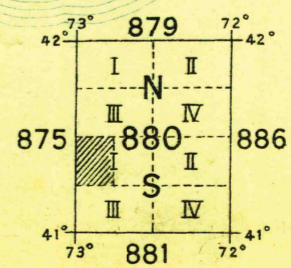

1889-90