

MAPPED BY U.S.G.S.M. / 587

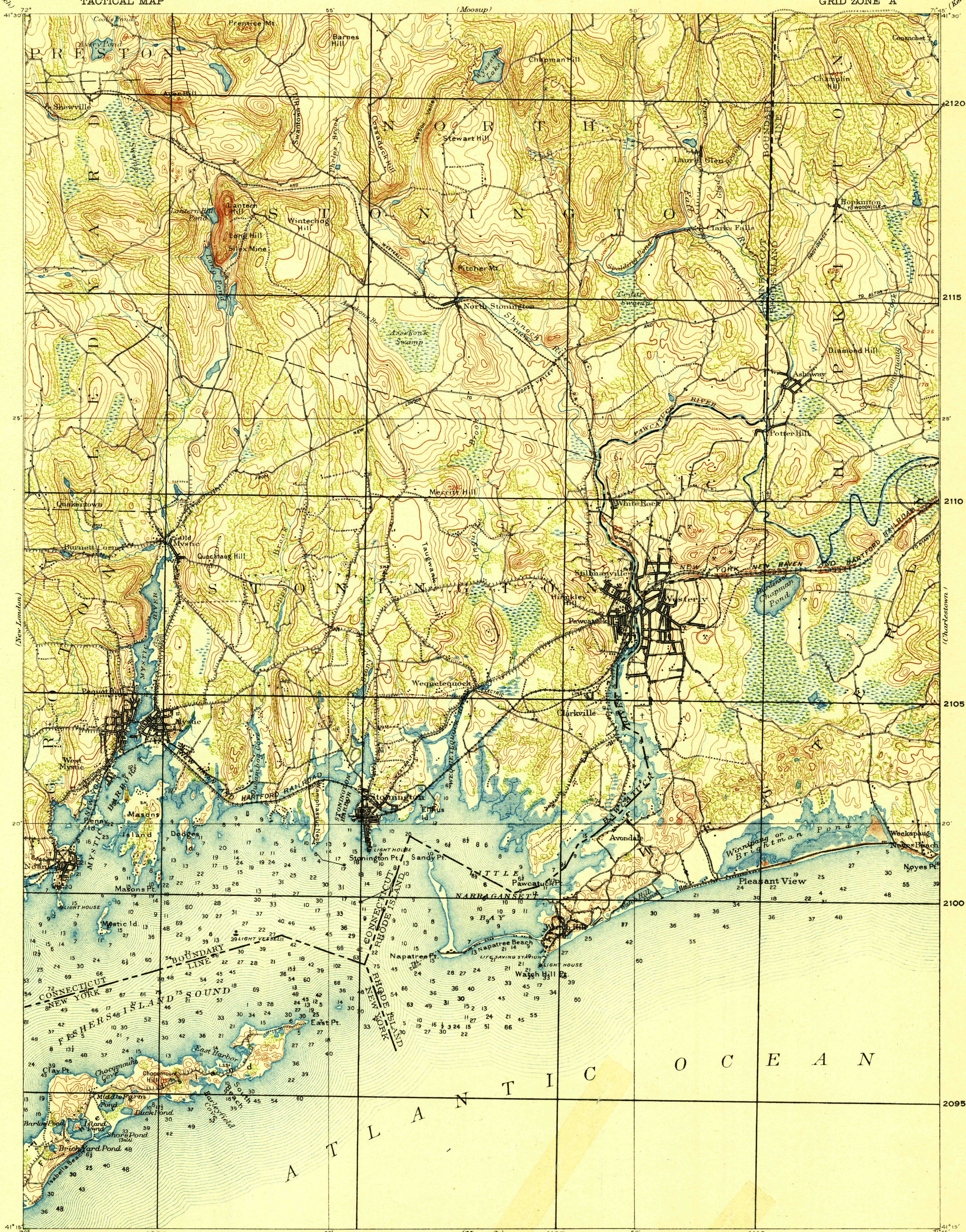

Base map from U. S. G. S. engravings.
Corrections and additions by Dept. Engineer,
Eastern Department.

Additional field work and compilation under
the direction of Col. W. M. Black, Corps
Engineers, U. S. A., Department Engineer,
Eastern Department.

Additional field work by 1st Lieuts. R. P.
Glassburn, R. R. Lyon and 2nd. Lieut. Thomas
I. Steere C. A. C., U. S. A.
1910 - 13.

Soundings expressed in feet and referred to
mean low water, are from U. S. C. & G. S.
Chart 114, Mean range of tide 2.7 feet.

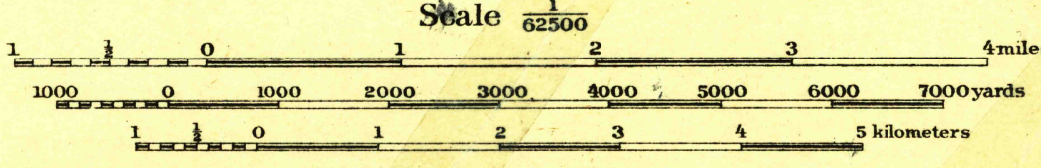

NOTE: OFFICERS USING THIS MAP WILL MARK HEREON CORRECTIONS AND ADDITIONS WHICH COME
TO THEIR ATTENTION AND MAIL DIRECT TO "THE CHIEF OF ENGINEERS, WASHINGTON, D.C."

FIVE THOUSAND YARD GRID COMPUTED FROM "GRID SYSTEM FOR PROGRESSIVE MAPS
IN THE U. S." ZONE A. U. S. C. & G. S. SPECIAL PUBLICATION NO. 59.
(THE LAST THREE DIGITS OF THE GRID NUMBERS ARE OMITTED)

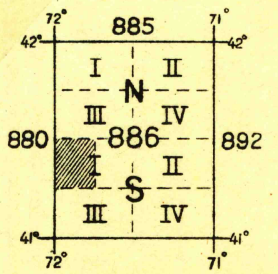

APPROXIMATE MEAN
DECLINATION 1921

STONINGTON

Engineer Reproduction Plant, U. S. Army, Washington Barracks, D.C.
1921