

MAPPED BY U.S.G.S.M. 1790

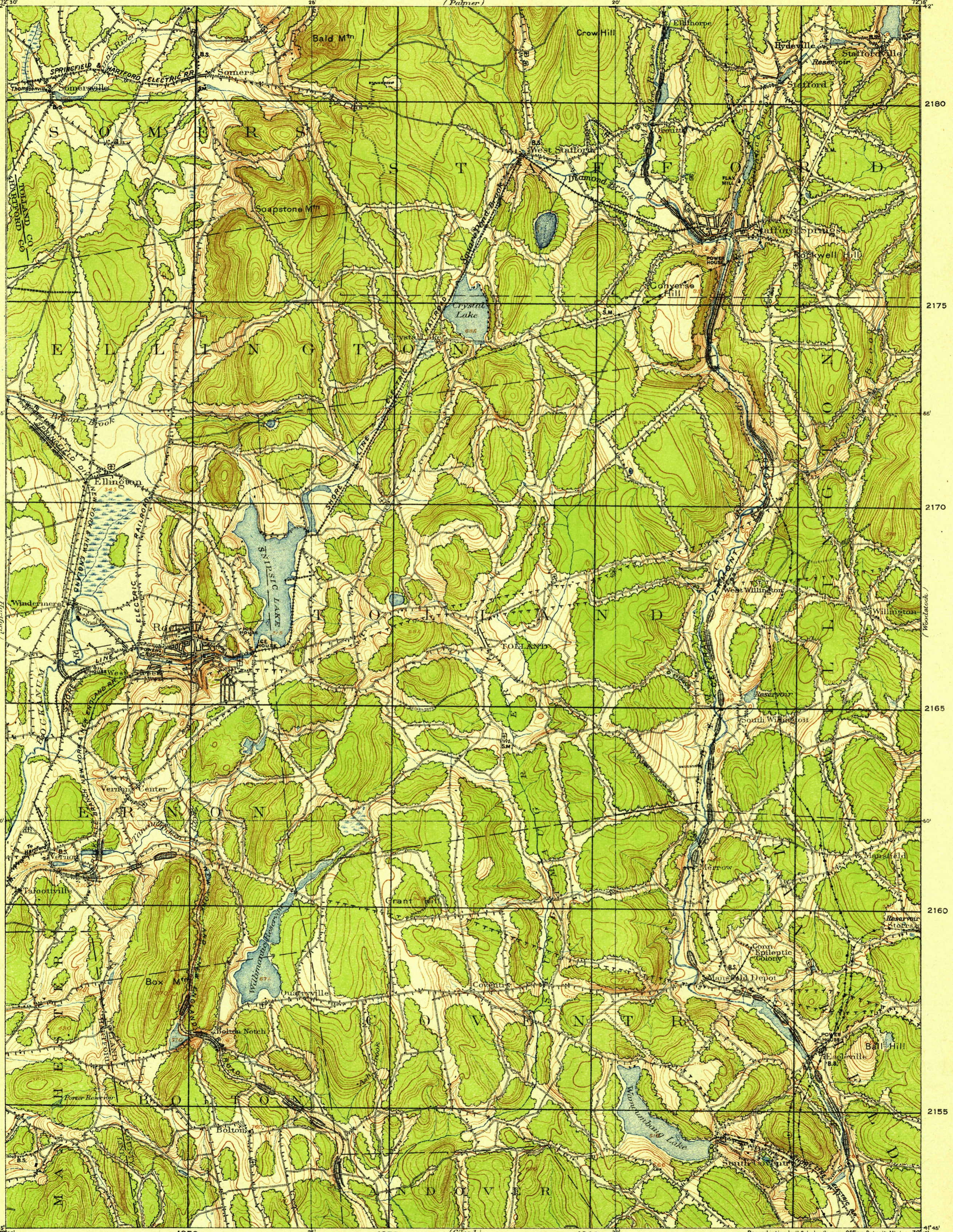

Base map from U. S. G. S. engravings.
Corrections and additions by Department
Engineer, Eastern Department.
Additional field work and compilation under
the direction of Col. H. Taylor, Corps of Engrs.,
U. S. A., Department Engr., Eastern Dept.
Additional field work by 1st Lieut. J. A. Barry,
2nd Cavalry; 2nd Lieut. M. O. French, 3rd
Infantry; 2nd Lieut. E. deT. Ellis, 2nd Cav.
1915.

Reprint E. R. P. 1921

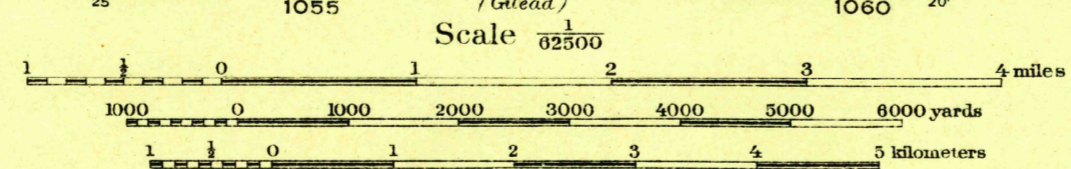

Scale 1:25,000
Contour Interval 20 feet
Datum is mean sea level

FIVE THOUSAND YARD GRID COMPUTED FROM "GRID SYSTEM FOR PROGRESSIVE MAPS
IN THE U.S." ZONE A, U.S.C. & G.S. SPECIAL PUBLICATION NO. 59.
(THE LAST THREE DIGITS OF THE GRID NUMBERS ARE OMITTED)

NOTE: OFFICERS USING THIS MAP WILL MARK HEREON CORRECTIONS AND ADDITIONS WHICH COME
TO THEIR ATTENTION AND MAIL DIRECT TO "THE CHIEF OF ENGINEERS, WASHINGTON, D.C."

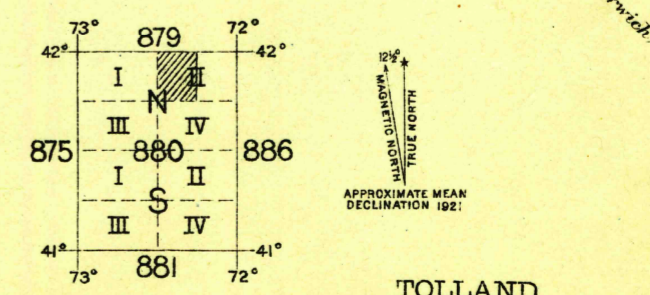

TOLLAND

RETURN TO:
USGS AND HISTORICAL MAP ARCHIVES