

Feet Meters

1	3048
2	6096
3	9144
4	12192
5	15240
6	18288
7	21336
8	24384
9	27432
10	30480

To convert feet to meters multiply by 3.048  
To convert meters to feet multiply by 3.2808

1. Dryland
2. Wetlands (May be partially submerged at mean high tide)
3. Exposed at mean low tide

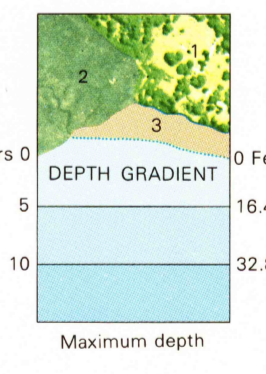

Produced by the Geological Survey and the National Ocean Survey  
Control by the USGS and NOS/NOAA  
Orthophotomap prepared from aerial photograph taken January 10, 1976. Topography by photogrammetric methods from aerial photographs taken January, 1975 and planetable surveys 1978. Field checked 1978. Map edited 1981. Supersedes topographic map dated 1950.  
Bathymetry compiled by the National Ocean Survey from tide-coordinated hydrographic surveys.  
This information is not intended for navigational purposes.  
Mean low water (dotted line) and mean high water (solid line) compiled by NOS from tide-coordinated aerial photographs. Apparent shoreline (outer edge of vegetation) shown by photomaps.  
Projection and 10,000-foot grid ticks: Florida coordinate system, north zone (Lambert conformal conic).  
1000-meter Universal Transverse Mercator grid, zone 16 1927 North American Datum  
To place on the predicted North American Datum 1983 move the projection lines 21 meters south and 8 meters west as shown by dashed corner ticks.  
Dotted land lines established by private subdivision of the Forbes Purchase.  
There may be private inholdings within the boundaries of the National or State reservations shown on this map.

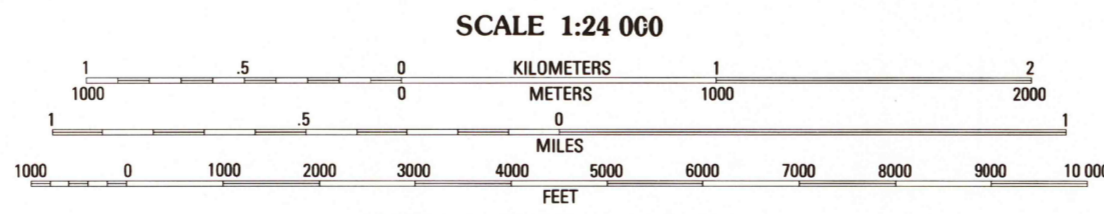
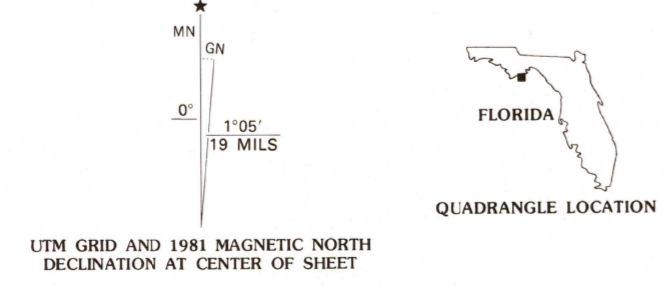

CONTOUR INTERVAL 2 METERS  
SUPPLEMENTARY CONTOUR INTERVAL 1 METER  
NATIONAL GEODETIC VERTICAL DATUM OF 1929  
CONTROL ELEVATIONS SHOWN TO THE NEAREST 0.1 METER  
OTHER ELEVATIONS SHOWN TO THE NEAREST 0.5 METER  
BATHYMETRIC CONTOUR INTERVAL 1 METER WITH SUPPLEMENTARY 0.5 METER CONTOURS—GULF COAST LOW WATER DATUM  
THE RELATIONSHIP BETWEEN THE TWO DATUMS IS VARIABLE  
THE MEAN RANGE OF TIDE IS APPROXIMATELY 0.7 METERS  
BASE MAP COMPLIES WITH NATIONAL MAP ACCURACY STANDARDS  
BATHYMETRIC SURVEY DATA COMPLIES WITH INTERNATIONAL HYDROGRAPHIC ORGANIZATION (IHO) SPECIAL PUBLICATION 44 ACCURACY STANDARDS AND/OR STANDARDS USED AT THE DATE OF THE SURVEY  
FOR SALE BY THE GEOLOGICAL SURVEY, RESTON, VIRGINIA 22092 AND NATIONAL OCEAN SURVEY, ROCKVILLE, MARYLAND 20852  
A FOLDER DESCRIBING TOPOGRAPHIC MAPS AND SYMBOLS IS AVAILABLE ON REQUEST

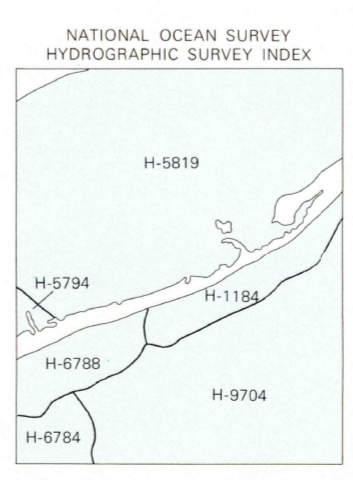

ROAD CLASSIFICATION  
Primary highway, hard surface — Light-duty road, hard or improved surface  
Secondary highway, hard surface — Unimproved road  
Trails —  
Interstate Route U.S. Route State Route  
County Route

CONTOURS AND ELEVATIONS IN METERS  
GOOSE ISLAND, FLA.  
29084-F7-TB-024  
1981  
DMA 4043 III NE-SERIES V8470