

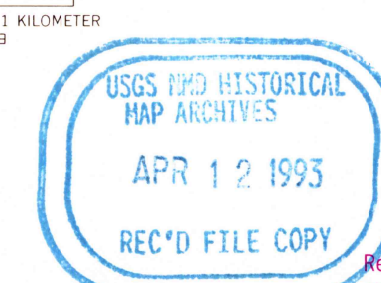

Mapped by the U.S. Coast and Geodetic Survey  
Edited and published by the Geological Survey  
Control by USC&GS and Florida Geodetic Survey  
Planimetry by photogrammetric methods from aerial photographs taken 1949. Topography by planetable surveys 1950  
Revised by the Geological Survey from aerial photographs taken 1962. Field checked 1964  
Projection and 10,000-foot grid ticks: Florida coordinate system, east zone (transverse Mercator)  
1000-meter Universal Transverse Mercator grid ticks, zone 17, shown in blue 1927 North American Datum (NAD 27)  
North American Datum of 1983 (NAD 83) is shown by dashed corner ticks  
The values of the shift between NAD 27 and NAD 83 for 7.5-minute intersections are given in USGS Bulletin 1875  
There may be private inholdings within the boundaries of the National or State reservations shown on this map

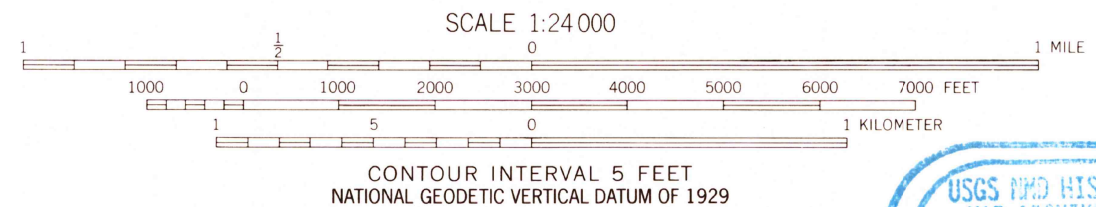
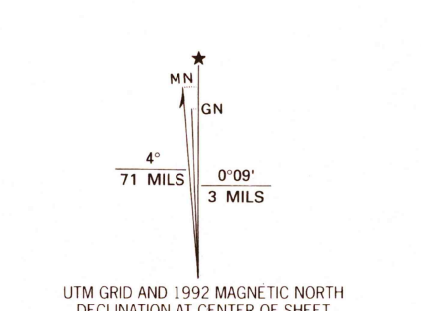

ROAD CLASSIFICATION

|                                 |   |
|---------------------------------|---|
| Primary highway, hard surface   | Light-duty road, hard or improved surface |
| Secondary highway, hard surface | Unimproved road                           |
| Interstate Route                | U.S. Route                                |
|                                 | State Route                               |

THIS MAP COMPLIES WITH NATIONAL MAP ACCURACY STANDARDS FOR SALE BY U.S. GEOLOGICAL SURVEY  
DENVER, COLORADO 80225, OR RESTON, VIRGINIA 22092  
A FOLDER DESCRIBING TOPOGRAPHIC MAPS AND SYMBOLS IS AVAILABLE ON REQUEST

Revisions shown in purple and woodland compiled in cooperation with State of Florida agencies from aerial photographs taken 1990 and other sources  
Contours not revised. This information not field checked  
Map edited 1992

**MICKLER LANDING, FLA.**  
NE/4 PALM VALLEY 15' QUADRANGLE  
30081-B3-TF-024  
1964  
REVISED 1992  
DMA 4744 III NE - SERIES V847