

Produced by the United States Geological Survey  
Control by USGS, NOS/NOAA, and Florida Geodetic Survey  
Topography by photogrammetric methods from aerial photographs taken 1967. Field checked 1968  
Projection and 10,000-foot grid ticks: Florida coordinate system, north zone (Lambert conformal conic)  
1000-meter Universal Transverse Mercator grid ticks, zone 17, shown in blue  
1927 North American Datum (NAD 27)  
North American Datum of 1983 (NAD 83) is shown by dashed corner ticks  
The values of the shift between NAD 27 and NAD 83 for 7.5-minute intersections are given in USGS Bulletin 1875  
Fine red dashed lines indicate selected fence and field lines where generally visible on aerial photographs. This information is unchecked

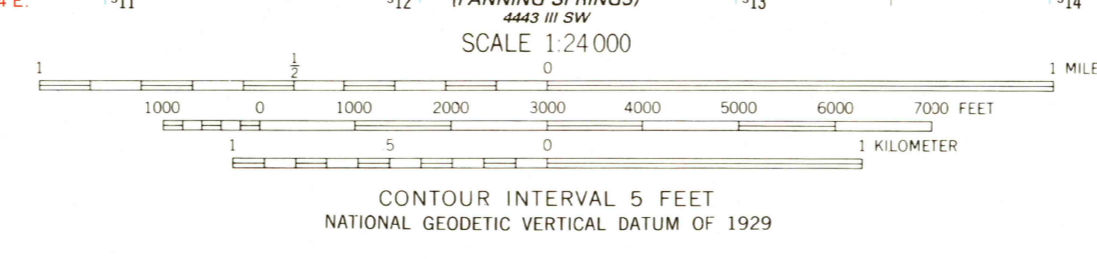
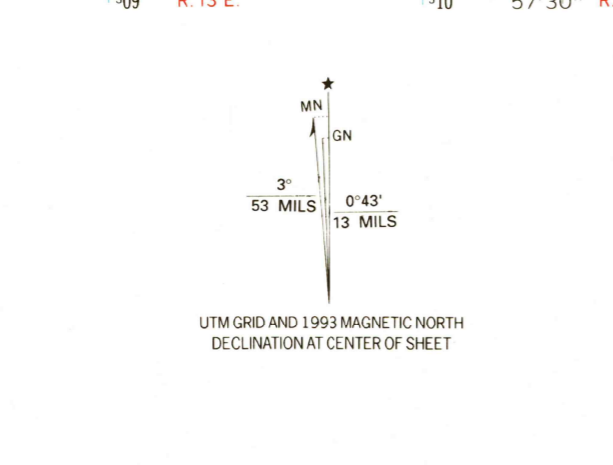

THIS MAP COMPLIES WITH NATIONAL MAP ACCURACY STANDARDS  
FOR SALE BY U. S. GEOLOGICAL SURVEY, DENVER, COLORADO 80225, OR RESTON, VIRGINIA 22092  
A FOLDER DESCRIBING TOPOGRAPHIC MAPS AND SYMBOLS IS AVAILABLE ON REQUEST

Revisions shown in purple and woodland compiled in cooperation with State of Florida agencies from aerial photographs taken 1989 and other sources  
Contours not revised. This information not field checked  
Map edited 1993

ROAD CLASSIFICATION  
Primary highway, hard surface  
Secondary highway, hard surface  
Light-duty road, hard or improved surface  
Unimproved road  
Interstate Route  
U. S. Route  
State Route

QUADRANGLE LOCATION  
FLORIDA

USGS AND HISTORICAL MAP ARCHIVES  
AUG 17 1995  
REC'D FILE COPY

WANNEE, FLA.  
29082-F8-1F-024  
1968  
REVISED 1993  
DMA 4443 III NW-SERIES V847