

CONTROLLED RECONNAISSANCE
2548.2650 1:99

FLORIDA
FORT DE SOTO QUADRANGLE
GRID ZONE "B"

CORPS OF ENGINEERS, U. S. ARMY
TACTICAL MAP

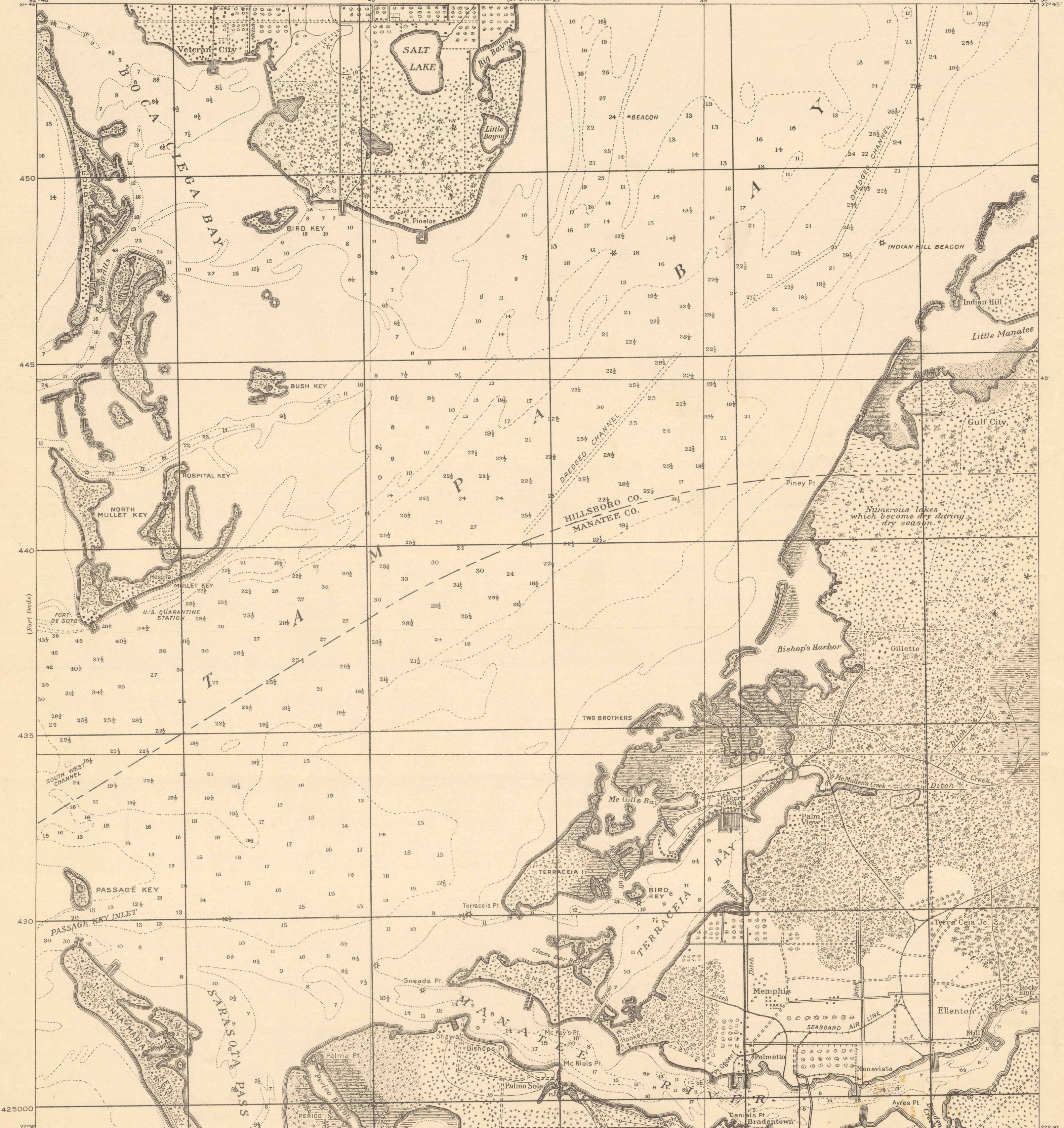

Base map from U. S. C. & G. S. Chart No. 177, map of Hillsboro Co., Nov. 1909, and other available data.
Field work and compilation under the direction of Col. W. M. Black, Corps of Engineers, U. S. A., Department Engineer, Eastern Department.
Field work by 1st Lieut. E. E. Bennett, C. A. C., U. S. A. Jan. 1911 and Jan. 1912.
Soundings referred to mean low water.
Mean range of tide 2 feet.

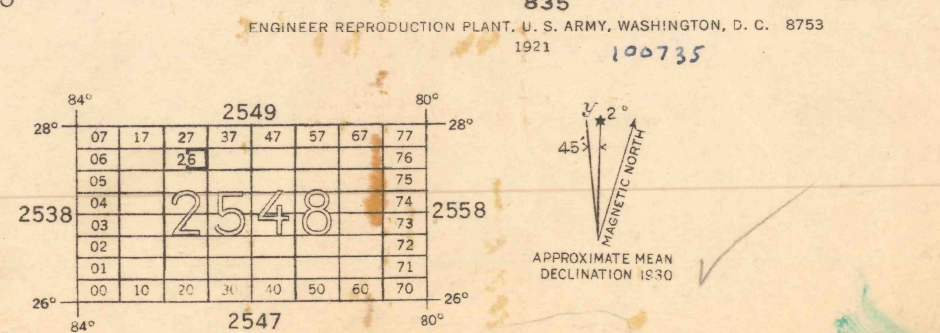
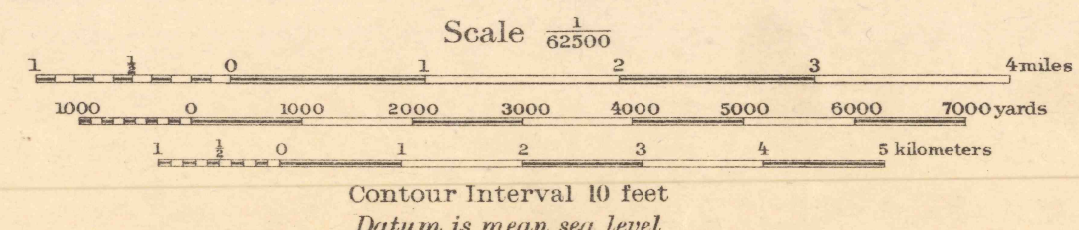

FIVE THOUSAND YARD GRID COMPUTED FROM "GRID SYSTEM FOR PROGRESSIVE MAPS IN THE U. S." ZONE B, U. S. C. & G. S. SPECIAL PUBLICATION NO. 59. (THE LAST THREE DIGITS OF THE GRID NUMBERS ARE OMITTED)

NOTE: OFFICERS USING THIS MAP WILL MARK HEREON CORRECTIONS AND ADDITIONS WHICH COME TO THEIR ATTENTION AND MAIL DIRECT TO "THE CHIEF OF ENGINEERS, WASHINGTON, D. C."

FORT DE SOTO, FLORIDA