

Produced by the United States Geological Survey in cooperation with De Kalb County agencies. Control by USGS, NOS/NOAA, Georgia Geodetic Survey and City of Atlanta. Topography by photogrammetric methods from aerial photographs taken 1955. Field checked 1956. Revised from aerial photographs taken 1988. Field checked 1991. Map edited 1992. Projection and 10,000-foot grid ticks: Georgia coordinate system, west zone (transverse Mercator). 1000-meter Universal Transverse Mercator grid, zone 16 1927 North American Datum. The difference between 1927 North American Datum and North American Datum of 1983 (NAD 83) for 7.5-minute intersections is given in USGS Bulletin 1875. The NAD 83 is shown by dashed corner ticks. There may be private inholdings within the boundaries of the National or State reservations shown on this map. Gray tint indicates areas in which only landmark buildings are shown.

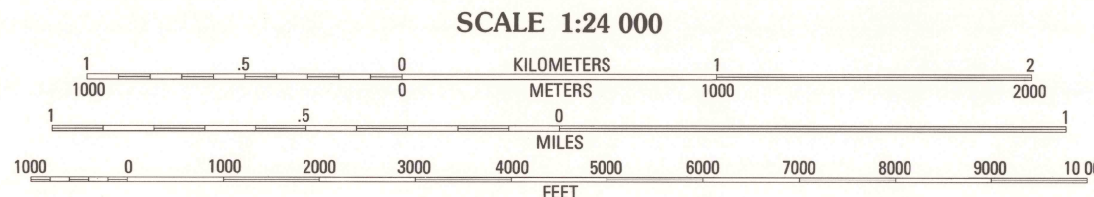

CONTOUR INTERVAL 20 FEET
NATIONAL GEODETIC VERTICAL DATUM OF 1929

COMPLIES WITH U.S. GEOLOGICAL SURVEY STANDARDS FOR SPATIAL ACCURACY - CLASS 2
FOR SALE BY U.S. GEOLOGICAL SURVEY
DENVER, COLORADO 80225, OR RESTON, VIRGINIA 22092
A FOLDER DESCRIBING TOPOGRAPHIC MAPS AND SYMBOLS IS AVAILABLE ON REQUEST

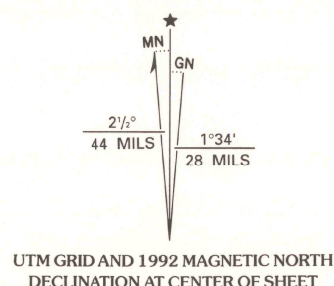
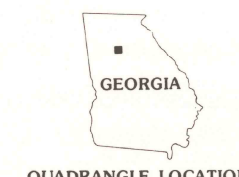

ROAD CLASSIFICATION	
Primary highway, hard surface	Light-duty road, hard or improved surface
Secondary highway, hard surface	Unimproved road
Interstate Route	U. S. Route
	State Route

STONE MOUNTAIN, GA.
33084-G2-1F-024

1992

DMA 4151 | SW-SERIES V845