

CONTROLLED RECONNAISSANCE SHEET
788-S-II-E/2
(Pineland)

GEORGIA-SOUTH CAROLINA
HARDEEVILLE QUADRANGLE

CORPS OF ENGINEERS, U.S. ARMY
PROGRESSIVE MILITARY MAP

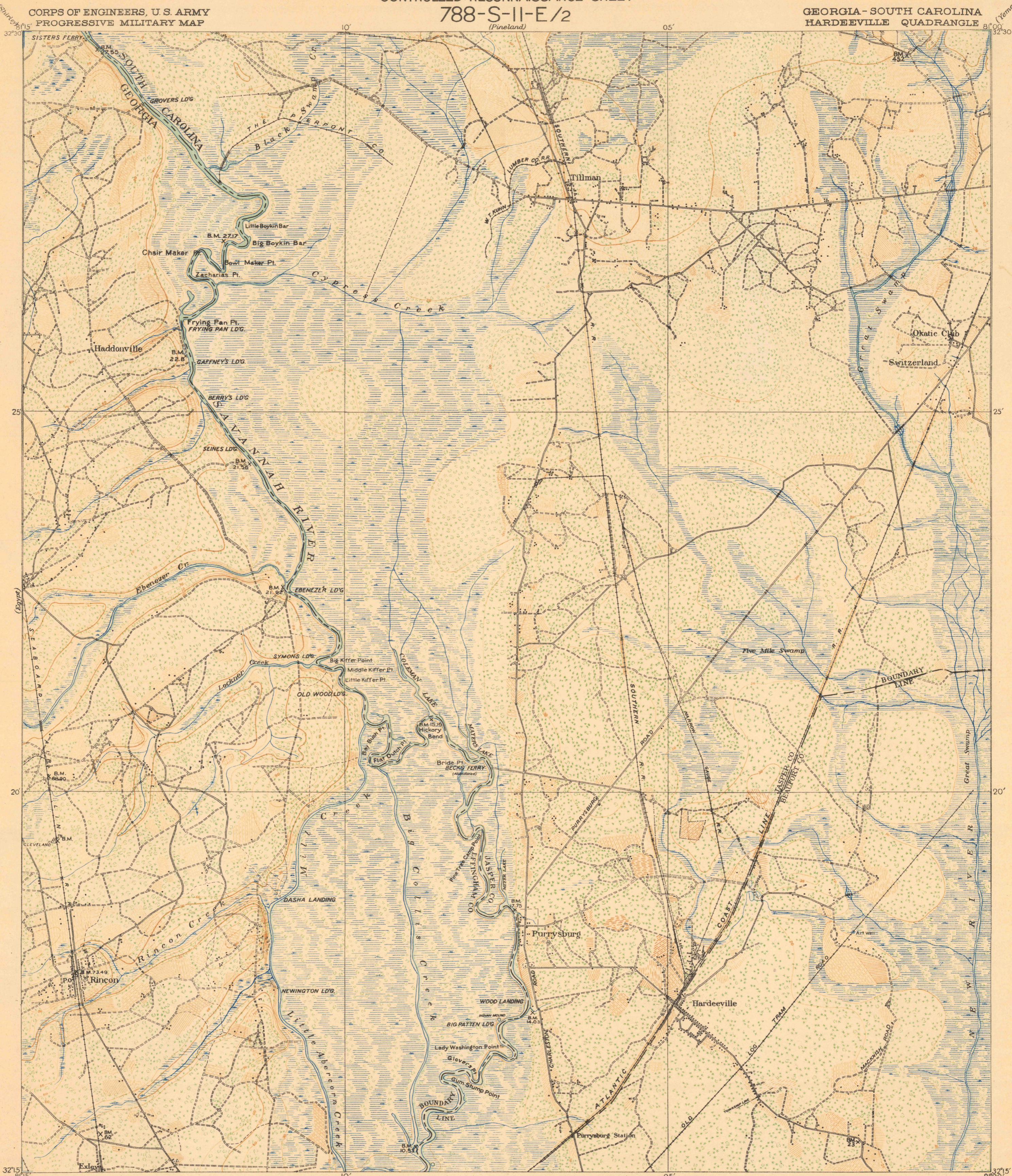

Field work by Co. B, 1st. Regiment of Engineers, 1912.
Compilation and Field Inspection by Department
Engineer, Southeastern Department, July 1918.
Control from U.S.G.S. Margins and Railroad Valuation
Surveys.

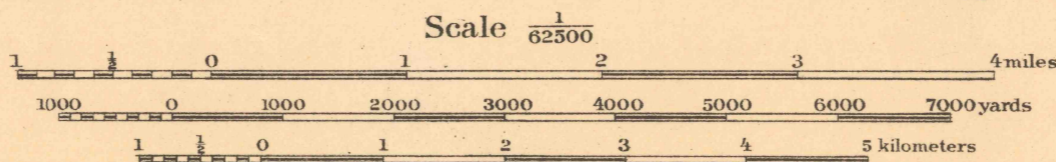

Contour Interval 10 feet
Datum is mean sea level

NOTE: OFFICERS USING THIS MAP WILL MARK HEREON CORRECTIONS AND ADDITIONS WHICH COME
TO THEIR ATTENTION AND MAIL DIRECT TO "THE CHIEF OF ENGINEERS, WASHINGTON, D.C."

FILE COPY

MAP INFORMATION OFFICE
GEOLOGICAL SURVEY

Engineer Reproduction Plant, U. S. Army, Washington Barracks, D.C.
1920

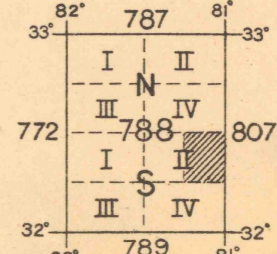

TRUE NORTH
MAGNETIC NORTH
APPROXIMATE MEAN
DECLINATION 1920

HARDEEVILLE

GA.