

Produced by the United States Geological Survey  
in cooperation with State of Iowa agencies  
Control by USGS and NOS/NOAA  
Topography by photogrammetric methods from aerial photographs  
taken 1965. Field checked 1967. Revised from aerial photographs  
taken 1990. Field checked 1992. Map edited 1994  
Universal Transverse Mercator projection  
10,000-foot grid ticks: Iowa coordinate system, north zone  
1000-meter Universal Transverse Mercator grid ticks, zone 15, shown in blue  
1927 North American Datum (NAD 27)  
North American Datum of 1983 (NAD 83) is shown by dashed corner ticks  
The values of the shift between NAD 27 and NAD 83 for 7.5-minute  
intersections are given in USGS Bulletin 1875  
Gray tint indicates areas in which only landmark buildings are shown  
Fine red dashed lines indicate selected fence and field lines where  
generally visible on aerial photographs. This information is unchecked

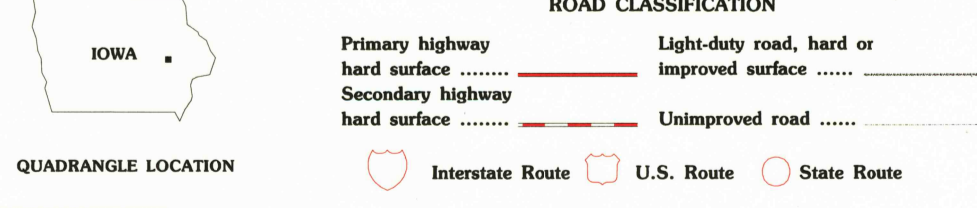
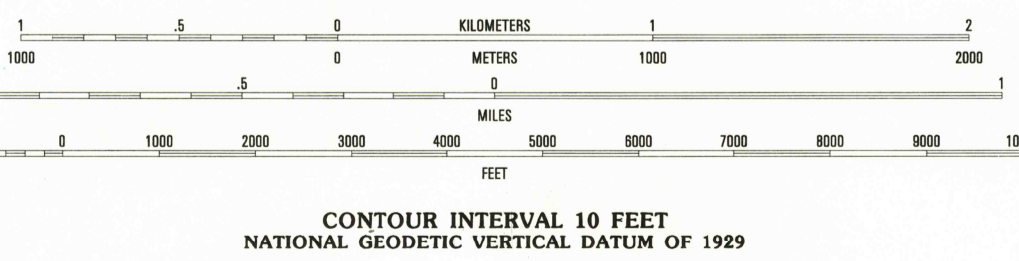
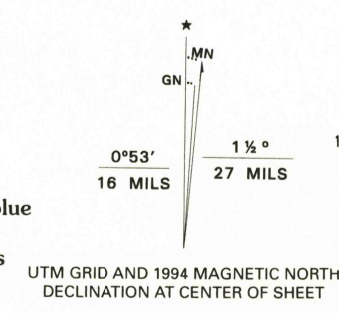

QUADRANGLE LOCATION

1	2	3	1	Shellsburg
4	5	6	2	Cedar Rapids North
7	8	9	3	Fairfax
			4	Marion
			5	Bertram
			6	Amama
			7	Swisher
			8	Elly

CEDAR RAPIDS SOUTH, IOWA  
41091-H6-TF-024

1994

DMA 7667 1 NW - SERIES V876

THIS MAP COMPLIES WITH NATIONAL MAP ACCURACY STANDARDS  
FOR SALE BY U.S. GEOLOGICAL SURVEY, DENVER, COLORADO 80225 OR RESTON, VIRGINIA 22092  
AND IOWA GEOLOGICAL SURVEY, IOWA CITY, IOWA 52240  
A FOLDER DESCRIBING TOPOGRAPHIC MAPS AND SYMBOLS IS AVAILABLE ON REQUEST

RECEIVED  
FEB 28 2002

HISTORICAL MAP ARCHIVES

ISBN 0-607-15605-9  
9 780607 156059