

Produced by the United States Geological Survey 1968 Revision by USDA Forest Service 2001 Topography compiled 1967. Planimetry derived from imagery taken 1998 and other sources. Public Land Survey System and survey control current as of 2003. Boundaries current as of 2003.

This map is not a legal document. Public lands are subject to change and leasing, and may have access restrictions; check with appropriate offices. Obtain permission before entering private lands.

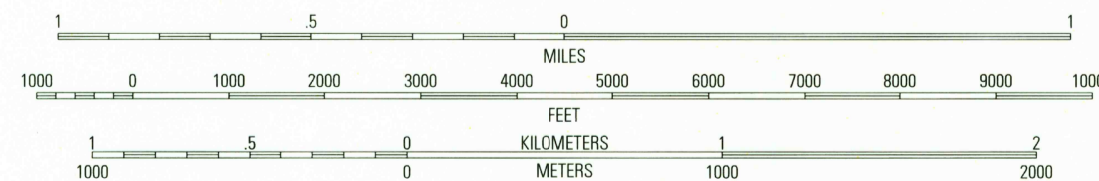
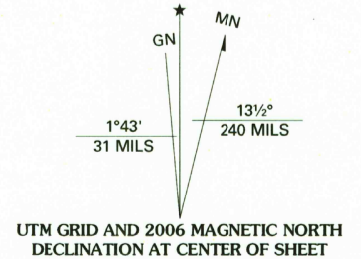

SCALE 1:24 000 CONTOUR INTERVAL 40 FEET NATIONAL GEODETIC VERTICAL DATUM OF 1929 TO CONVERT FROM FEET TO METERS, MULTIPLY BY 0.3048

THIS MAP COMPLIES WITH NATIONAL MAP ACCURACY STANDARDS FOR SALE BY U.S. GEOLOGICAL SURVEY, P.O. BOX 25286, DENVER, COLORADO 80225 A FOLDER DESCRIBING TOPOGRAPHIC MAPS AND SYMBOLS IS AVAILABLE ON REQUEST

Table with 3 columns and 8 rows showing adjoining 7.5' quadrangles: 1 Mount Harrison, 2 Connor Ridge, 3 Nibbs Creek, 4 Cache Peak, 5 Kane Canyon, 6 Almo, 7 Jim Sage Canyon, 8 Chokecherry Canyon.

Legend for highways and roads, including Interstate, U.S., State, County, National Forest, and National Forest Trail symbols. Includes a USGS Library - Reston logo and ISBN information.

USGS Library Reston, VA. Topo Archive



NOV 19 2006

ELBA, ID 2001 42113-B5-TF-024 NGA 3268 II NE - SERIES V893