

UNITED STATES  
DEPARTMENT OF THE INTERIOR  
GEOLOGICAL SURVEY

LEWISTON ORCHARDS SOUTH QUADRANGLE  
IDAHO-WASHINGTON  
7.5 MINUTE SERIES (TOPOGRAPHIC)  
SW/4 LEWISTON ORCHARDS 15' QUADRANGLE

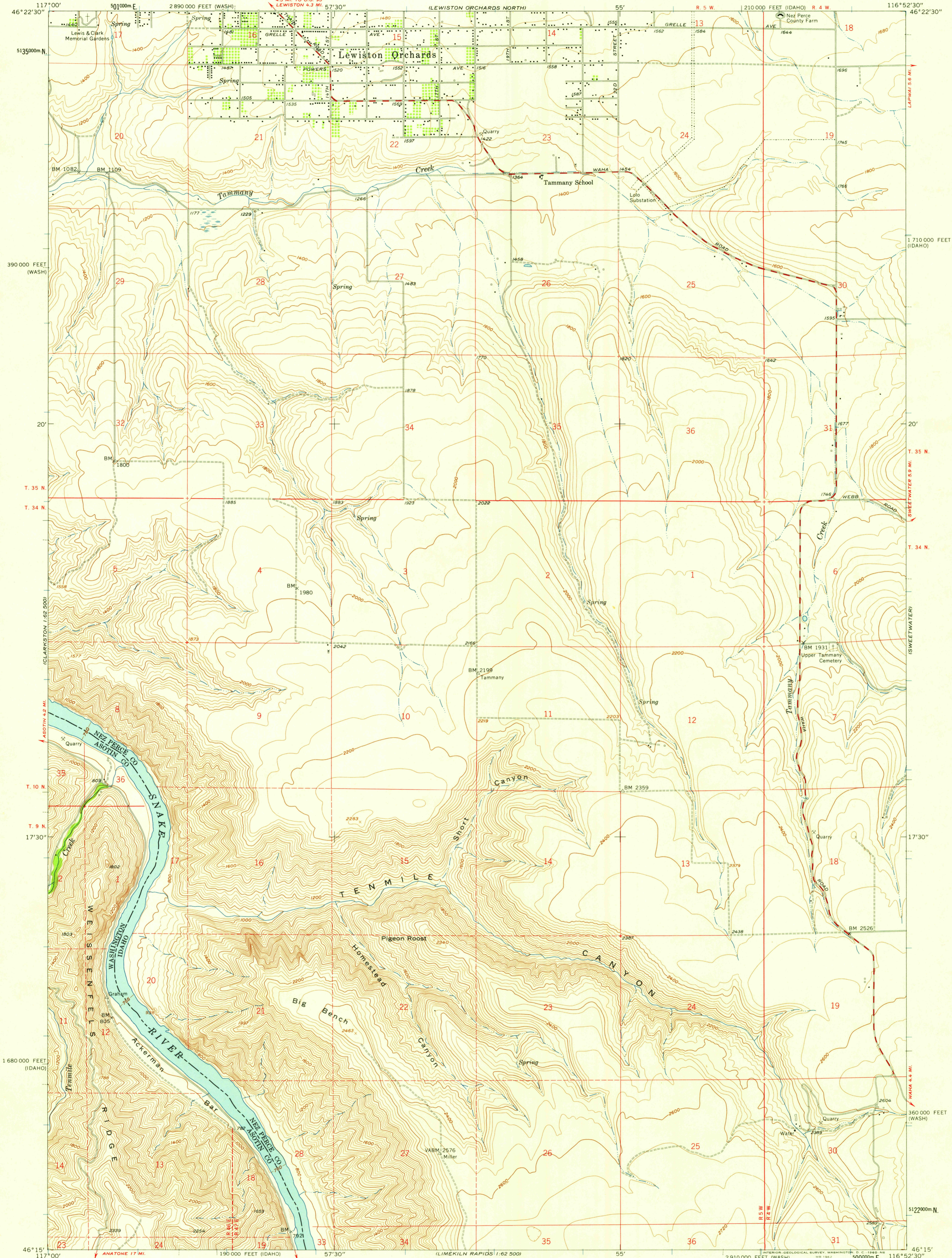

Mapped, edited, and published by the Geological Survey  
Control by USGS and USC&GS  
Topography from aerial photographs by photogrammetric methods  
Aerial photographs taken 1955. Field check 1958  
Polyconic projection. 1927 North American datum  
10,000-foot grids based on Idaho coordinate system, west zone  
and on Washington coordinate system, south zone  
1000-meter Universal Transverse Mercator grid ticks  
zone 11, shown in blue  
Unchecked elevations are shown in brown  
Dashed land lines indicate approximate locations

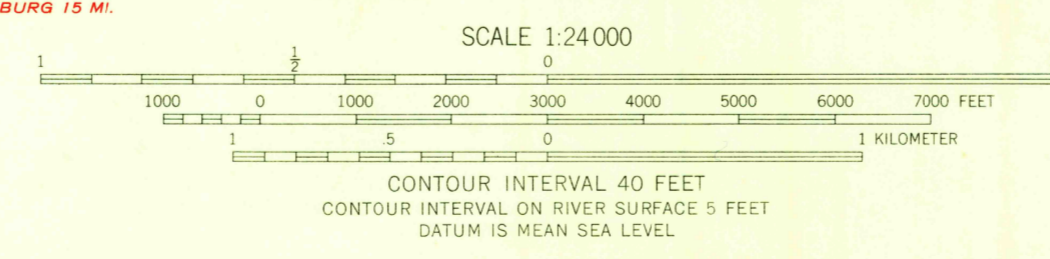
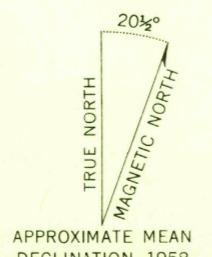

USGS  
Historical File  
Topographic Division

ROAD CLASSIFICATION  
Medium-duty — Light-duty  
Unimproved dirt —

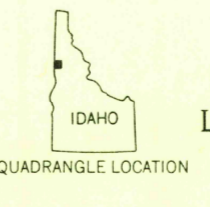

LEWISTON ORCHARDS SOUTH, IDAHO-WASH.  
SW/4 LEWISTON ORCHARDS 15' QUADRANGLE  
N4615—W11652.5/7.5

THIS MAP COMPLIES WITH NATIONAL MAP ACCURACY STANDARDS  
FOR SALE BY U. S. GEOLOGICAL SURVEY, DENVER 25, COLORADO OR WASHINGTON 25, D. C.  
A FOLDER DESCRIBING TOPOGRAPHIC MAPS AND SYMBOLS IS AVAILABLE ON REQUEST

1958

U.S.G.S.  
FILE COPY  
TOPOGRAPHIC DIVISION

MAR 24 1960

2040