

3170 II NE
(TIRKURA)

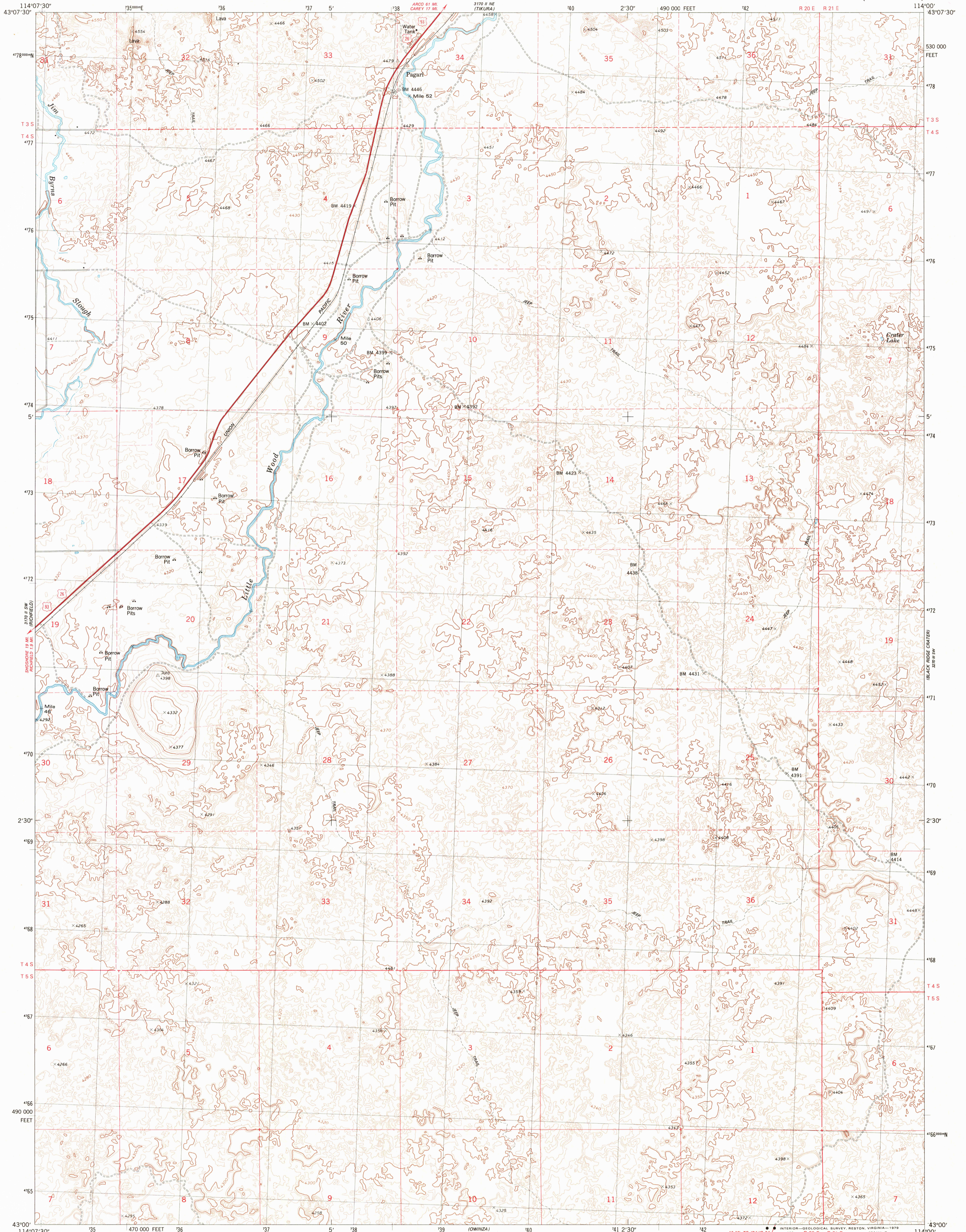

Mapped, edited, and published by the Geological Survey

Control by USGS and NOS/NOAA

Topography by photogrammetric methods from aerial photographs taken 1971. Field checked 1973

Map edited 1979

Projection and 10,000-foot grid ticks: Idaho coordinate system, central zone (transverse Mercator)

1000-meter Universal Transverse Mercator grid, zone 11

1927 North American datum

To place on the predicted North American Datum 1983 move the projection lines 13 meters north and 71 meters east as shown by dashed corner ticks

Fine red dashed lines indicate selected fence and field lines where generally visible on aerial photographs

This information is unchecked

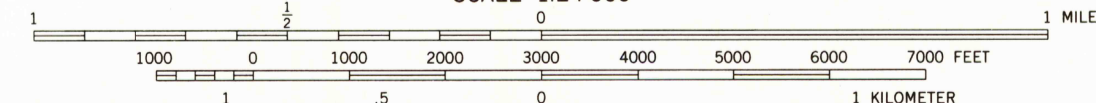
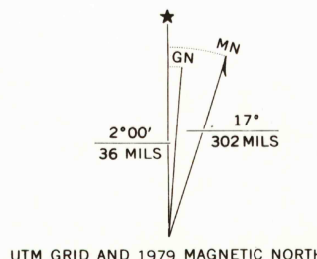

CONTOUR INTERVAL 10 FEET
NATIONAL GEODETIC VERTICAL DATUM OF 1929

THIS MAP COMPLIES WITH NATIONAL MAP ACCURACY STANDARDS
FOR SALE BY U. S. GEOLOGICAL SURVEY, DENVER, COLORADO 80225 OR RESTON, VIRGINIA 22092
A FOLDER DESCRIBING TOPOGRAPHIC MAPS AND SYMBOLS IS AVAILABLE ON REQUEST



ROAD CLASSIFICATION	
Primary highway, hard surface	Light-duty road, hard or improved surface
Secondary highway, hard surface	Unimproved road
Interstate Route	U. S. Route
	State Route

USGS
Historical File
Topographic Division

PAGARI, IDAHO
N4300-W11400/7.5
1979

AMS 3170 II SE-SERIES V893

SEP 19 1979

1100