

U. S. G. S.
FILE COPY
Imposition and Editing.

UNITED STATES
DEPARTMENT OF THE INTERIOR
GEOLOGICAL SURVEY

IDAHO
CRANES FLAT QUADRANGLE
R. 42 E.

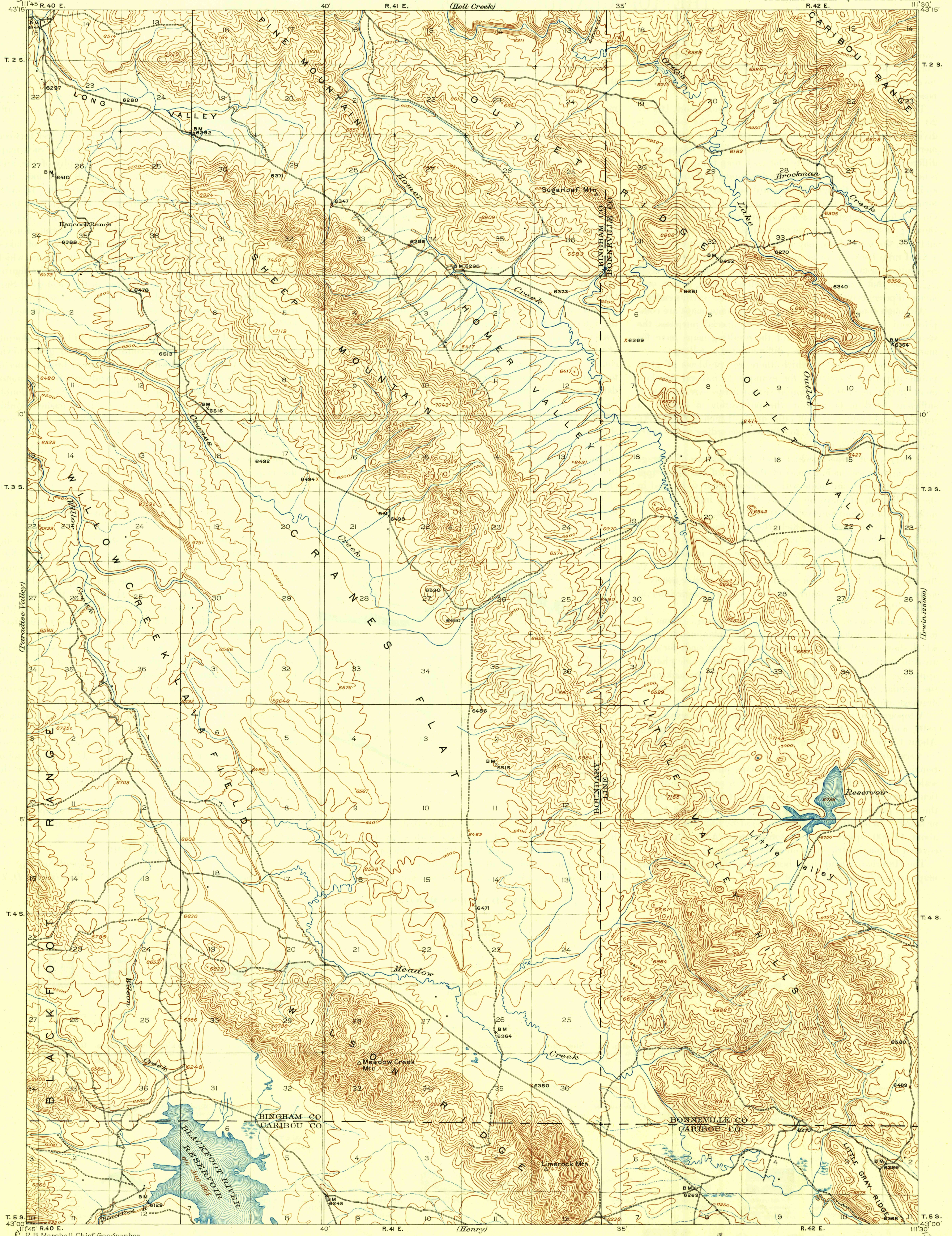

R. B. Marshall, Chief Geographer.
T. G. Gardiner, Geographer in charge.
Topography by C. G. Anderson and J. L. Lewis.
Control by H. H. Hodgesson and F. L. Whaley.
Surveyed in 1913 and 1915.

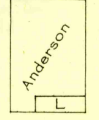

Contour interval 50 feet
Datum is mean sea level

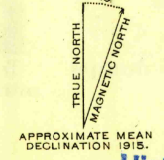

USGS
Historical File
Topographic Division

IDAHO
CRANES FLAT
N4-300-W11130/5

U. S. G. S.
FILE COPY
Imposition and Editing.