

UNITED STATES  
DEPARTMENT OF THE INTERIOR  
GEOLOGICAL SURVEY

STATE OF ILLINOIS  
DEPARTMENT OF ENERGY AND NATURAL RESOURCES  
GEOLOGICAL SURVEY DIVISION  
CHAMPAIGN, ILLINOIS

CHATSORTH SOUTH QUADRANGLE  
ILLINOIS-LIVINGSTON CO.  
7.5 MINUTE SERIES (TOPOGRAPHIC)

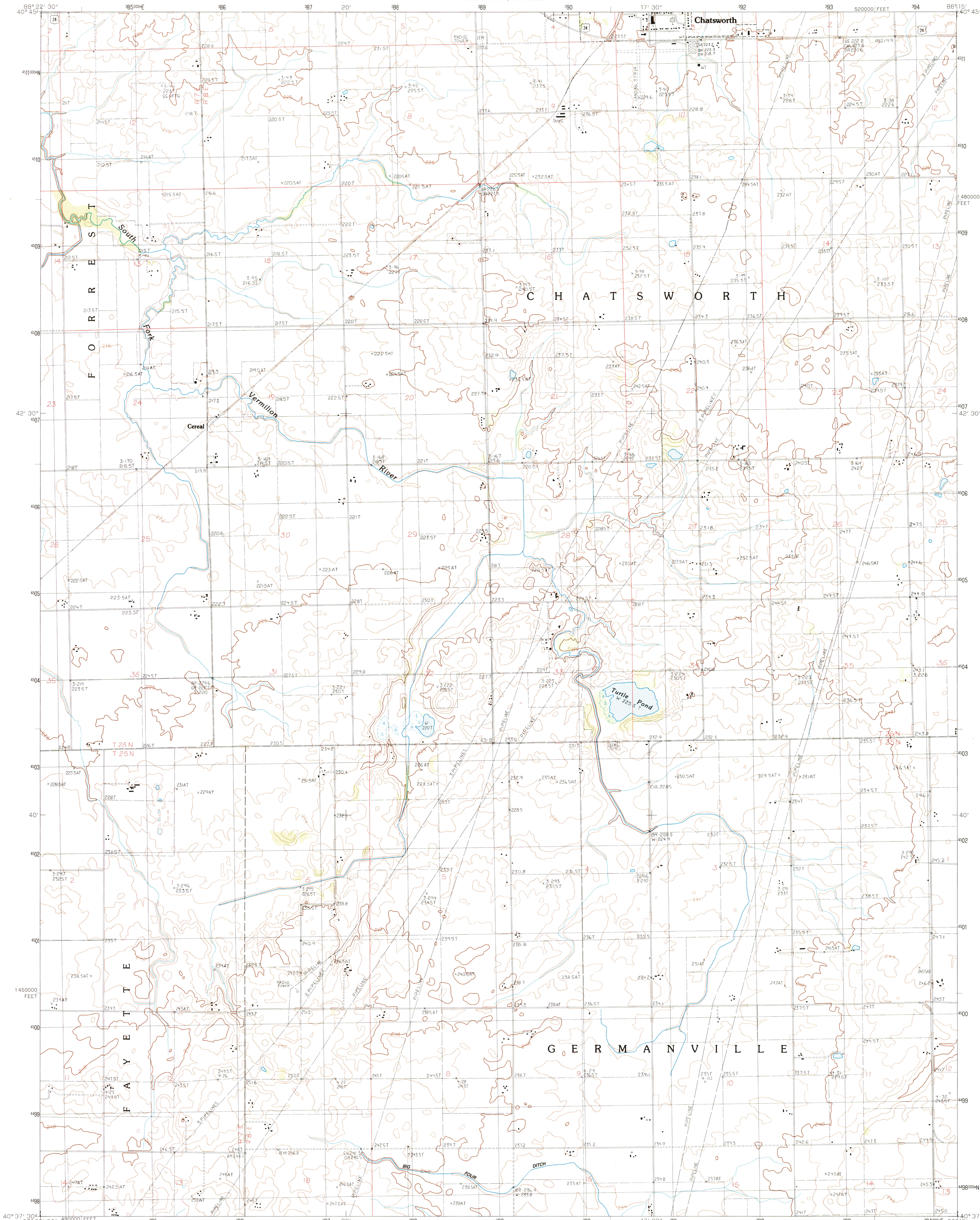

PRODUCED BY THE UNITED STATES GEOLOGICAL SURVEY  
CONTROL BY USGS AND NOS/NOAA  
COMPILED FROM AERIAL PHOTOGRAPHS TAKEN 1983  
FIELD CHECKED 1985. MAP EDITED 1986  
PROJECTION UNIVERSAL TRANSVERSE MERCATOR  
GRID: 1000-METER UNIVERSAL TRANSVERSE MERCATOR ZONE 16  
10,000-FOOT STATE GRID TICKS  
UTM GRID DECLINATION 051° WEST  
1986 MAGNETIC NORTH DECLINATION 090° EAST  
VERTICAL DATUM NATIONAL GEODETIC VERTICAL DATUM OF 1929  
HORIZONTAL DATUM 1927 NORTH AMERICAN DATUM  
To place on the predicted North American Datum 1983,  
move the projection lines as shown by dashed corner ticks  
(5 meters east)  
There may be private inholdings within the boundaries of any  
Federal and State reservations shown on this map  
No distinction made between houses, barns, and other buildings

PROVISIONAL MAP  
Produced from original  
manuscript drawings. Infor-  
mation shown as of date of  
photography.

SCALE 1:24 000  
KILOMETERS  
METERS  
MILES  
FEET  
CONTOUR INTERVAL 3 METERS  
CONTROL AND FIELD ESTABLISHED ELEVATIONS SHOWN TO THE NEAREST 0.1 METER  
OTHER ELEVATIONS SHOWN TO THE NEAREST 0.5 METER  
To convert meters to feet multiply by 3.2808  
To convert feet to meters multiply by .3048  
THIS MAP COMPLIES WITH NATIONAL MAP ACCURACY STANDARDS  
FOR SALE BY U. S. GEOLOGICAL SURVEY, DENVER, COLORADO 80225, OR RESTON, VIRGINIA 22092  
AND ILLINOIS GEOLOGICAL SURVEY, CHAMPAIGN, ILLINOIS 61820  
A FOLDER DESCRIBING TOPOGRAPHIC MAPS AND SYMBOLS IS AVAILABLE ON REQUEST

1	2	3	1 Forrest North
4	5	2 Chatsworth North	3 Piper City
6	7	4 Forrest South	5 Buckley NW
		6 Sibley	7 Melvin West
		8 Melvin East	

ROAD LEGEND  
Improved Road  
Unimproved Road  
Trail  
Interstate Route  
U. S. Route  
State Route

CHATSORTH SOUTH, ILLINOIS  
PROVISIONAL EDITION 1986

40088-F3-TM-024

