

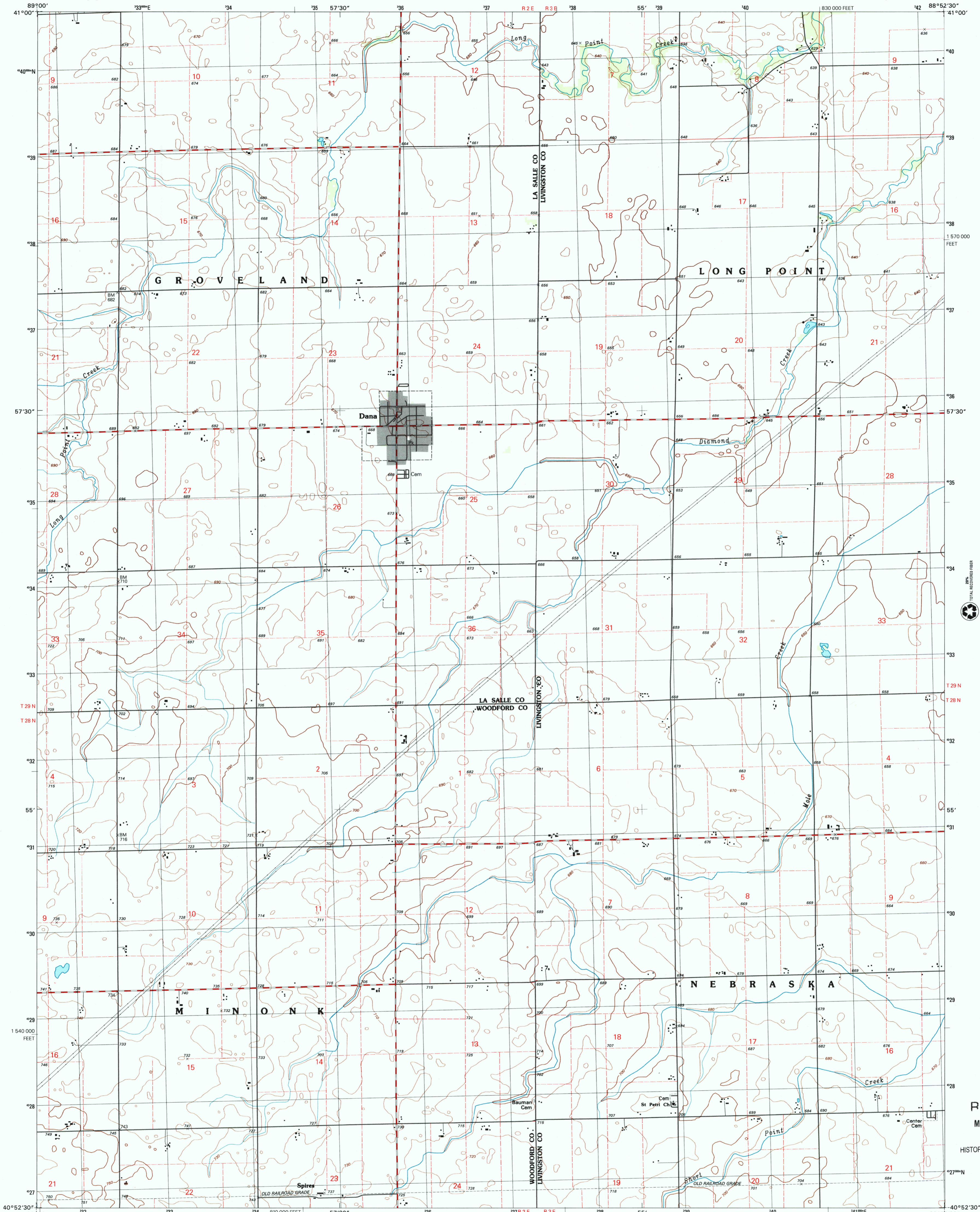

U.S. DEPARTMENT OF THE INTERIOR  
U.S. GEOLOGICAL SURVEY

DANA QUADRANGLE  
ILLINOIS  
7.5-MINUTE SERIES (TOPOGRAPHIC)



RECEIVED  
MAY 27 2003  
HISTORICAL MAP ARCHIVE

Produced by the United States Geological Survey

Contours.....National Elevation Dataset, 1975  
Roads.....Illinois Department of Transportation, 2001  
Other Planimetry.....1999  
Public Land Survey System and Survey Control.....1979  
Boundaries.....2002  
Woodland.....LANDSAT 7, 2001  
Houses of Worship, Schools, and Other Labeled Buildings.....1979  
North American Datum of 1983 (NAD 83). Projection and  
1 000-meter grid: Universal Transverse Mercator, zone 16T  
10 000-foot ticks: Illinois Coordinate System of 1983  
(east and west zones)  
North American Datum of 1927 (NAD 27) is shown by dashed  
corner ticks. The values of the shift between NAD 83 and  
NAD 27 for 7.5-minute intersections are obtainable from  
National Geodetic Survey NADCON software

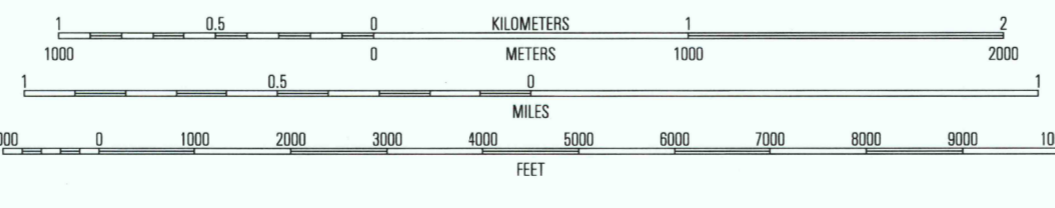
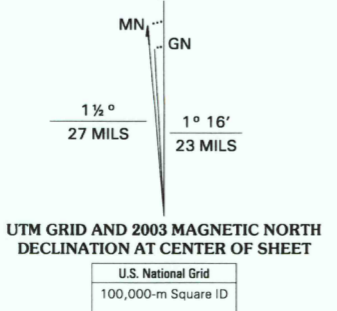

SCALE 1:24 000

CONTOUR INTERVAL 10 FEET  
NORTH AMERICAN VERTICAL DATUM OF 1988  
TO CONVERT FROM FEET TO METERS, MULTIPLY BY 0.3048

THIS MAP COMPLIES WITH NATIONAL MAP ACCURACY STANDARDS  
FOR SALE BY U.S. GEOLOGICAL SURVEY, P.O. BOX 25286, DENVER, COLORADO 80225  
AND ILLINOIS GEOLOGICAL SURVEY, CHAMPAIGN, ILLINOIS 61820  
A FOLDER DESCRIBING TOPOGRAPHIC MAPS AND SYMBOLS IS AVAILABLE ON REQUEST



QUADRANGLE LOCATION

1	2	3
4	5	6
7	8	

ROAD CLASSIFICATION  
Primary highway hard surface ..... Light-duty road, hard or improved surface .....  
Secondary highway hard surface ..... Unimproved road .....  
Interstate Route ..... U.S. Route ..... State Route .....

APR 01 2003

DANA, IL  
1999

NIMA 3265 IV NW-SERIES V863

