

UNITED STATES
DEPARTMENT OF THE INTERIOR
GEOLOGICAL SURVEY

LAKE CALUMET QUADRANGLE
ILLINOIS-INDIANA
7.5 MINUTE SERIES (TOPOGRAPHIC)

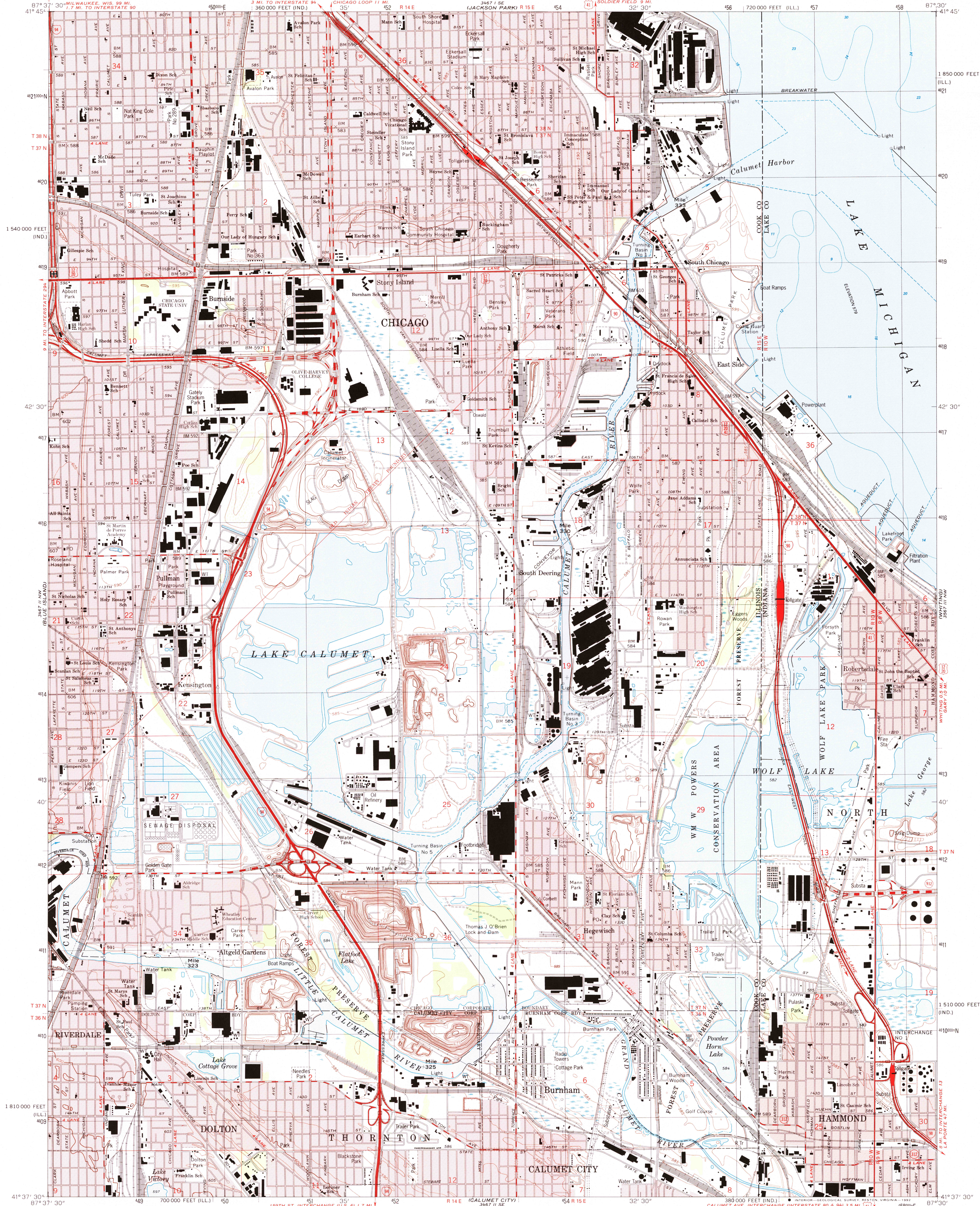

Produced by the United States Geological Survey
Control by USGS, NOS/NOAA and City of Chicago
Topography by photogrammetric methods from aerial photographs
taken 1964 and photostatic surveys 1927. Revised from aerial
photographs taken 1988. Field checked 1991. Map edited 1991
Selected hydrographic data compiled from NOS chart 14905 (1986)
This information is not intended for navigational purposes
Projection: Illinois coordinate system, east zone
(transverse Mercator)
10,000-foot grid ticks: Illinois coordinate system, east zone
and Indiana coordinate system, west zone
1000-meter Universal Transverse Mercator grid, zone 16
1927 North American Datum
The difference between 1927 North American Datum and North
American Datum of 1983 (NAD 83) for 7.5 minute intersections
is given in USGS Bulletin 1875. The NAD 83 is shown by
dashed corner ticks
There may be private inholdings within the boundaries of the
National or State reservations shown on this map
Red tint indicates areas in which only landmark buildings are shown

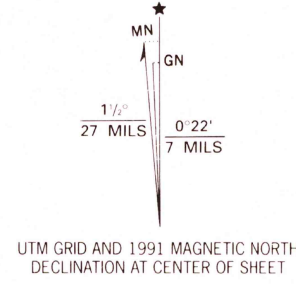

SCALE 1:24,000
CONTOUR INTERVAL 5 FEET
NATIONAL GEODETIC VERTICAL DATUM OF 1929
DEPTH CURVES AND SOUNDINGS IN FEET
REFERENCE LEVEL 576.8 FEET, INTERNATIONAL GREAT LAKES DATUM
THE RELATIONSHIP BETWEEN THE TWO DATUMS IS VARIABLE
COMPLIES WITH U.S. GEOLOGICAL SURVEY STANDARDS FOR SPATIAL ACCURACY CLASS 2
FOR SALE BY U.S. GEOLOGICAL SURVEY, DENVER, COLORADO 80225, OR RESTON, VIRGINIA 22092
ILLINOIS GEOLOGICAL SURVEY, CHAMPAIGN, ILLINOIS 61820
AND INDIANA DEPARTMENT OF NATURAL RESOURCES, INDIANAPOLIS, INDIANA 46204
A FOLDER DESCRIBING TOPOGRAPHIC MAPS AND SYMBOLS IS AVAILABLE ON REQUEST

ROAD CLASSIFICATION

Primary highway, hard surface	Light-duty road, hard or improved surface
Secondary highway, hard surface	Unimproved road
Interstate Route	U.S. Route
	State Route

USGS 1:24,000 HISTORICAL MAP ARCHIVES
DEC 16 1992
REC'D FILE COPY

LAKE CALUMET, ILL.-IND.
41087-F5-TF-024
1991
DMA 3467 II NE-SERIES V863