

UNITED STATES
DEPARTMENT OF THE INTERIOR
GEOLOGICAL SURVEY
R. 2 E.

WAR DEPARTMENT
CORPS OF ENGINEERS, U. S. ARMY
R. 3 E. (Belvidere)

STATE OF ILLINOIS
Dwight H. Green, Governor
DEPARTMENT OF REGISTRATION AND EDUCATION
John J. Hallihan, Director
GEOLOGICAL SURVEY DIVISION, M. M. Leighton, Chief, Urbana, Illinois

ILLINOIS
KIRKLAND QUADRANGLE
R. 4 E.

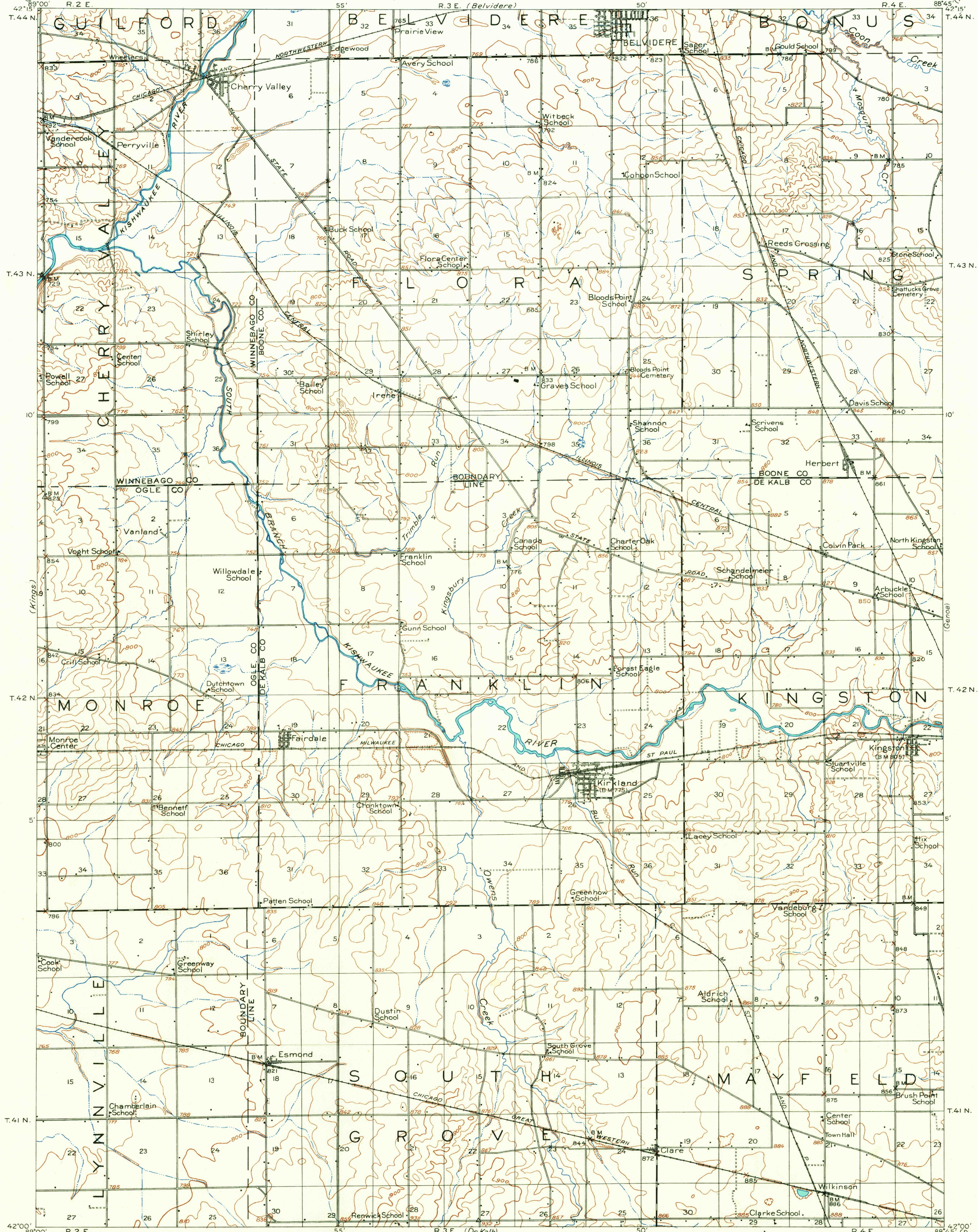

R. B. Marshall, Chief Geographer.
W. H. Herron, Geographer in charge.
Topography by R. H. Reineck, J. A. Duck, C. C. Gardner,
J. B. Leavitt, and A. L. Odyckie.
Control by Corps of Engineers U. S. Army, E. L. McNair, F. W. Crisp,
F. A. Danforth, S. L. Parker, J. B. Metcalfe, Jr., C. C. Gardner, and
H. S. Senseney.
Surveyed in 1917.
Culture revised in part, 1940
SURVEYED IN COOPERATION WITH THE WAR DEPARTMENT
AND THE STATE OF ILLINOIS.

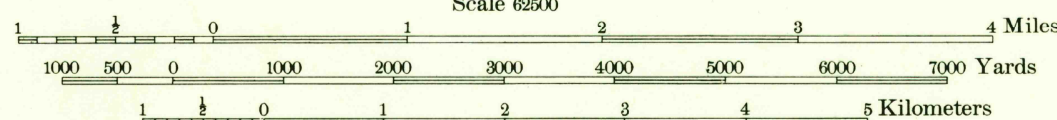
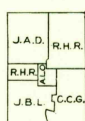

Contour interval 20 feet.
Datum is mean sea level

RETURN TO:
NHD HISTORICAL MAP ARCHIVES
USGS NATIONAL CENTER, MS-522
RESTON, VA 22092

Edition of 1918, reprinted 1941
Polyconic projection. North American datum

ILL.
KIRKLAND
N4200-W8845/15