

# TOPOGRAPHY

STATE OF ILLINOIS

GOVERNOR EDWARD F. DUNNE, T. C. CHAMBERLIN, E. J. JAMES, COMMISSIONERS

FRANK W. DE WOLF, DIRECTOR, STATE GEOLOGICAL SURVEY

ILLINOIS

MOUNT OLIVE QUADRANGLE

U.S. GEOLOGICAL SURVEY  
GEORGE OTIS SMITH, DIRECTOR

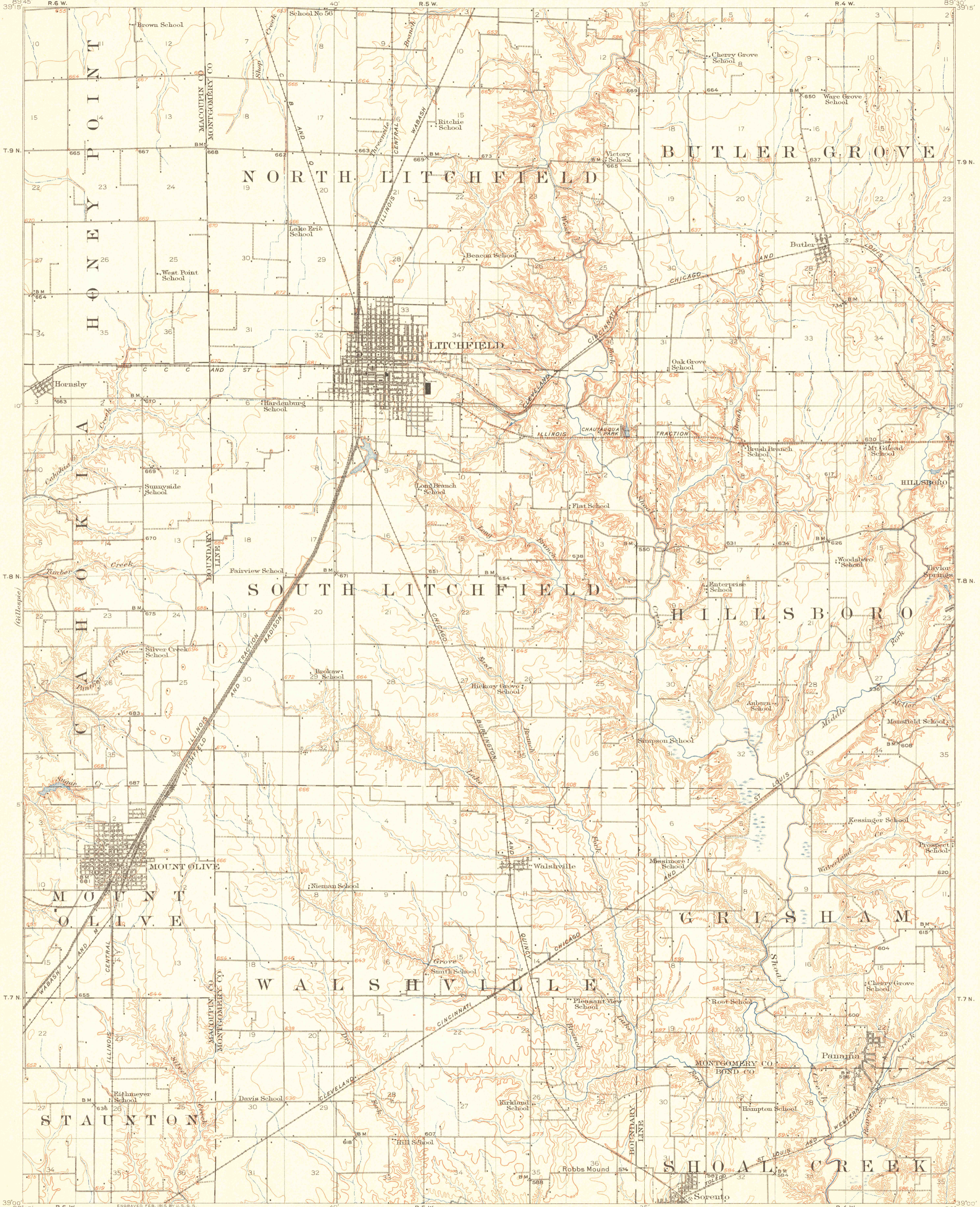

89°45' R. 6 W. ENGRAVED FEB. 1915 BY U.S.G.S.

Scale 62500

Edition of June 1915.

R. B. Marshall, Chief Geographer.  
W. H. Herron, Geographer in charge.  
Topography by W. L. Miller and L. L. Lee.  
Control by J. H. Wilson, R. G. Clinite, and S. R. Archer.  
Surveyed in 1913.

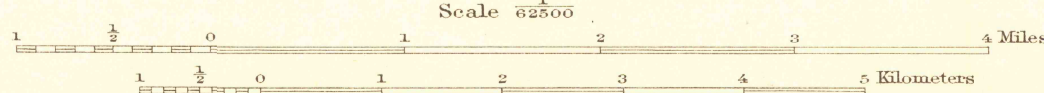
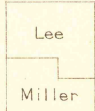

Contour interval 20 feet.  
Datum is mean sea level.

APPROXIMATE MEAN  
MAGNETIC NORTH  
DECLINATION 1911

MOUNT OLIVE

SURVEYED IN COOPERATION WITH THE STATE OF ILLINOIS.