

U. S. G. S.
FILE COPY
Ed. Div. Topographic Maps.

TOPOGRAPHIC SHEET

KANSAS
SYRACUSE QUADRANGLE

U. S. GEOLOGICAL SURVEY
CHARLES D. WALCOTT, DIRECTOR.
102°00' R.43 W. 38°00' T.24 S. R.42 W. 50' R.40 W. 40' R.39 W. 101°30' R.38 W. 38°00'

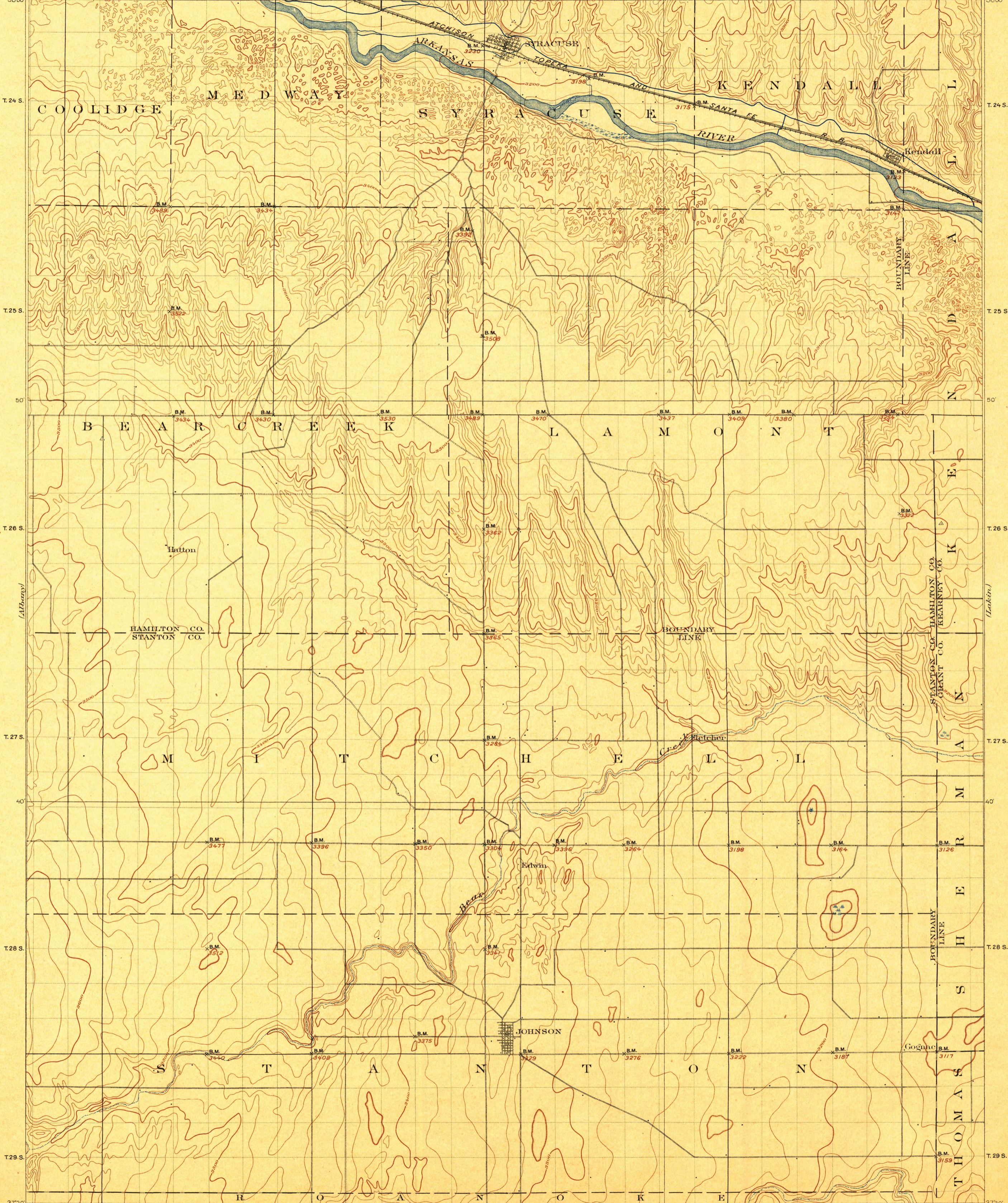

ENGRAVED FEB. 1900 BY U.S.G.S. R.42 W. 37°30' 102°00' R.43 W. Jno. H. Ranshaw, Geographer in charge. Triangulation by A.H. Thompson. Topography by Nat. Tyler, Jr. Surveyed in 1898.

Scale 1:25,000
1 1/2 0 1 2 3 4 Miles
1 1/2 0 1 2 3 4 Kilometers
Contour interval 20 feet.
Datum is mean sea level.

U. S. G. S.
FILE COPY

USGS
Historical File
Topographic Division
Syracuse, Kansas
OCT 31 1900 (2616)
Ed. Div. Topographic Maps.