

5893 I SE (REAGER)

UNITED STATES  
DEPARTMENT OF THE INTERIOR  
GEOLOGICAL SURVEY



CLAYTON NE QUADRANGLE  
KANSAS—NORTON CO.  
7.5 MINUTE SERIES (TOPOGRAPHIC)

5893 I SE (REAGER)

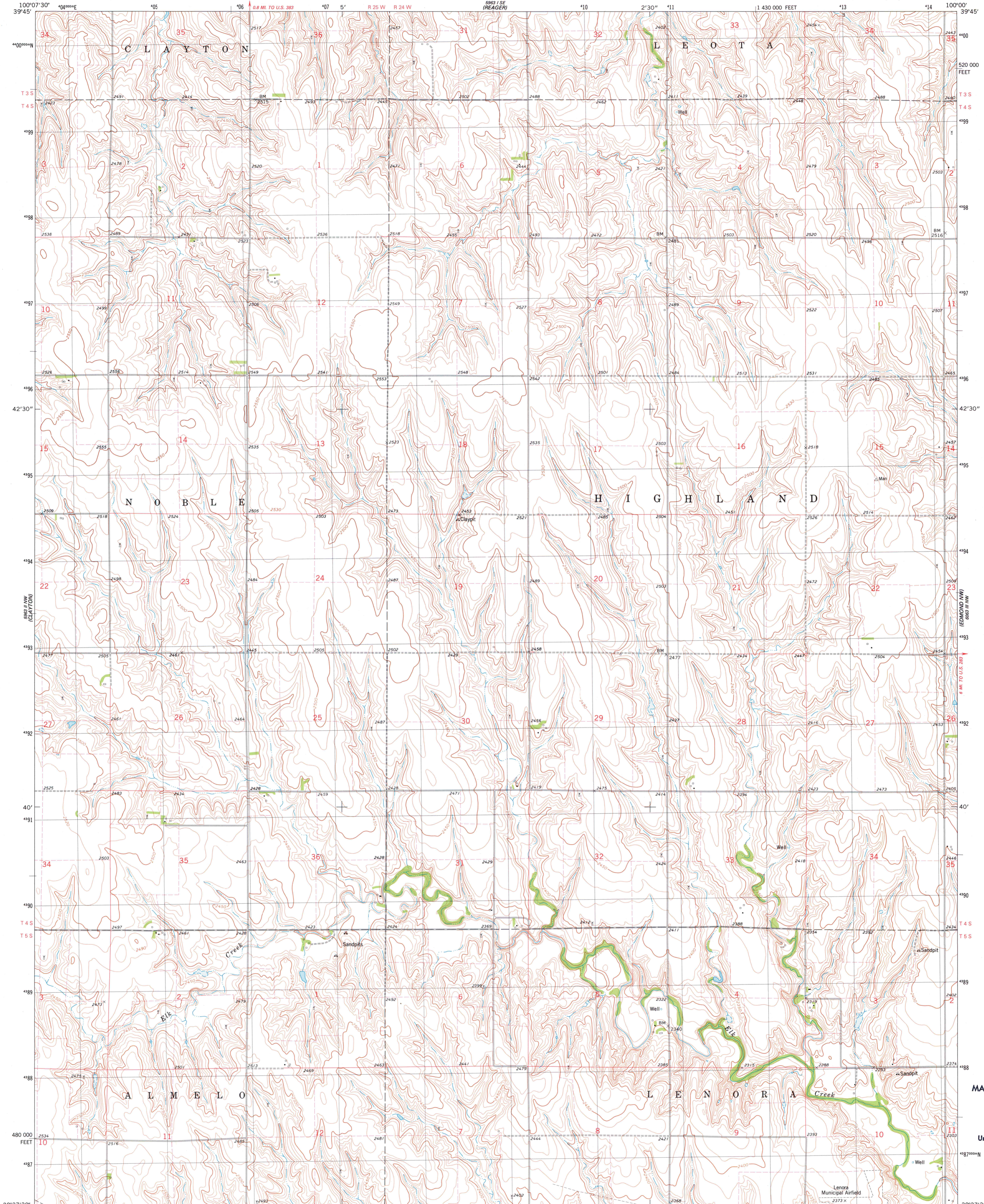

CLAYTON SW  
5893 I SW

Mapped, edited, and published by the Geological Survey  
Control by USGS and NOS/NOAA  
Topography by photogrammetric methods from aerial photographs taken 1974. Field checked 1975. Map edited 1978  
Projection and 10,000-foot grid ticks: Kansas coordinate system, north zone (Lambert conformal conic)  
1000-meter Universal Transverse Mercator grid, zone 14 1927 North American datum  
Fine red dashed lines indicate selected fence and field lines where generally visible on aerial photographs. This information is unchecked

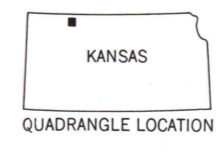
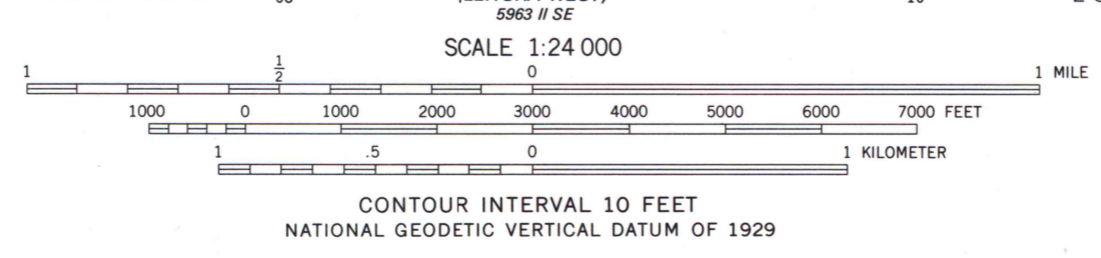
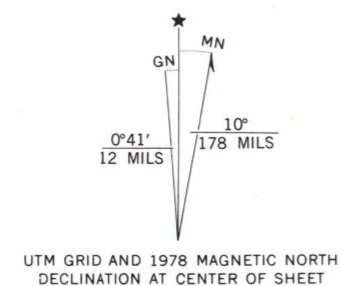

ROAD CLASSIFICATION

Primary highway, hard surface	Light-duty road, hard or improved surface
Secondary highway, hard surface	Unimproved road
Interstate Route	U. S. Route
	State Route

MAP AND AIR PHOTO LIBRARY  
OCT 30 1978  
University of Wisconsin  
Madison

THIS MAP COMPLIES WITH NATIONAL MAP ACCURACY STANDARDS  
FOR SALE BY U. S. GEOLOGICAL SURVEY, DENVER, COLORADO 80225, OR RESTON, VIRGINIA 22092  
AND STATE GEOLOGICAL SURVEY, LAWRENCE, KANSAS 66044  
A FOLDER DESCRIBING TOPOGRAPHIC MAPS AND SYMBOLS IS AVAILABLE ON REQUEST

CLAYTON NE, KANS.  
N3937 5--W10000/7.5  
1978  
AMS 5893 II NE--SERIES V878