

5963 III SW (DRESDEN SW)

UNITED STATES DEPARTMENT OF THE INTERIOR GEOLOGICAL SURVEY

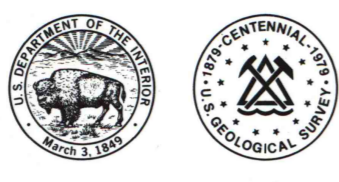

DRESDEN SOUTH QUADRANGLE KANSAS 7.5 MINUTE SERIES (TOPOGRAPHIC)

5963 III SW (DRESDEN SW)

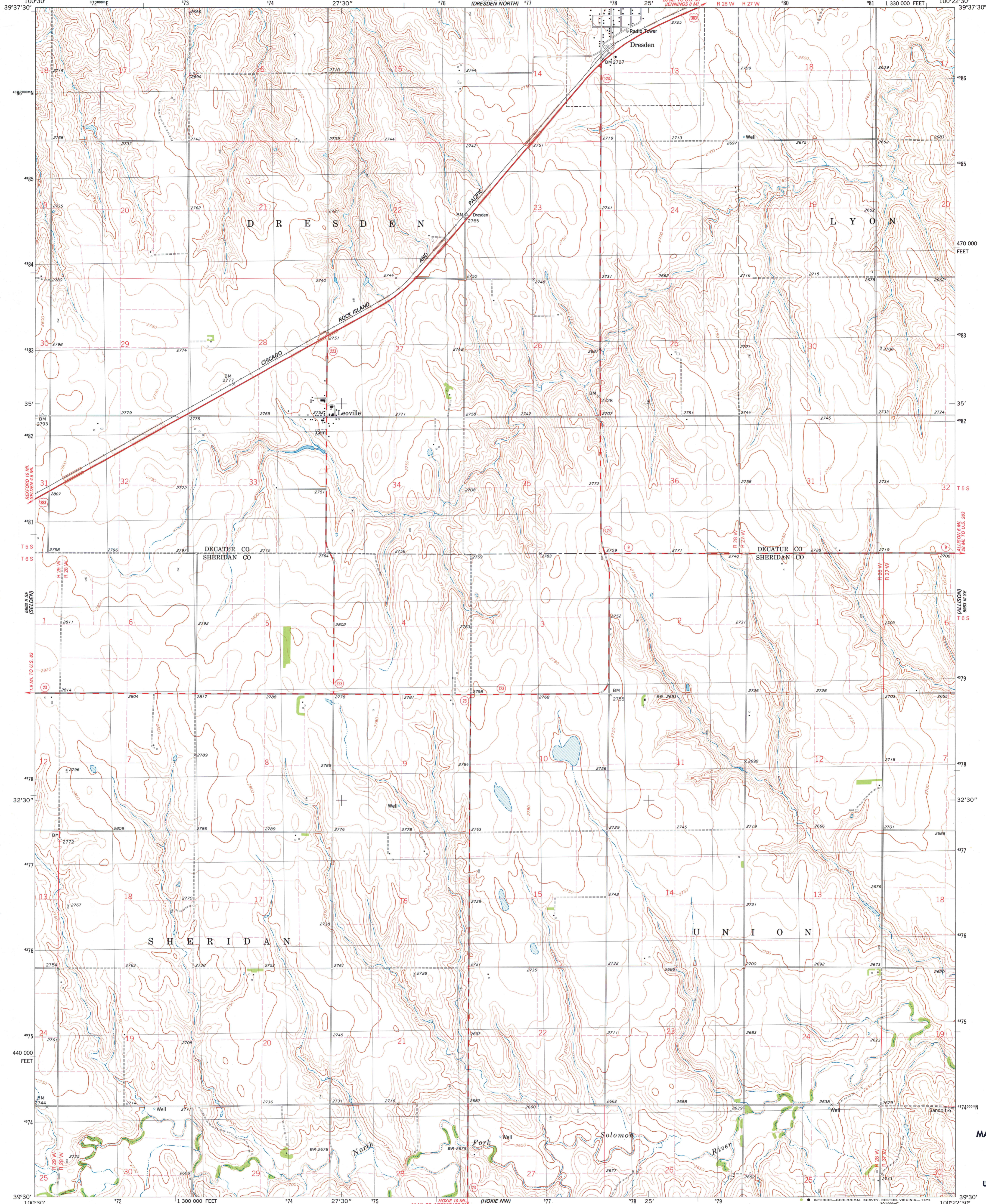

Mapped, edited, and published by the Geological Survey Control by USGS and NOS/NOAA Topography by photogrammetric methods from aerial photographs taken 1974. Field checked 1975. Map edited 1978 Projection and 10,000-foot grid ticks: Kansas coordinate system, north zone (Lambert conformal conic) 1000-meter Universal Transverse Mercator grid, zone 14 1927 North American datum Fine red dashed lines indicate selected fence and field lines where generally visible on aerial photographs. This information is unchecked

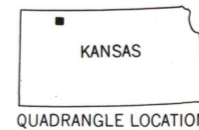
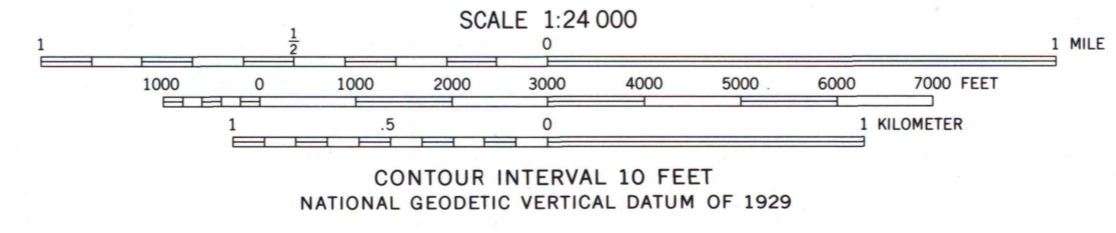
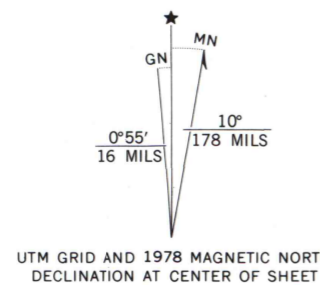

ROAD CLASSIFICATION Primary highway, hard surface Secondary highway, hard surface Interstate Route U. S. Route State Route Light-duty road, hard or improved surface Unimproved road

THIS MAP COMPLIES WITH NATIONAL MAP ACCURACY STANDARDS FOR SALE BY U. S. GEOLOGICAL SURVEY, DENVER, COLORADO 80225, OR RESTON, VIRGINIA 22092 AND STATE GEOLOGICAL SURVEY, LAWRENCE, KANSAS 66044 A FOLDER DESCRIBING TOPOGRAPHIC MAPS AND SYMBOLS IS AVAILABLE ON REQUEST

DRESDEN SOUTH, KANSAS. N3930-W10022.5/7.5 1978

AMS 5963 III SW-SERIES V878

MAP AND AIR LIBRARY OCT 30 1978 University of Wisconsin-Madison