

582 IV SE (CORRECTION SE)

UNITED STATES DEPARTMENT OF THE INTERIOR GEOLOGICAL SURVEY



GEM QUADRANGLE KANSAS-THOMAS CO. 7.5 MINUTE SERIES (TOPOGRAPHIC)

582 IV SE (CORRECTION SE)

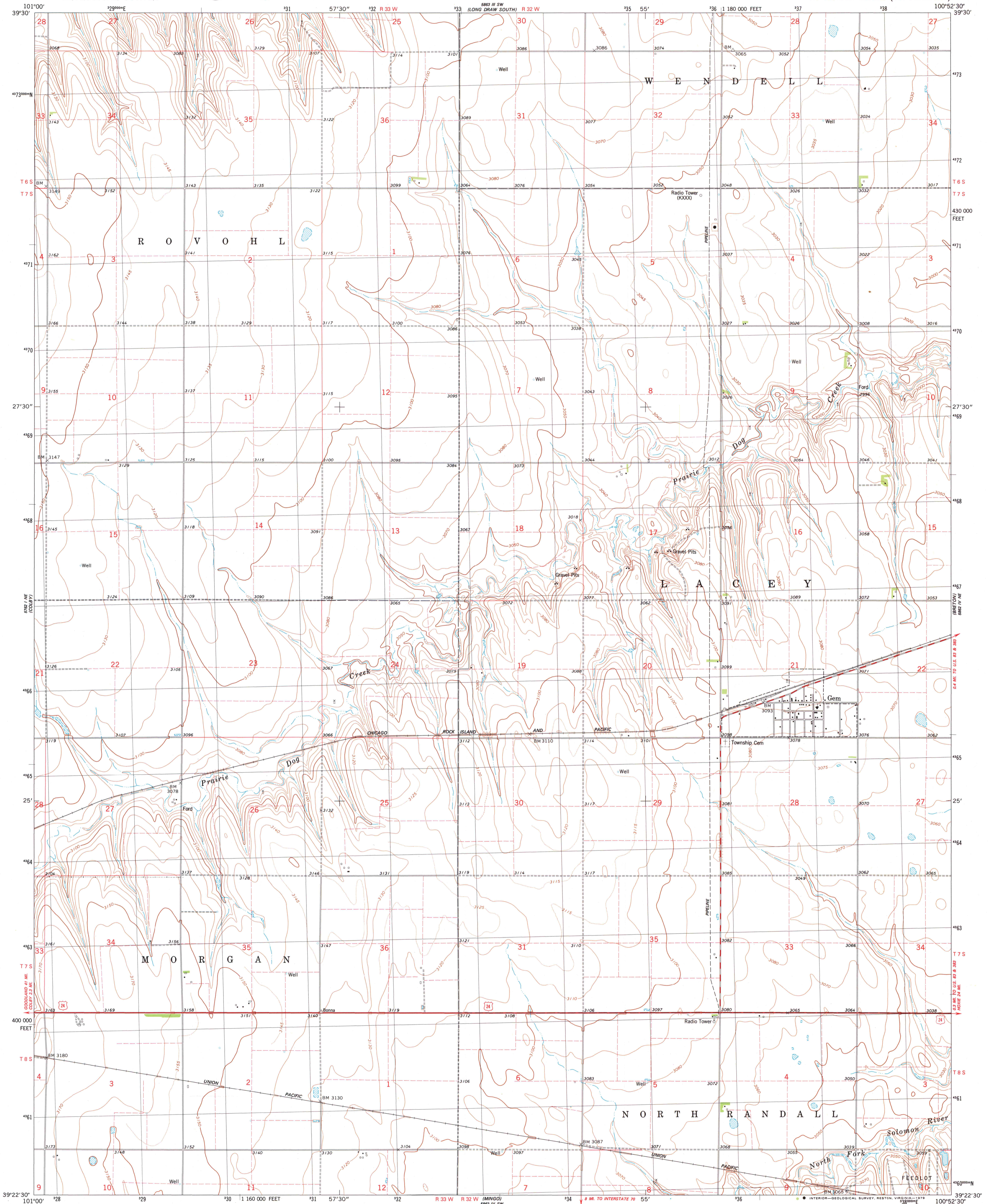

Mapped, edited, and published by the Geological Survey Control by USGS and NOS/NOAA Topography by photogrammetric methods from aerial photographs taken 1974. Field checked 1976. Map edited 1979 Projection and 10,000-foot grid ticks: Kansas coordinate system, north zone (Lambert conformal conic) 1000-meter Universal Transverse Mercator grid, zone 14 1927 North American datum Fine red dashed lines indicate selected fence and field lines where generally visible on aerial photographs. This information is unchecked

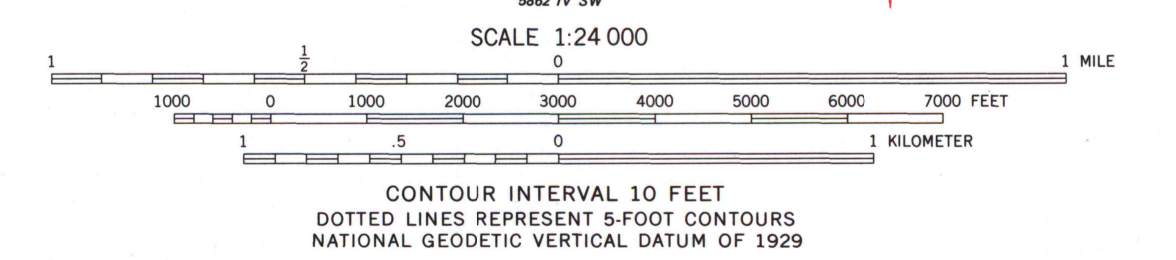
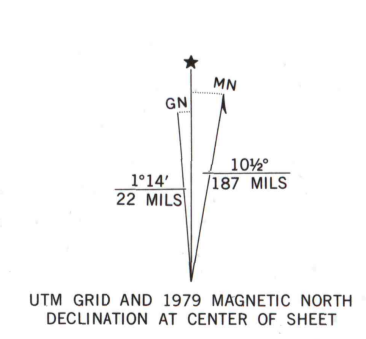

CONTOUR INTERVAL 10 FEET DOTTED LINES REPRESENT 5-FOOT CONTOURS NATIONAL GEODETIC VERTICAL DATUM OF 1929

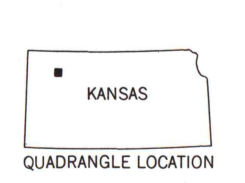

ROAD CLASSIFICATION table with symbols for Primary highway, Secondary highway, Interstate Route, U. S. Route, State Route, Light-duty road, Unimproved road

THIS MAP COMPLIES WITH NATIONAL MAP ACCURACY STANDARDS FOR SALE BY U. S. GEOLOGICAL SURVEY, DENVER, COLORADO 80225, OR RESTON, VIRGINIA 22092 AND STATE GEOLOGICAL SURVEY, LAWRENCE, KANSAS 66044 A FOLDER DESCRIBING TOPOGRAPHIC MAPS AND SYMBOLS IS AVAILABLE ON REQUEST

GEM, KANS. N3922.5-W10052.5/7.5 1979 AMS 5862 IV NW-SERIES V878

MAP AND AIR PH LIBRARY

FEB 20 1980

University of Wisconsin Madison