

CONVERSION
SCALES



Feet Meters
1 3048
2 6096
3 9144
4 12192
5 15240
6 18288
7 21336
8 24384
9 27432
10 30480

To convert feet to meters
multiply by 3.048
To convert meters to feet
multiply by 3.2808

Produced by the United States Geological Survey
in cooperation with State of Kansas agencies
Control by USGS and NOS/NOAA
Topography by photogrammetric methods from aerial photographs
taken 1978. Field checked 1980. Map edited 1982
Supersedes map dated 1955
Projection and 10,000-foot grid ticks: Kansas coordinate
system, north zone (Lambert conformal conic)
1000-meter Universal Transverse Mercator grid, zone 14
1927 North American Datum
To place on the predicted North American Datum 1983
move the projection lines 2 meters north and
26 meters east as shown by dashed corner ticks
There may be private inholdings within the boundaries of the
National or State Reservations shown on this map
Gray tint indicates areas in which only landmark buildings are shown
Fine red dashed lines indicate selected fence and field lines where
generally visible on aerial photographs. This information is unchecked

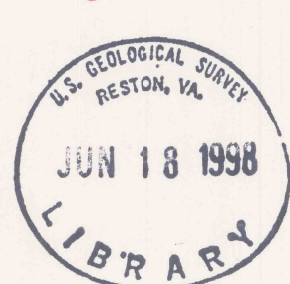
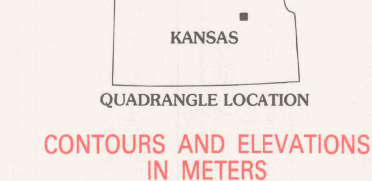
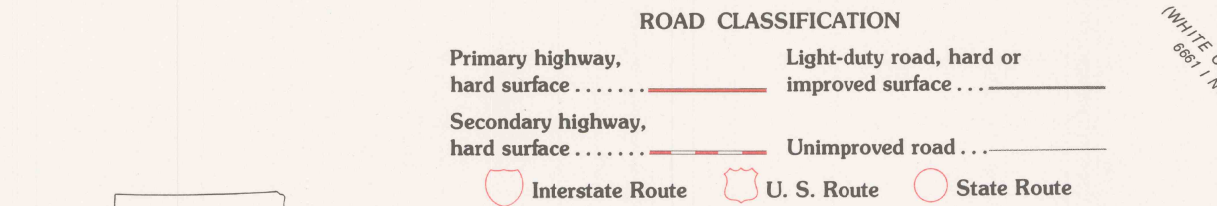
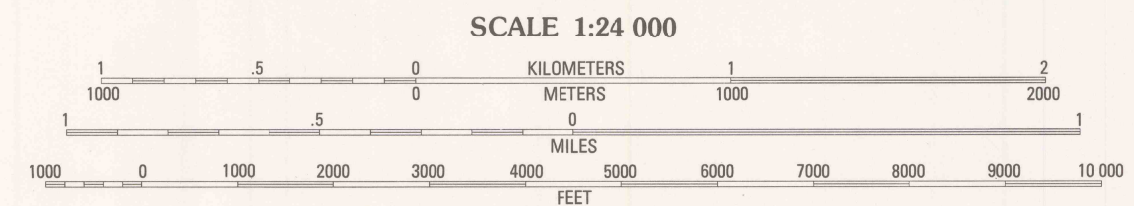
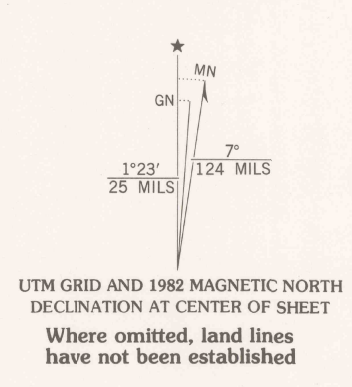

JUNCTION CITY, KANSAS
N3900-W9645/7.5
1982
DMA 6662 III SE-SERIES V878

