

PROTECTION SW
6158 III SE
CREEK SOUTH

UNITED STATES
DEPARTMENT OF THE INTERIOR
GEOLOGICAL SURVEY

PROTECTION NE QUADRANGLE
KANSAS-COMANCHE CO.
7.5 MINUTE SERIES (TOPOGRAPHIC)

PROTECTION NE
6158 III NW
(WISCONSIN)

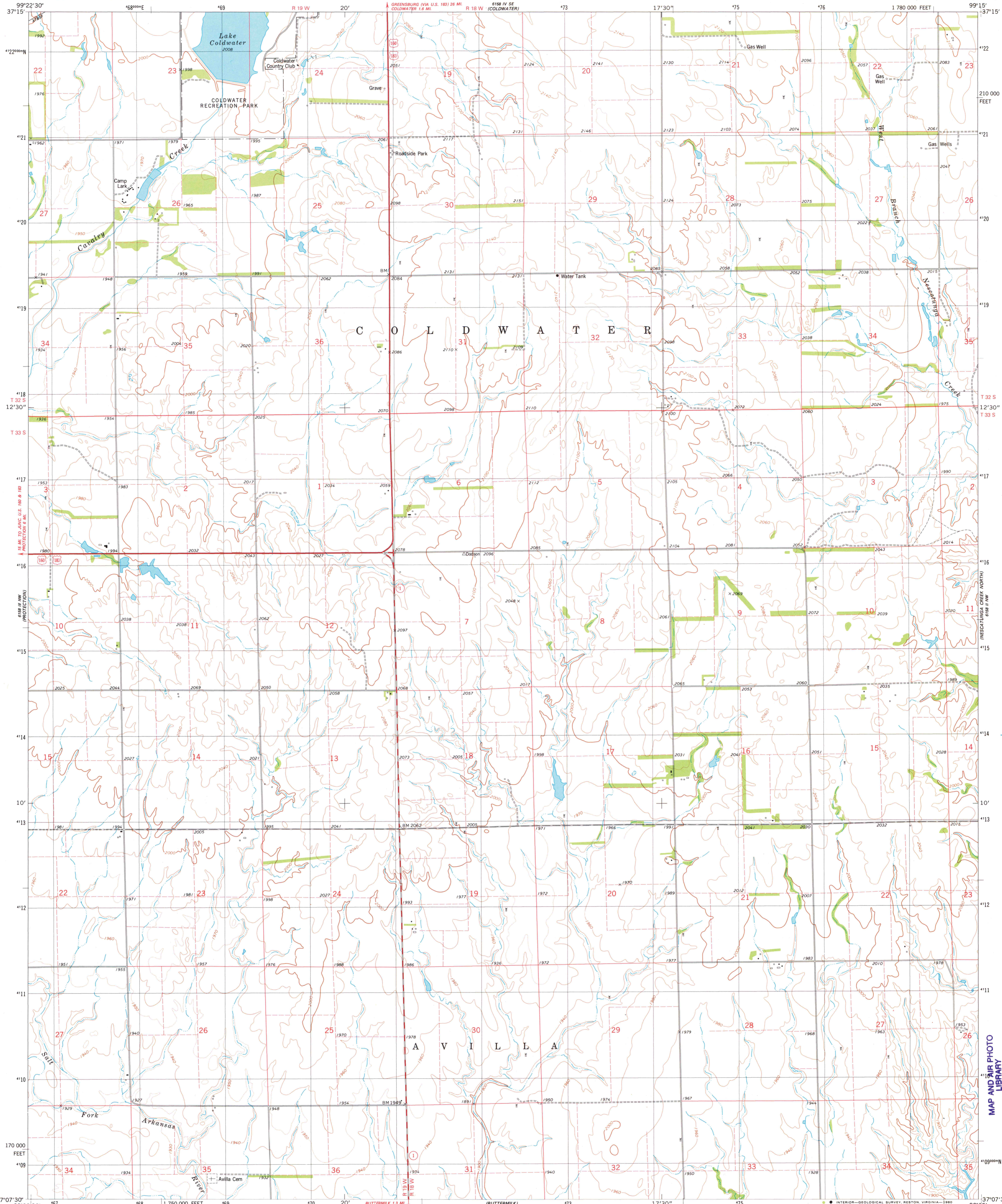

Mapped, edited, and published by the Geological Survey

Control by USGS and NOS/NOAA

Topography by photogrammetric methods from aerial photographs taken 1974. Field checked 1975. Map edited 1979

Projection and 10,000-foot grid ticks: Kansas coordinate system, south zone (Lambert conformal conic) 1000-meter Universal Transverse Mercator grid, zone 14 1927 North American datum

Fine red dashed lines indicate selected fence and field lines where generally visible on aerial photographs. This information is unchecked To place on the predicted North American Datum 1983 move the projection lines 33 meters east as shown by dashed corner ticks

PROTECTION SW
6158 III SE

PROTECTION SW
6158 III SE

PROTECTION SW
6158 III SE

PROTECTION SW
6158 III SE

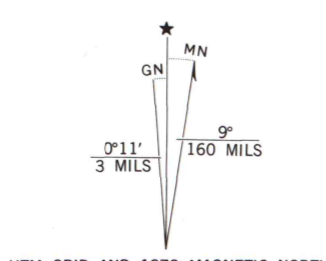

UTM GRID AND 1979 MAGNETIC NORTH DECLINATION AT CENTER OF SHEET

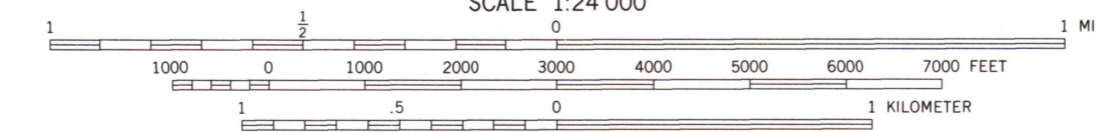

SCALE 1:24 000
CONTOUR INTERVAL 20 FEET
DOTTED LINES REPRESENT 10-FOOT CONTOURS
NATIONAL GEODETIC VERTICAL DATUM OF 1929

THIS MAP COMPLIES WITH NATIONAL MAP ACCURACY STANDARDS FOR SALE BY U.S. GEOLOGICAL SURVEY, DENVER, COLORADO 80225, OR RESTON, VIRGINIA 22092 AND STATE GEOLOGICAL SURVEY, LAWRENCE, KANSAS 66044 A FOLDER DESCRIBING TOPOGRAPHIC MAPS AND SYMBOLS IS AVAILABLE ON REQUEST

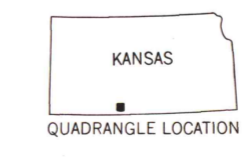

QUADRANGLE LOCATION

ROAD CLASSIFICATION

Primary highway, hard surface	Light-duty road, hard or improved surface
Secondary highway, hard surface	Unimproved road
Interstate Route	U.S. Route
	State Route

PROTECTION NE, KANSAS
N3707.5-W9915/7.5

1979

DMA 6158 III NE-SERIES V878

MAP AND AIR PHOTO LIBRARY

SEP 29 1980

University of Wisconsin
Madison

PROTECTION SW
6158 III SE

PROTECTION SW
6158 III SE

PROTECTION SW
6158 III SE

PROTECTION SW
6158 III SE