

1:25,000
1:50,000
1:100,000

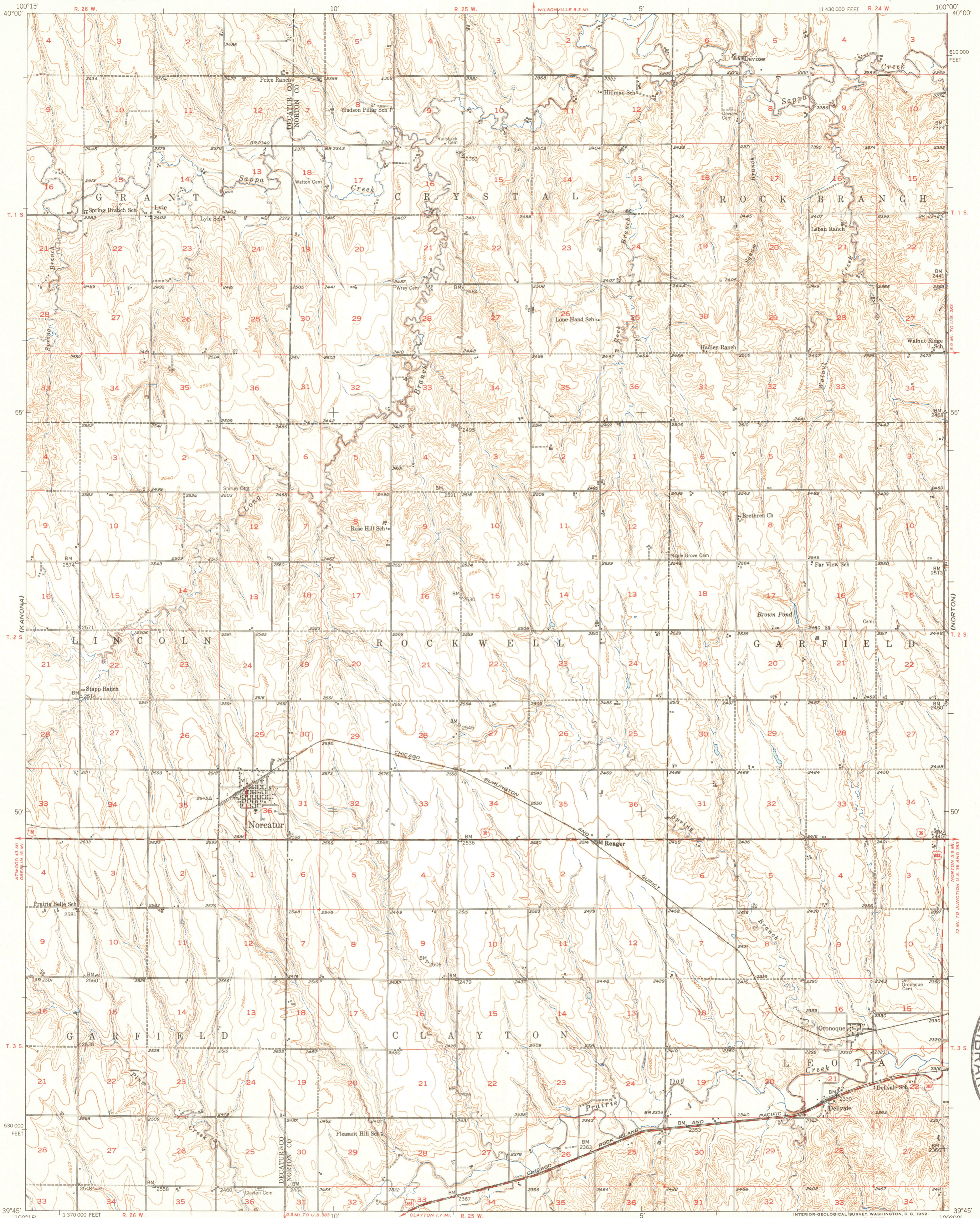

Mapped, edited, and published by the Geological Survey as part of the Department of the Interior program for the development of the Missouri River Basin
Control by USGS and USC&GS
Topography from aerial photographs by multiplex methods and by plane-table surveys 1951. Aerial photographs taken 1950
Polyconic projection. 1927 North American datum
10,000-foot grid based on Kansas coordinate system, north zone

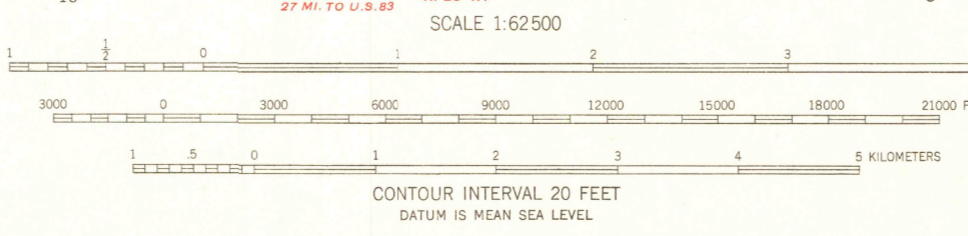
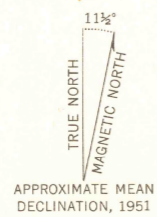

ROAD CLASSIFICATION

Heavy-duty	4 LANE 16 LANE	Light-duty
Medium-duty	4 LANE 16 LANE	Unimproved dirt

US GEOLOGICAL SURVEY
LIBRARY

DEC 15 2011

NORCATUR, KANS.
N 3945-W 10000/15

1951

THIS MAP COMPLIES WITH NATIONAL MAP ACCURACY STANDARDS
FOR SALE BY U. S. GEOLOGICAL SURVEY, FEDERAL CENTER, DENVER, COLORADO OR WASHINGTON 25, D. C.
AND BY THE STATE GEOLOGICAL SURVEY, LAWRENCE, KANSAS
A FOLDER DESCRIBING TOPOGRAPHIC MAPS AND SYMBOLS IS AVAILABLE ON REQUEST

RESTON, VIRGINIA

U.S. GEOLOGICAL SURVEY
LIBRARY
OCT 14 1952
WASHINGTON

1:25,000
1:50,000
1:100,000