

UNITED STATES
DEPARTMENT OF THE INTERIOR
GEOLOGICAL SURVEY

JUNC. U.S. NO. 83 8.4 MI.
KANSAS
(FINNEY COUNTY)
TENNIS QUADRANGLE
15-MINUTE SERIES

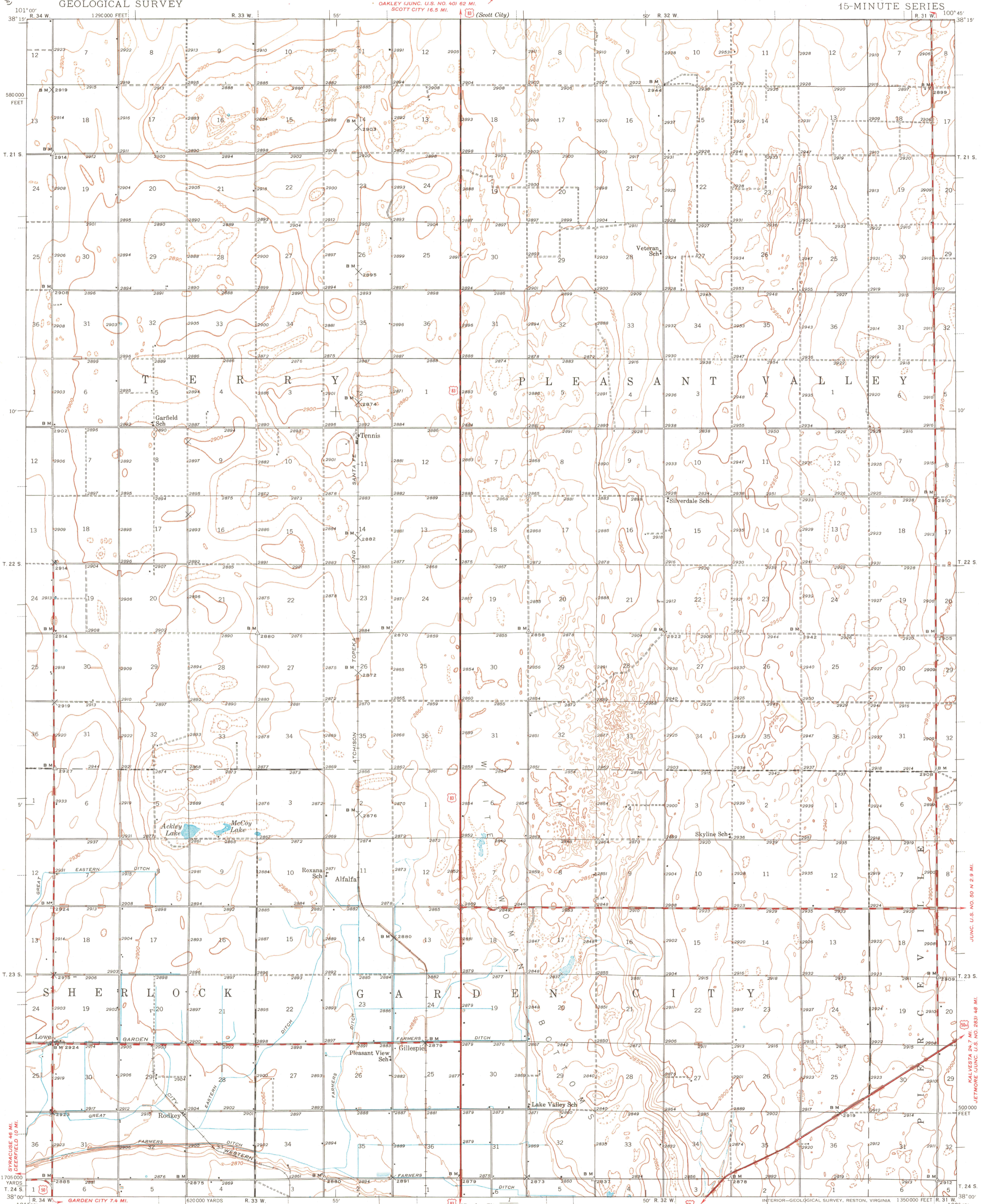

Topography by S. D. Farmer, H. S. Hall,
P. L. Zumwalt, and Elmer Elshire
Surveyed in 1940, 1941

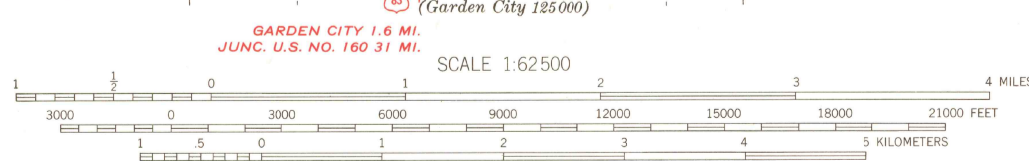

Interior-Geological Survey, Reston, Virginia 1:50000 Feet; R. 31 W. 38° 00' N. 100° 45' W. (Garden City)

ROAD CLASSIFICATION
Heavy-duty ——— Light-duty ———
Medium-duty ——— Unimproved dirt ———
U.S. Route

TENNIS, KANS.
Edition of 1944
N3800-W10045/15

Contour interval 10 feet
Dashed lines represent 5 foot contours
Datum is mean sea level

APPROXIMATE MEAN
DECLINATION, 1941