

UNITED STATES  
DEPARTMENT OF THE INTERIOR  
GEOLOGICAL SURVEY

JUNC. U. S. NO. 83 8.4 MI.  
KANSAS  
(FINNEY COUNTY)  
TENNIS QUADRANGLE  
15-MINUTE SERIES

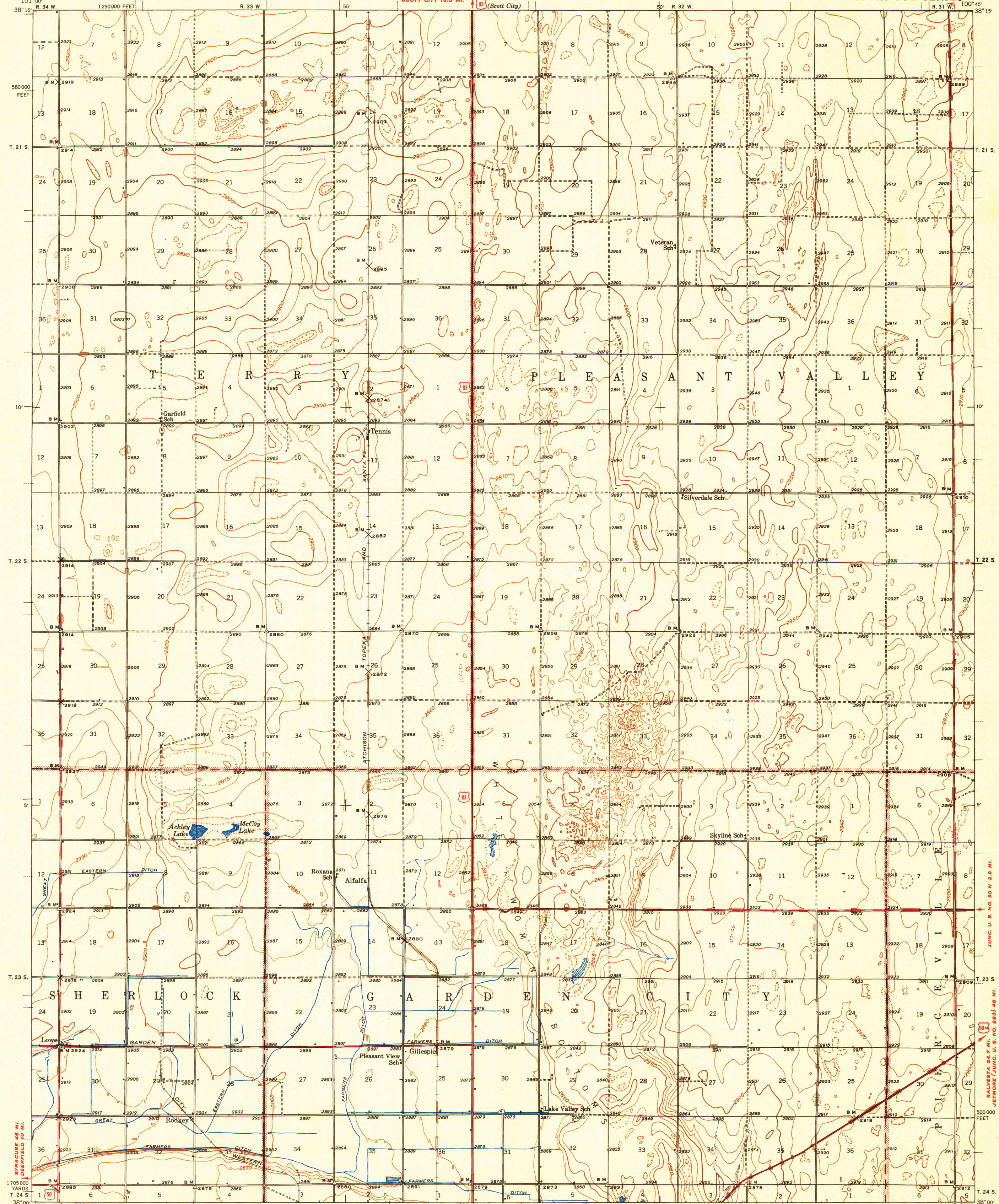

Topography by S. D. Farmer, H. S. Hall,  
P. L. Zumwalt, and Elmer Elshire  
Surveyed in 1940, 1941

TRUE NORTH  
MAGNETIC SOUTH  
APPROXIMATE MEAN  
DECLINATION, 1941

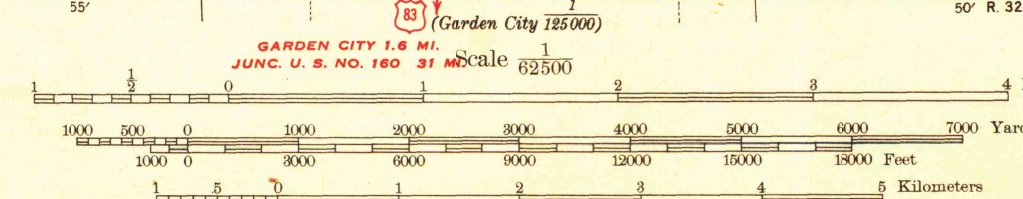

Polyconic projection, 1927 North American datum  
5000 yard grid based on U. S. zone system, D  
10000 foot grid based on Kansas (South)  
rectangular coordinate system

Contour interval 10 feet  
Dashed lines represent 5 foot contours  
Datum is mean sea level

ROUTES USUALLY TRAVELED  
HARD IMPERVIOUS SURFACES  
OTHER SURFACE IMPROVEMENTS  
U. S. ROUTE 1944 STATE ROUTE

TENNIS, KANS.  
Edition of 1944  
N 3800-W 10045  
"UNIVERSITY OF WISCONSIN"  
Department of Geography