

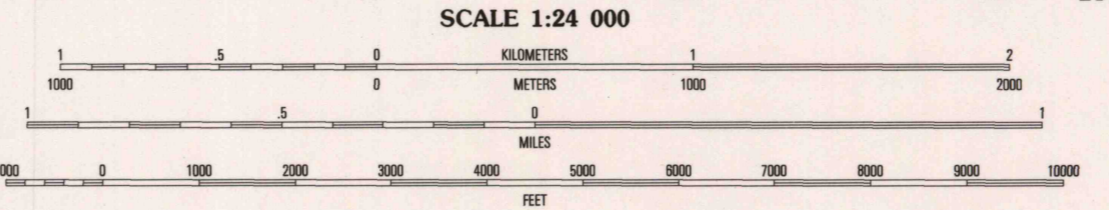

USGS AND HISTORICAL
MAP ARCHIVES
APR 04 1996
REC'D FILE COPY

Produced by the United States Geological Survey
Compiled by photogrammetric methods from imagery dated 1951
Field checked 1953. Revised 1963. Revised in cooperation
with State of Kentucky agencies from imagery dated 1993
Survey control current as of 1963. Map edited 1995. Contours
not revised.
North American Datum of 1983 (NAD 83). Projection and
blue 1000-meter ticks: Universal Transverse Mercator, zone 16
10 000-foot ticks: Kentucky Coordinate System of 1983 (south zone)
North American Datum of 1927 (NAD 27) is shown by dashed
corner ticks. The values of the shift between NAD 83 and NAD 27
for 7.5-minute intersections are obtainable from National Geodetic
Survey NADCON software.
Area covered by dashed light-blue pattern is subject
to controlled inundation.

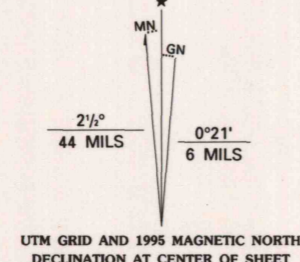

SCALE 1:24 000
CONTOUR INTERVAL 10 FEET
NATIONAL GEODETIC DATUM OF 1929

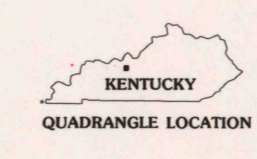

ROAD CLASSIFICATION
Primary highway hard surface Light-duty road, hard or improved surface
Secondary highway hard surface Unimproved road
Interstate Route U.S. Route State Route

1	2	3	1 Mattingly
			2 Harrodsburg
			3 Garfield
4		5	4 Glen Dean
			5 Center
			6 Falls of Rough
6	7	8	7 McDaniels
			8 Madrid

THIS MAP COMPLIES WITH NATIONAL MAP ACCURACY STANDARDS
FOR SALE BY U.S. GEOLOGICAL SURVEY, DENVER, COLORADO 80225, OR RESTON, VIRGINIA 22092
KENTUCKY GEOLOGICAL SURVEY, LEXINGTON, KENTUCKY 40506
AND KENTUCKY DEPARTMENT OF COMMERCE, FRANKFORT, KENTUCKY 40601
A FOLDER DESCRIBING TOPOGRAPHIC MAPS AND SYMBOLS IS AVAILABLE ON REQUEST

KINGSWOOD, KY
37086-F4-TF-024
1993

DMA 3759 III NW-SERIES V853

ISBN 0-547-42356-8
9 780607 462356