

Mapped by the Army Map Service and the Geological Survey
Edited and published by the Geological Survey
Control by USGS and NOS/NOAA
Topography by photogrammetric methods from aerial photographs
taken 1949. Field checked 1950. Revised from aerial photographs
taken 1978. Field checked 1978. Map edited 1982
Polyconic projection. 10,000-foot grid ticks based
on Kentucky coordinate system, north zone
1000-meter Universal Transverse Mercator grid, zone 16
1927 North American Datum
To place on the predicted North American Datum 1983
move the projection lines 4 meters south and
3 meters west as shown by dashed corner ticks
Fine red dashed lines indicate selected fence and field lines where
generally visible on aerial photographs. This information is unchecked

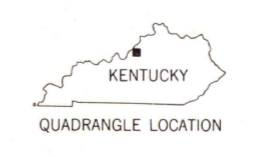
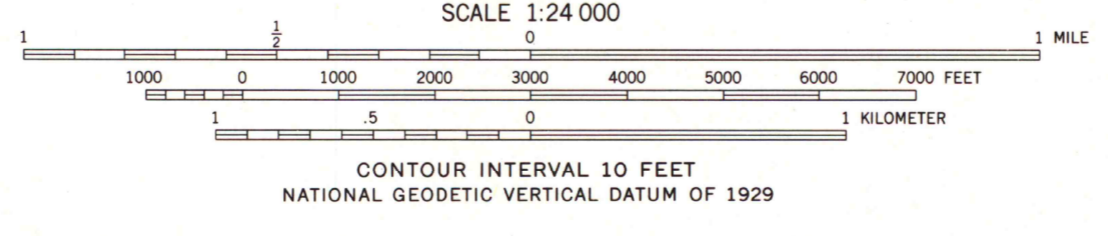
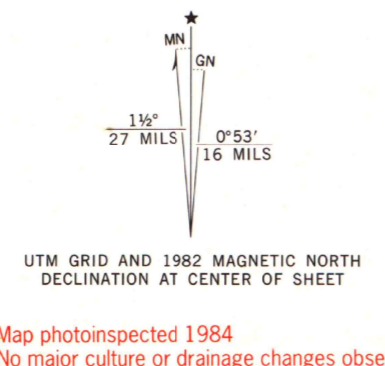

ROAD CLASSIFICATION

Primary highway, hard surface	Light-duty road, hard or improved surface
Secondary highway, hard surface	Unimproved road
Interstate Route	U. S. Route
	State Route

THIS MAP COMPLIES WITH NATIONAL MAP ACCURACY STANDARDS
FOR SALE BY U. S. GEOLOGICAL SURVEY, DENVER, COLORADO 80225, OR RESTON, VIRGINIA 22092
KENTUCKY GEOLOGICAL SURVEY, LEXINGTON, KENTUCKY 40506
AND KENTUCKY DEPARTMENT OF COMMERCE, FRANKFORT, KENTUCKY 40601
A FOLDER DESCRIBING TOPOGRAPHIC MAPS AND SYMBOLS IS AVAILABLE ON REQUEST

MOUNT WASHINGTON, KY.
SE/4 LOUISVILLE 15' QUADRANGLE
N3800-W8530/7.5
1982
PHOTOINSPECTED 1984
DMA 3860 II SE-SERIES 1985

U. S. Regional
Depository Copy
DO NOT DISCARD

A. H. ROBINSON
MAP LIBRARY
OCT 16 1990
University of Wisconsin
Madison