

38° 52' 30" 84° 00' 55' 50' 83° 45' 38° 52' 30"

Advance sheet
Subject to correction

(Felicity)

(Spaman)

OHIO PART IS SHOWN ON MAP OF HIGGINSPORT QUADRANGLE
PUBLISHED IN 1918, SCALE 1:62,500

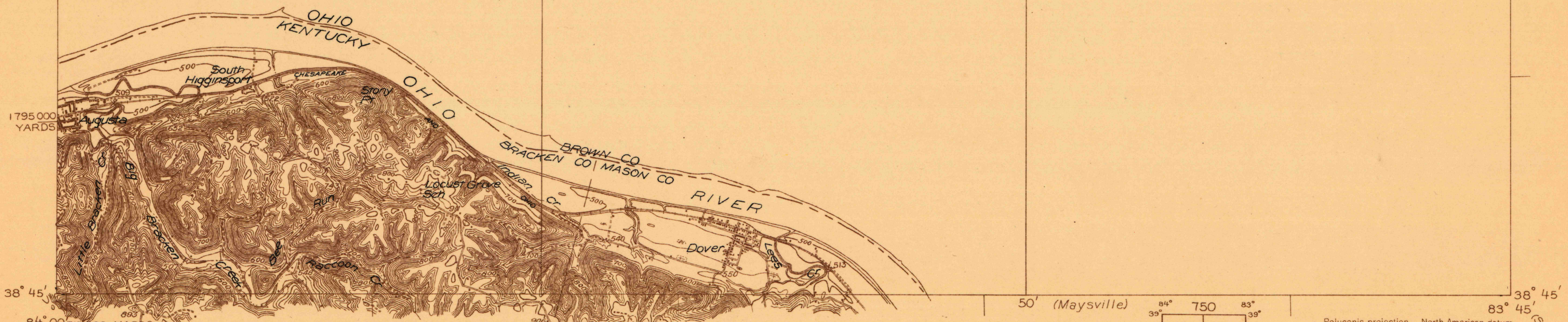

1795 000
YARDS

38° 45'

84° 00' 713 000
YARDS

Glenn S. Smith, Division Engineer
Topography by G.H. Davey
Ohio River by Corps of Engineers, U. S. Army
Control by U. S. Geological Survey and
Corps of Engineers, U. S. Army
Surveyed in 1928

TRUE NORTH
MAGNETIC NORTH
APPROXIMATE MEAN
DECLINATION, 1928

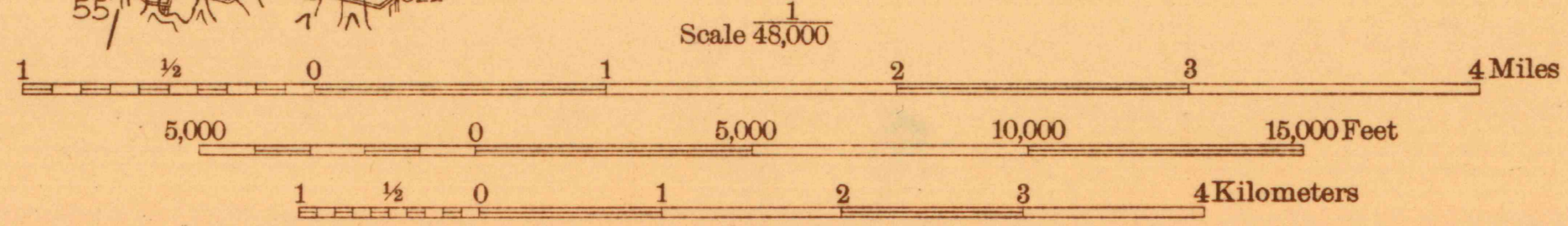

Contour interval 20 feet
Datum is mean sea level

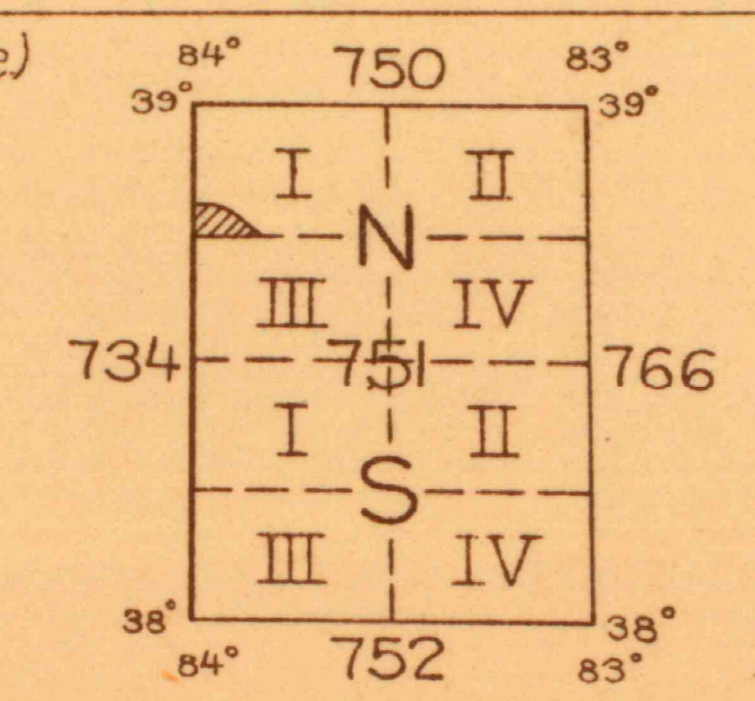

Polyconic projection. North American datum
5000 yard grid based upon U. S. zone system, B

HISTORICAL FILES
RETURN TO CENTRAL FILE
HIGGINSPORT
(DO NOT REMOVE)

38° 45'

83° 45'

(Springdale)