

Advance sheet.
Subject to correction.

TOPOGRAPHY.
MILLERS
Miller Sheet

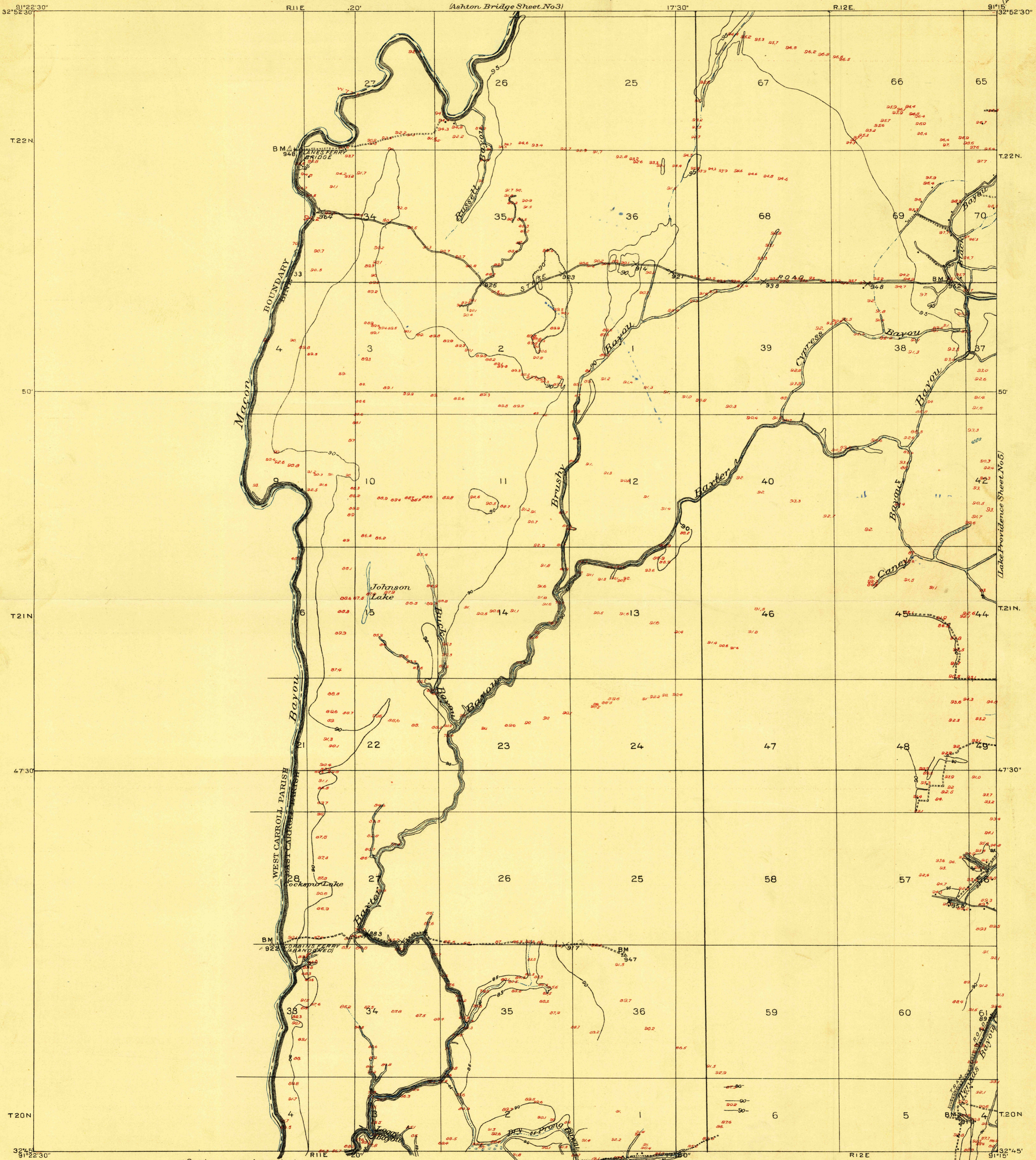

R. B. Marshall, Chief Geographer.
Frank Sutton, Geographer in charge.
Topography by W.N. Vance, R.A. Kiger and E.V. Perkinson.
Control by C.B. Kendall and H.W. Peabody.
Surveyed in 1909.
SURVEYED IN COOPERATION WITH THE FIFTH LOUISIANA LEVEE DISTRICT.

+ Section corners located, other corners compiled from Land Office surveys

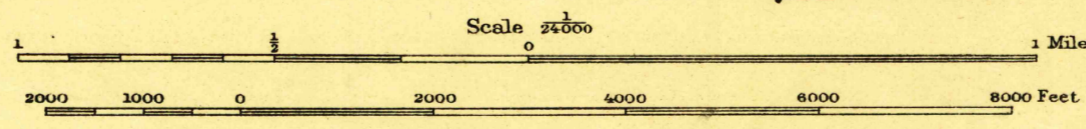

Contour interval 5 feet.
Datum to mean sea level.

USGS
Historical File
Topographic Division

USGS
Historical File
Topographic Division

TRUE NORTH
MAGNETIC NORTH
APPROXIMATE MEAN DECLINATION 1909

