

Produced by the United States Geological Survey
Control by USGS and NOS/NOAA
Planimetry by photogrammetric methods from aerial photographs taken 1952 and 1956. Topography by planetable surveys 1953
Revised from aerial photographs taken 1990. Field checked 1993
Map edited 1994
North American Datum of 1927 (NAD 27). Projection and blue 1000-meter ticks: Universal Transverse Mercator, zone 15
10,000-foot ticks: Louisiana coordinate system, south zone
North American Datum of 1983 (NAD 83) is shown by dashed corner ticks. The values of the shift between NAD 27 and NAD 83 for 7.5-minute intersections are obtainable from National Geodetic Survey NADCON software
Where omitted, land lines have not been established or are not shown because of insufficient data
This map covers an active subsidence area. Evaluate relief and elevation information based on recent sources

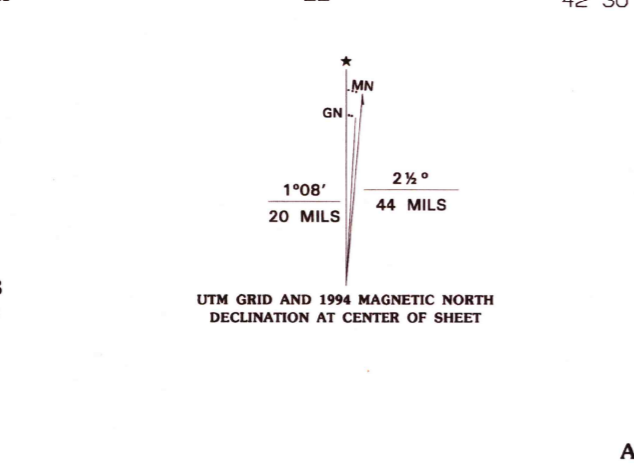

SCALE 1:24000
CONTOUR INTERVAL 5 FEET
NATIONAL GEODETIC VERTICAL DATUM OF 1929
THIS MAP COMPLIES WITH NATIONAL MAP ACCURACY STANDARDS
FOR SALE BY U.S. GEOLOGICAL SURVEY, DENVER, COLORADO 80225, OR RESTON, VIRGINIA 22092
AND LOUISIANA DEPARTMENT OF TRANSPORTATION AND DEVELOPMENT, BATON ROUGE, LOUISIANA 70804
A FOLDER DESCRIBING TOPOGRAPHIC MAPS AND SYMBOLS IS AVAILABLE ON REQUEST

ROAD CLASSIFICATION

- Primary highway hard surface
- Secondary highway hard surface
- Unimproved road
- Light-duty road, hard or improved surface
- U.S. Route
- State Route

QUADRANGLE LOCATION

1	2	3
4	5	6
7	8	

1 Bayou Sauvour
2 Lake Outtman
3 Lake Tambour
4 Dog Lake
5 Lake La Grasse
6 Central Isles Deshermes
7 Eastern Isles Deshermes
8 Cat Island Pass

USGS AND HISTORICAL MAP ARCHIVES
DEC 09 1994
REC'D FILE COPY

COCODRIE, LA.
29090-B6-TF-024
1994
DMA 7842 II NW-SERIES V885