

PANTHER LAKE QUADRANGLE
LOUISIANA
7.5 MINUTE SERIES (TOPOGRAPHIC)

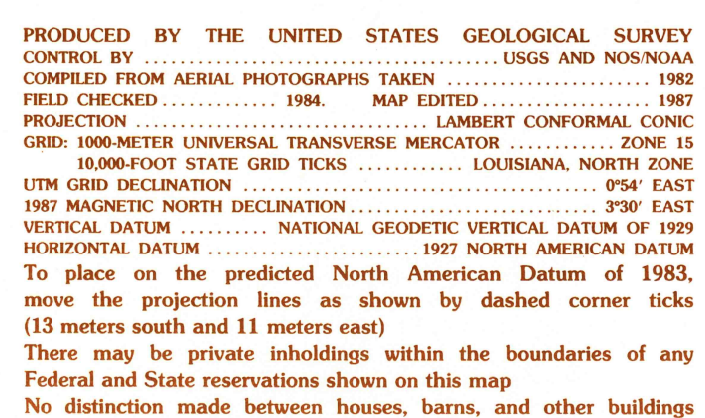

SCALE 1:24 000

The scale section contains four horizontal bars. The top bar is for miles, with a total length of 1 mile, divided into 8 segments of 1/8 mile each, with major ticks at 0, 1, and 2 miles. The second bar is for feet, with a total length of 10,000 feet, divided into 10 segments of 1,000 feet each, with major ticks at 0, 1,000, 2,000, 3,000, 4,000, 5,000, 6,000, 7,000, 8,000, 9,000, and 10,000 feet. The third bar is for kilometers, with a total length of 2 kilometers, divided into 4 segments of 1/2 kilometer each, with major ticks at 0, 1, and 2 kilometers. The bottom bar is for meters, with a total length of 2,000 meters, divided into 4 segments of 500 meters each, with major ticks at 0, 500, 1,000, 1,500, and 2,000 meters.

CONTOUR INTERVAL 5 FEET

CONTROL ELEVATIONS SHOWN TO THE NEAREST 0.1 FOOT
OTHER ELEVATIONS SHOWN TO THE NEAREST FOOT

To convert feet to meters multiply by .3048
To convert meters to feet multiply by 3.2808

THIS MAP COMPLIES WITH NATIONAL MAP ACCURACY STANDARDS
FOR SALE BY U. S. GEOLOGICAL SURVEY, DENVER, COLORADO 80225, OR RESTON, VIRGINIA 22092
AND LOUISIANA DEPARTMENT OF PUBLIC WORKS, BATON ROUGE, LOUISIANA 70804

PANTHER LAKE, LOUISIANA
SE/4 MITCHNER 15' QUADRANGLE
PROVISIONAL EDITION 1987

32091-E3-TF-024

USGS NMF HISTORICAL MAP
SEP 07 1988
REC'D FILE COPY