

Produced by the United States Geological Survey  
Planimetry by photogrammetric methods from imagery dated 1951 and 1955  
Topography by planimetric surveys 1952 and 1956. Revised from imagery dated 1989 and other sources. Field checked 1993. Map edited 1995  
North American Datum of 1927 (NAD 27). Projection and blue 1000-meter ticks: Universal Transverse Mercator, zone 16  
10 000-foot ticks: Louisiana coordinate system, south zone  
North American Datum of 1983 (NAD 83) is shown by dashed corner ticks. The values of the shift between NAD 27 and NAD 83 for 7.5-minute intersections are obtainable from National Geodetic Survey NADCON software  
There may be private inholdings within the boundaries of the National or State reservations shown on this map  
City of New Orleans and Orleans Parish are coextensive  
This map covers an active subsidence area. Evaluate relief and elevation information based on recent sources

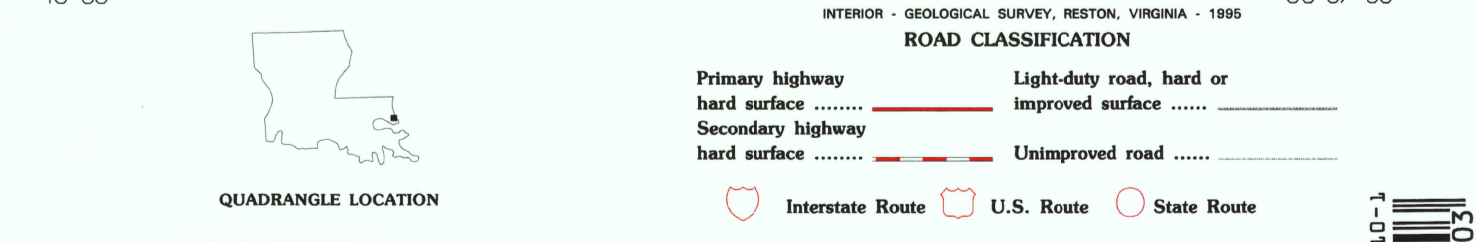

QUADRANGLE LOCATION

1	2	3	1 Slidell
4	5	6	2 Haswood
7	8	7	3 Logtown
		8	4 North Shore
			5 English Lookout
			6 Chef Menteur
			7 Alligator Point
			8 False Mouth Bayou

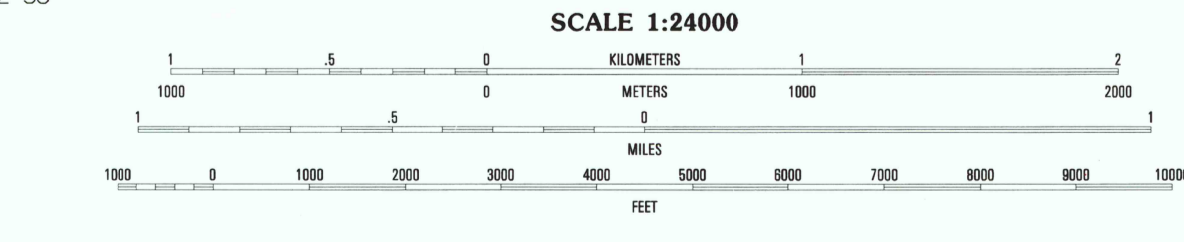
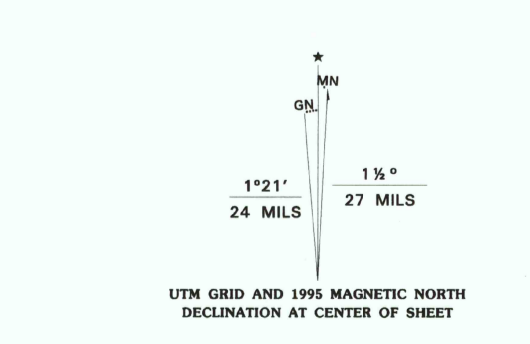

RIGOLETS, LA  
30089-B6-TF-024  
1993

THIS MAP COMPLIES WITH NATIONAL MAP ACCURACY STANDARDS  
FOR SALE BY U.S. GEOLOGICAL SURVEY, DENVER, COLORADO 80225, OR RESTON, VIRGINIA 22092  
AND LOUISIANA DEPARTMENT OF TRANSPORTATION AND DEVELOPMENT, BATON ROUGE, LOUISIANA 70804  
A FOLDER DESCRIBING TOPOGRAPHIC MAPS AND SYMBOLS IS AVAILABLE ON REQUEST

ISBN 0-607-62291-1  
9 780607 229103

DMA 8044 II NW - SERIES Y885