

Produced by the United States Geological Survey  
Control by USGS, NOS/NOAA and Louisiana Highway Department  
Topography by photogrammetric methods from aerial photographs  
taken 1952 and planetable surveys 1952-53. Revised from aerial  
photographs taken 1989. Field checked 1991. Map edited 1992  
Projection and 10,000-foot grid ticks: Louisiana coordinate  
system, south zone (Lambert conformal conic)  
1000-meter Universal Transverse Mercator grid, zone 15  
1927 North American Datum  
The difference between 1927 North American Datum and North  
American Datum of 1983 (NAD 83) for 7.5-minute intersections  
is given in USGS Bulletin 1875. The NAD 83 is shown by  
dashed corner ticks  
There may be private inholdings within the boundaries of the  
National or State reservations shown on this map  
Gray tint indicates areas in which only landmark buildings are shown  
All or part of this quadrangle lies within a subsidence area  
Fine red dashed lines indicate selected fence and field lines where  
generally visible on aerial photographs. This information is unchecked

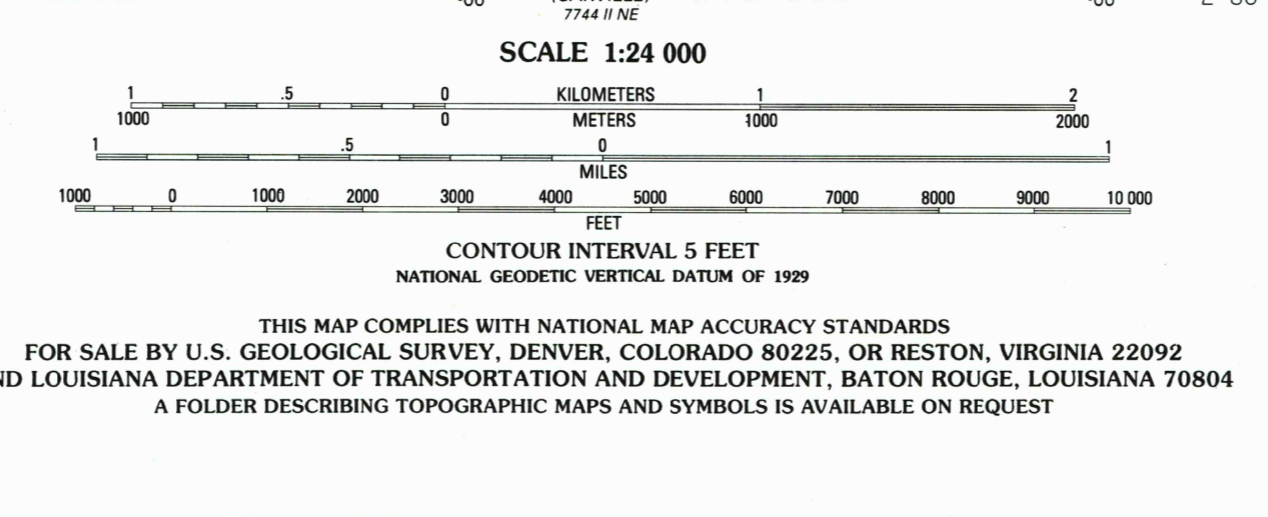
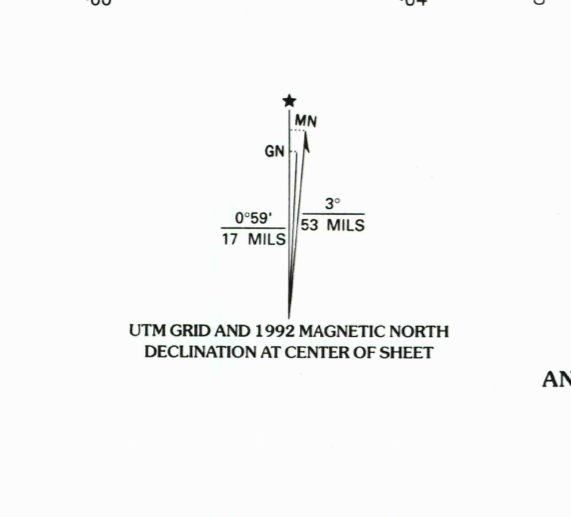

ROAD CLASSIFICATION

Primary highway, hard surface	Light-duty road, hard or improved surface
Secondary highway, hard surface	Unimproved road
U. S. Route	State Route

LOUISIANA QUADRANGLE LOCATION

ST. GABRIEL, LA.  
SE/4 BATON ROUGE 15' QUADRANGLE  
30091-C1-TF-024  
1992  
DMA 7744 | SE-SERIES V885

REC'D FILE COPY  
JAN 31 1998

ISBN 0-607-22944-5  
9 780607 229448