

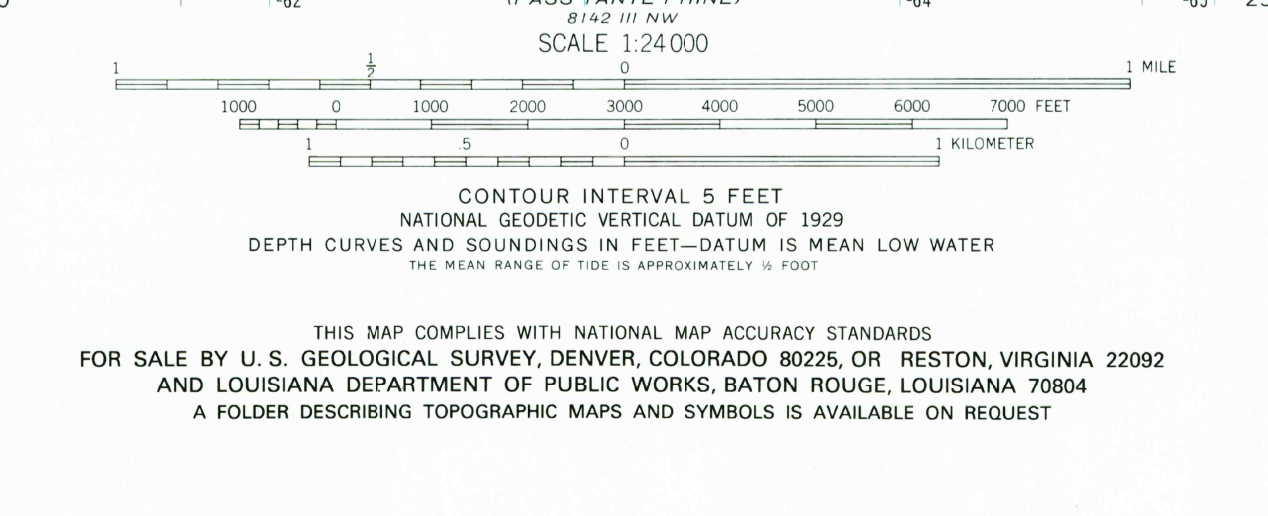

Mapped, edited, and published by the Geological Survey  
Control by USGS and USC&GS  
Orthophotomap prepared from high-altitude aerial photographs  
taken October 24, 1971. Topography by planetable surveys 1971  
Supersedes Fort St. Philip planimetric map dated 1935  
Selected hydrographic data compiled from USC&GS Chart 1272 (1969)  
This information is not intended for navigational purposes  
Polyconic projection. 1927 North American datum  
10,000-foot grid based on Louisiana coordinate system,  
south zone  
1000-meter Universal Transverse Mercator grid ticks,  
zone 16, shown in blue  
To place on the predicted North American Datum 1983,  
move the projection lines 20 meters south and  
6 meters east as shown by dashed corner ticks  
All or part of this quadrangle lies within a subsidence area

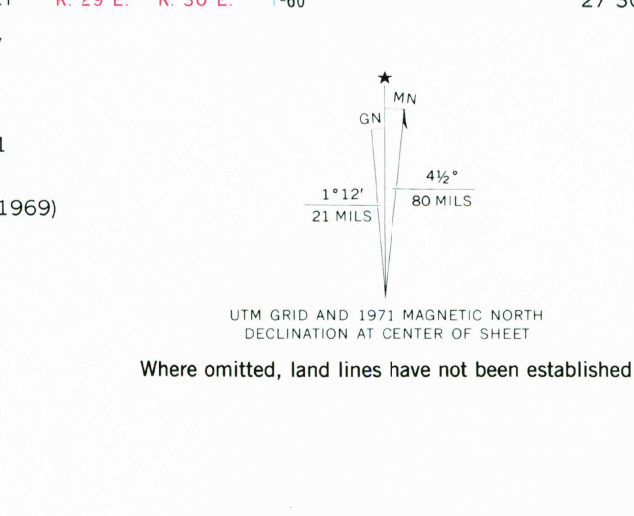

ROAD CLASSIFICATION

- Primary highway, hard surface
- Secondary highway, hard surface
- Light-duty road, hard or improved surface
- Unimproved road
- Interstate Route
- U. S. Route
- State Route

TRIUMPH, LA.  
SW/4 VENICE 15' QUADRANGLE  
N2915-W8922.5/7.5  
1971  
AMS 8142 IV SW—SERIES V8850

USGS NHD HISTORICAL MAP  
REC'D FILE COPY

THIS MAP COMPLIES WITH NATIONAL MAP ACCURACY STANDARDS  
FOR SALE BY U. S. GEOLOGICAL SURVEY, DENVER, COLORADO 80225, OR RESTON, VIRGINIA 22092  
AND LOUISIANA DEPARTMENT OF PUBLIC WORKS, BATON ROUGE, LOUISIANA 70804  
A FOLDER DESCRIBING TOPOGRAPHIC MAPS AND SYMBOLS IS AVAILABLE ON REQUEST

APR 10 1989