

Advance sheet  
Subject to correction

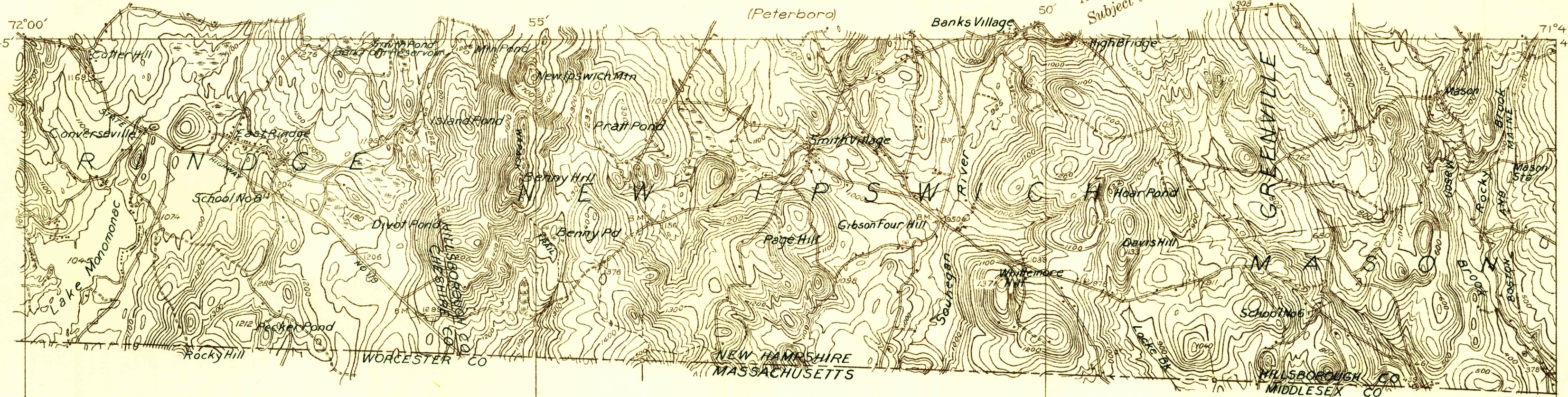

THIS AREA IS SHOWN ON THE MAP OF FITCBURG  
QUADRANGLE, SURVEYED IN 1887, SCALE 1:62,500

USGS  
Historical File  
Topographic Division

Albert Pike, Division Engineer  
Topography by A.J. Ogle  
Control by U. S. Geological Survey and  
Massachusetts Harbor and Land Commission  
Surveyed in 1931

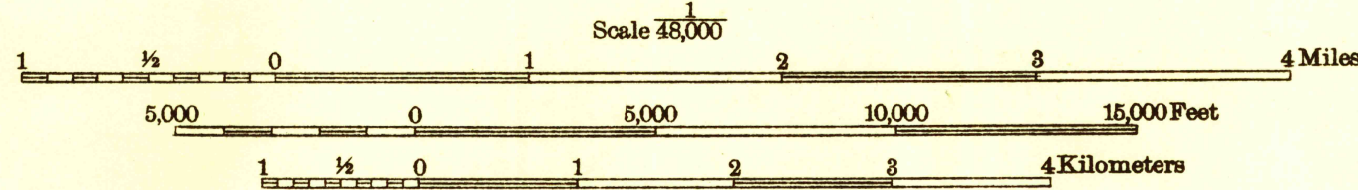
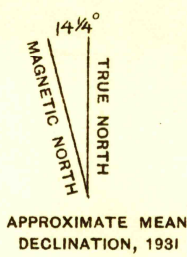

Contour interval 20 feet  
Datum is mean sea level

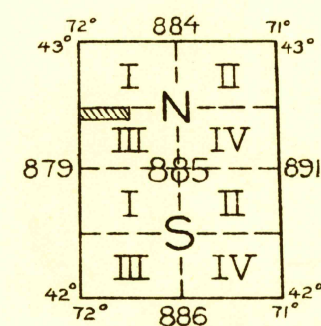

Polyconic projection. North American datum

U. S. G. S.  
FILE COPY  
Instruction and Editing.