

Advance sheet
Subject to correction

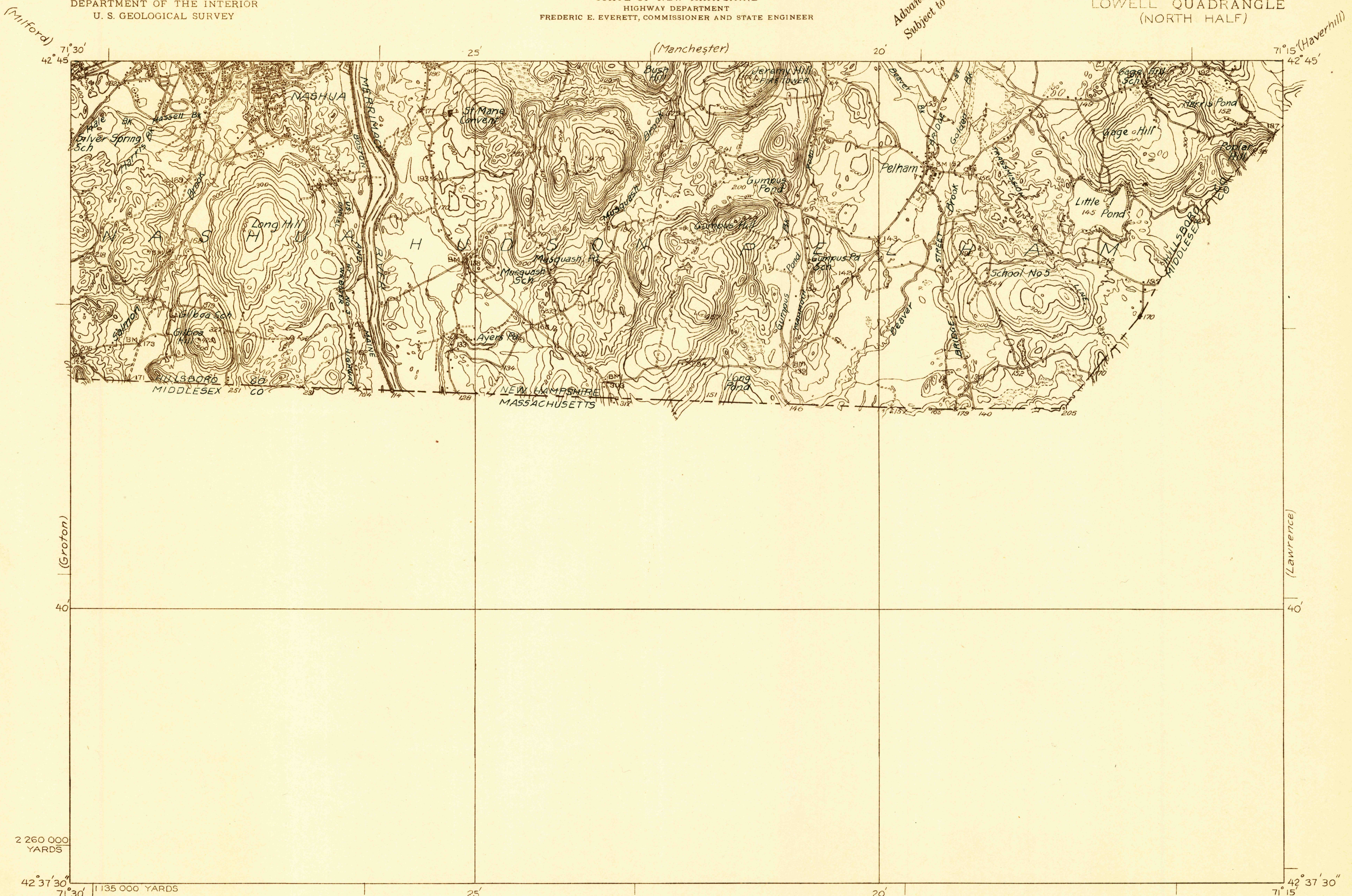

2 260 000
YARDS
42° 37' 30"

Albert Pike, Division Engineer
Topography by Roscoe Reeves
Control by U. S. Geological Survey and
Mass. Harbor and Land Commission
Surveyed in 1931

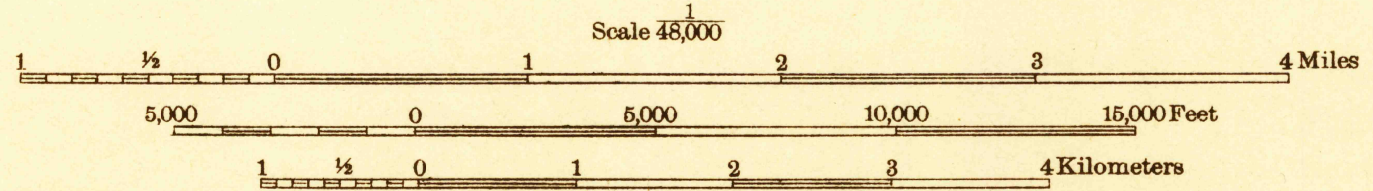
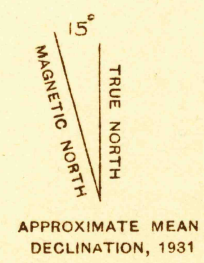

Contour interval 20 feet
Datum is mean sea level

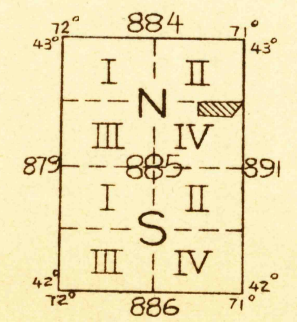

USGS
Historical File
Topographic Division

Polyconic projection. North American datum
5000 yard grid based upon U. S. zone system, A

LOWELL, MASS.; N.H.
(NORTH HALF)