

MAPPED BY U.S.G.S. IN
1896-7

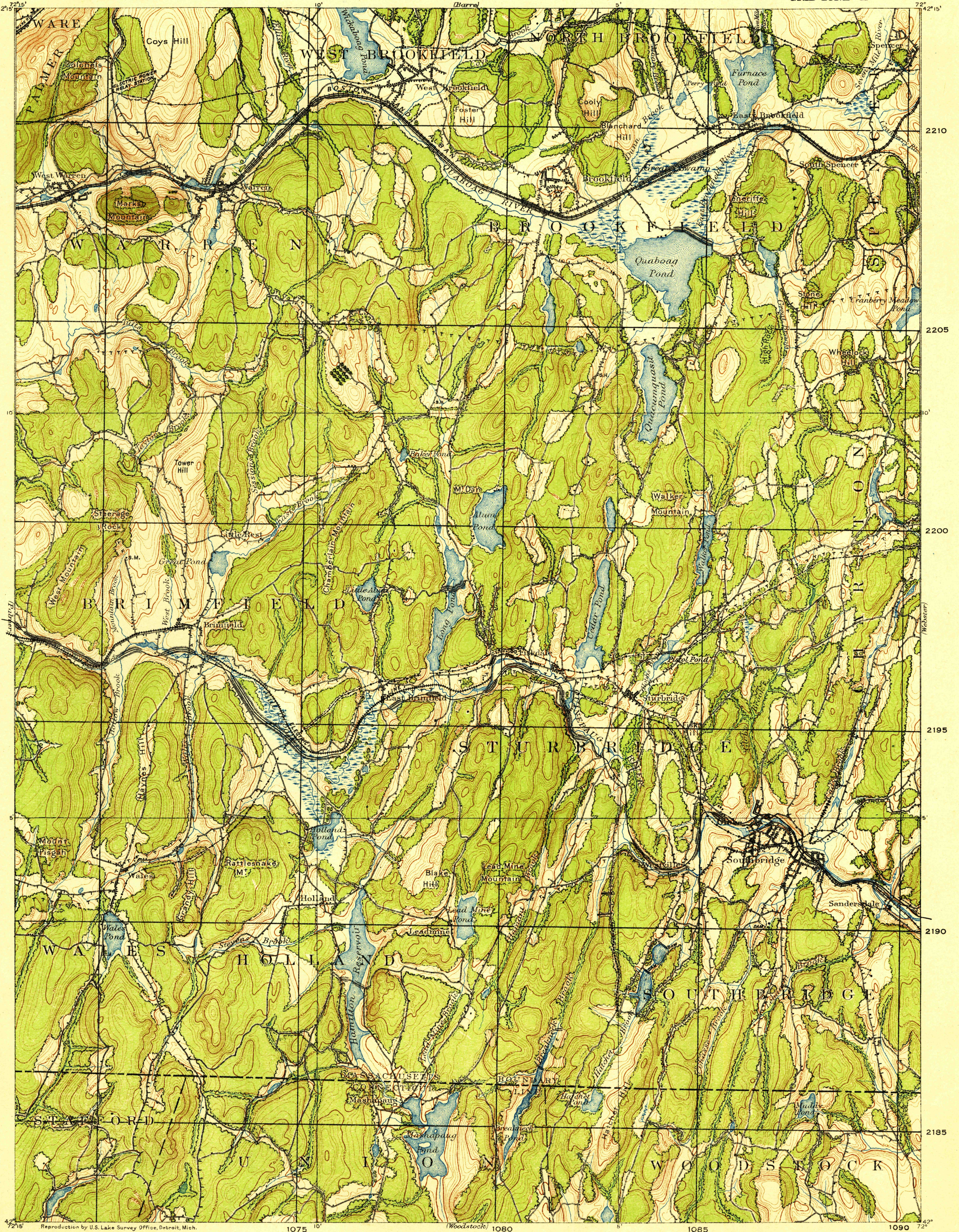

Reproduction by U.S. Lake Survey Office, Detroit, Mich.

Base map from U.S.G.S. engravings.
Corrections and additions by Dept. Engineer,
Eastern Department.

Additional field work and compilation under the
direction of Colonel H. Taylor, Corps of Engineers,
U.S.A., Department Engineer, Eastern Department.

Additional field work by Troop E. U.S. Cavalry,
Nov. 1915. 1st Lieut. J. F. Taubee, 2nd Cav.,
U.S.A.; 2nd Lieut. H. H. McGee, 2nd Cav., U.S.A.,
and 1st Lieut. C. D. Hartman, 3rd Inf., U.S.A., in
charge of party.

Reprint E. R. P. 1921

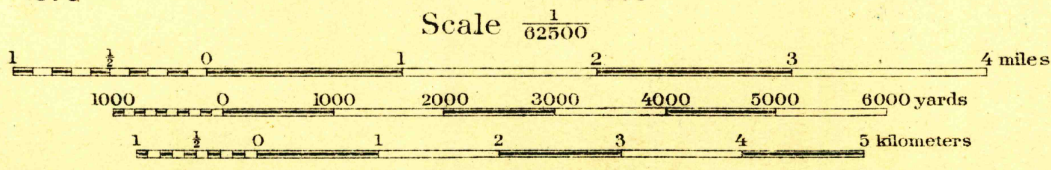

Datum is mean sea level

FIVE THOUSAND YARD GRID COMPUTED FROM "GRID SYSTEM FOR PROGRESSIVE MAPS
IN THE U.S." ZONE A, U.S.C.G.S. SPECIAL PUBLICATION NO. 59.
(THE LAST THREE DIGITS OF THE GRID NUMBERS ARE OMITTED)

NOTE: OFFICERS USING THIS MAP WILL MARK HEREON CORRECTIONS AND ADDITIONS WHICH COME
TO THEIR ATTENTION AND MAIL DIRECT TO "THE CHIEF OF ENGINEERS, WASHINGTON, D.C."

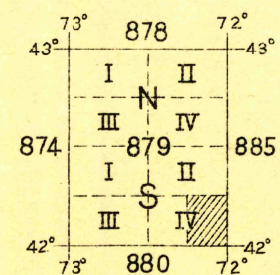

FILE COPY

RETURN TO CENTRAL FILE

APPROXIMATE MEAN
DECLINATION 1921

BROOKFIELD