

(Boston Bay)
42°15'
70°45'
(Middlebury)
70°45'

CORPS OF ENGINEERS, U. S. ARMY
TACTICAL MAP

891-S-III-E/2

MASSACHUSETTS
DUXBURY QUADRANGLE
GRID ZONE "A"

42°15'
2215
2210
10'
2205
2200
5'
2195
2190
42°



Base map from U. S. G. S. engravings.
Corrections and additions by Department Engineer,
Eastern Department.
Additional field work and compilation under the
direction of Col. W. M. Black, Corps of Engineers,
U. S. A., Department Engineer, Eastern Department.
Oct. 1915.
Additional field work under the immediate supervision
of Capt. J. N. Hodges, Corps of Engineers, U. S. A.
Soundings expressed in feet and referred to mean low
water are from U. S. C. & G. S. Charts Nos. 109 and
1208.

Reprint E. R. P. 1921

FILE COPY
Map Information Office

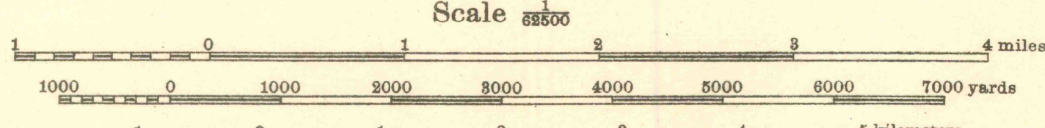

Contour Interval 20 feet
Datum is mean sea level

FIVE THOUSAND YARD GRID COMPUTED FROM "GRID SYSTEM FOR PROGRESSIVE MAPS
IN THE U. S." ZONE A, U. S. C. & G. S. SPECIAL PUBLICATION NO. 59.
(THE LAST THREE DIGITS OF THE GRID NUMBERS ARE OMITTED)

NOTE: OFFICERS USING THIS MAP WILL MARK HEREON CORRECTIONS AND ADDITIONS WHICH COME
TO THEIR ATTENTION AND MAIL DIRECT TO "THE CHIEF OF ENGINEERS, WASHINGTON, D. C."

Central Map Reproduction Plant, Engineer School, Washington Barracks, D.C. 70°30'

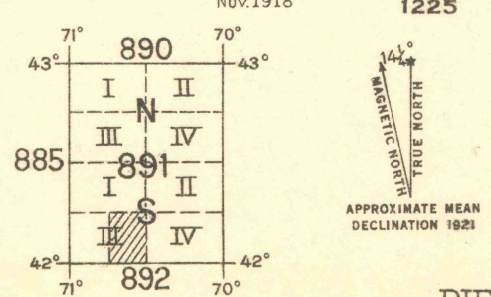

DUXBURY, MASS.