

Base map from U. S. G. S. engravings.  
 Corrections and additions by Department Engineer,  
 Eastern Department.  
 Additional field work and compilation under the  
 direction of Col. W. M. Black, Corps of Engineers,  
 U. S. A., Department Engineer, Eastern Department,  
 Sept. - Oct. 1912.  
 Additional field work under the immediate supervision  
 of 2nd Lieut. E. J. W. Ragsdale, C. A. C., U. S. A.  
 Soundings expressed in feet and referred to mean  
 low water are from U. S. C. & G. S. Chart No. 113.

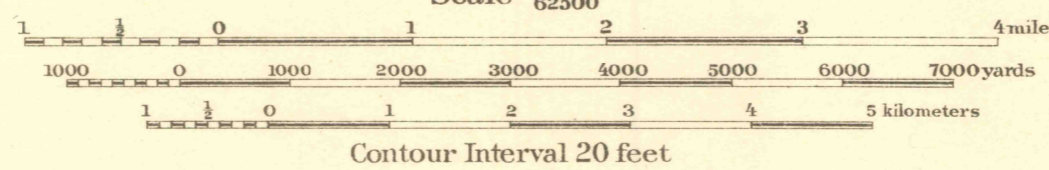

FIVE THOUSAND YARD GRID COMPUTED FROM "GRID SYSTEM FOR PROGRESSIVE MAPS  
 IN THE U. S." ZONE A, U. S. C. & G. S. SPECIAL PUBLICATION NO. 59.  
 (THE LAST THREE DIGITS OF THE GRID NUMBERS ARE OMITTED)

NOTE: OFFICERS USING THIS MAP WILL MARK HEREON CORRECTIONS AND ADDITIONS WHICH COME  
 TO THEIR ATTENTION AND MAIL DIRECT TO "THE CHIEF OF ENGINEERS, WASHINGTON, D. C."

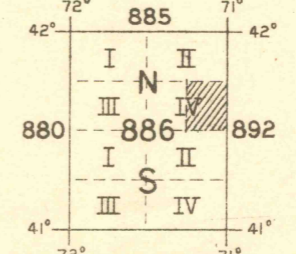

APPROXIMATE MEAN  
 DECLINATION 1921

Reprint E. R. P. 1921  
 BOARD OF SURVEYS & MAPS  
 RECEIVED  
 JAN 11 1922  
 Map Information Office

Board of Surveys & Maps  
 FILE COPY  
 Map Information Office

FALL RIVER, MASS., R. I.

MASSACHUSETTS