

(Manchester)

CORPS OF ENGINEERS, U. S. ARMY
TACTICAL MAP

885-N-IV-E/2

MASSACHUSETTS
LAWRENCE QUADRANGLE
GRID ZONE "A"

(Newburyport)



Base map from U. S. G. S. engravings. Surveyed in 1886.
Additional field work and compilation under the direction of
Colonel W. M. Black, Corps of Engineers, Department Engr.,
Eastern Department.
Additional field work by Capt. V. L. Peterson, Corps of Engrs.,
U. S. Army, December 1915.

Reprint E. R. P. 1921

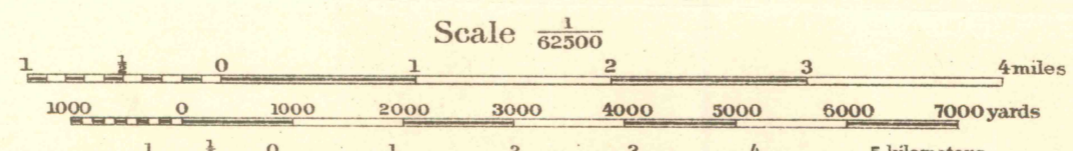

Contour Interval 20 feet
Datum is mean sea level

FIVE THOUSAND YARD GRID COMPUTED FROM "GRID SYSTEM FOR PROGRESSIVE MAPS
IN THE U. S." ZONE A, U. S. C. & G. S. SPECIAL PUBLICATION NO. 59.
(THE LAST THREE DIGITS OF THE GRID NUMBERS ARE OMITTED)

NOTE: OFFICERS USING THIS MAP WILL MARK HEREON CORRECTIONS AND ADDITIONS WHICH COME
TO THEIR ATTENTION AND MAIL DIRECT TO THE CHIEF OF ENGINEERS, WASHINGTON, D. C.

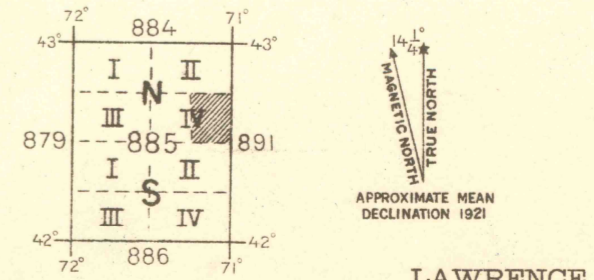

APPROXIMATE MEAN
DECLINATION 1921

LAWRENCE

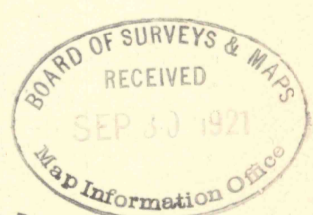

Board of Surveys & Maps
FILE COPY
Map Information Office

Mass.

(Framingham)

(Boston Bay)