

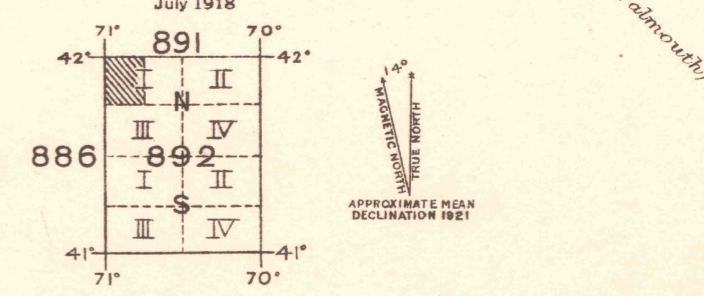

Base map from U. S. G. S. engravings.
Corrections and additions by Department Engineer,
Eastern Department.
Additional field work and compilation under the
direction of Col. W. M. Black, Corps of Engineers,
U. S. A., Department Engineer, Eastern Department,
Nov. 1915.
Additional field work under the immediate supervision
of Capt. J. N. Hodges, Corps of Engineers, U. S. A.

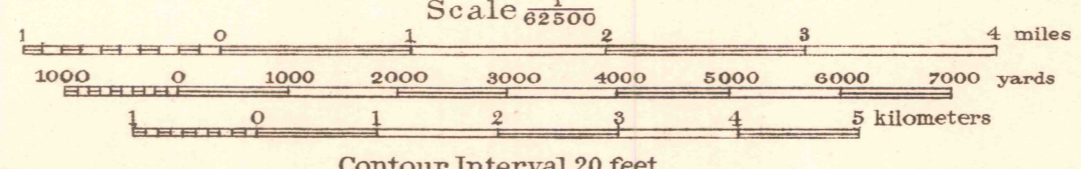

Reprint, E. R. P. 1921.

NOTE: OFFICERS USING THIS MAP WILL MARK HEREON CORRECTIONS AND ADDITIONS WHICH COME TO THEIR ATTENTION AND MAIL DIRECT TO THE CHIEF OF ENGINEERS, WASHINGTON, D. C.

MIDDLEBORO, 17455.