

CORPS OF ENGINEERS, U. S. ARMY
TACTICAL MAP

886-N-II-W/2

MASSACHUSETTS - RHODE ISLAND
PROVIDENCE QUADRANGLE
GRID ZONE "A"

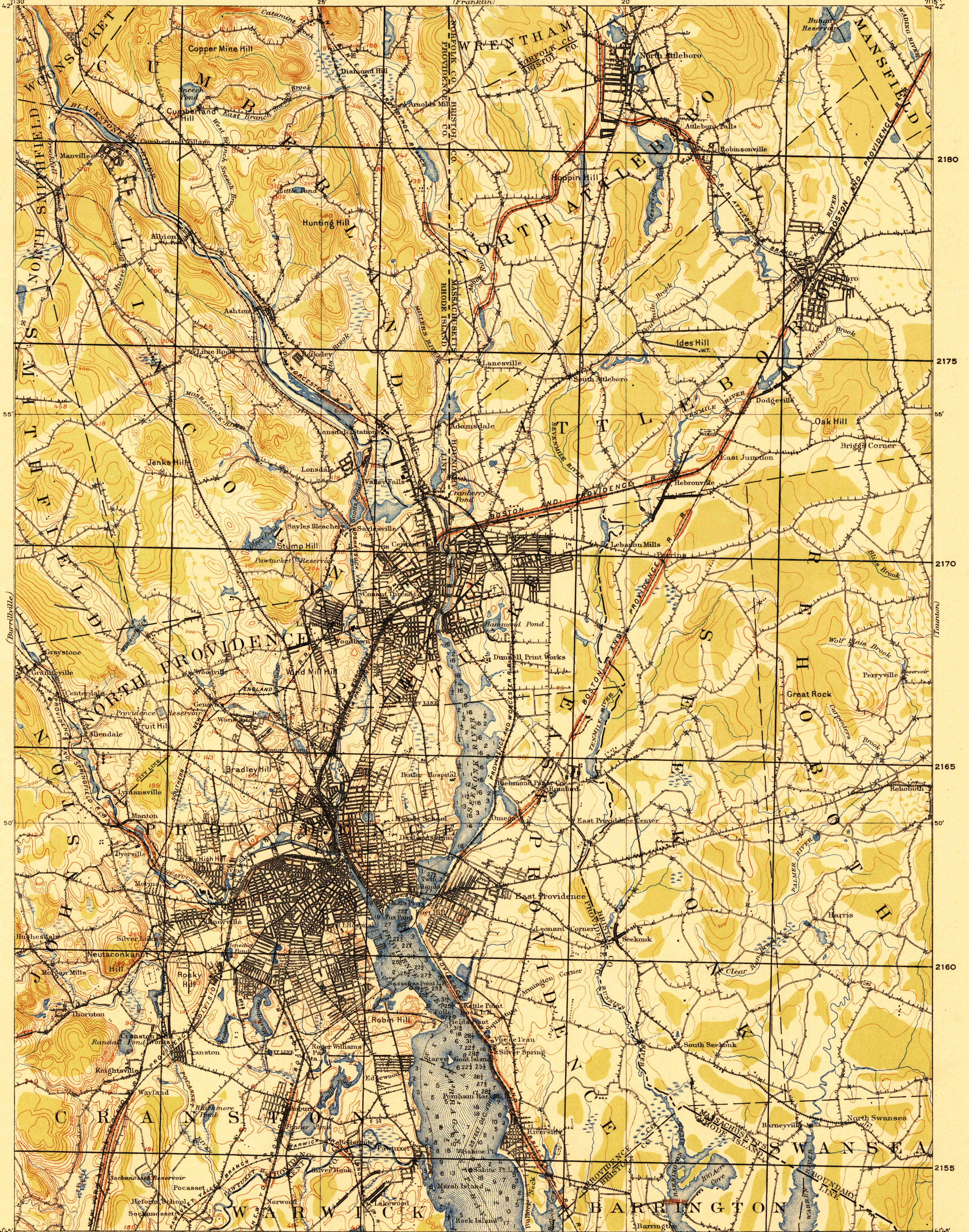

Base map from U. S. G. S. engravings.
Corrections and additions by Department
Engineer, Eastern Department.
Additional Field work and compilation under the direction of
Col. W. M. Black, Corps of Engineers, U. S. A.
Department Engineer, Eastern Department,
November 1915.
Additional Field work under the immediate supervision of
Capt. J. N. Hodges, Corps of Engineers, U. S. A.
Soundings expressed in feet and referred to mean
low water, are from U. S. C. & G. S. Chart, No. 353.
Partial revision by office of Department
Engineer, Northeastern Department.

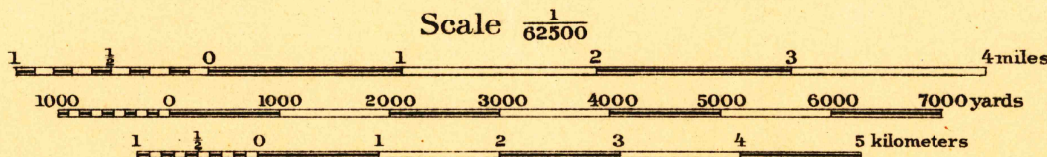

Contour Interval 20 feet
Datum is mean sea level

NOTE: OFFICERS USING THIS MAP WILL MARK HEREON CORRECTIONS AND ADDITIONS WHICH COME
TO THEIR ATTENTION AND MAIL DIRECT TO "THE CHIEF OF ENGINEERS, WASHINGTON, D.C."

FIVE THOUSAND YARD GRID COMPUTED FROM "GRID SYSTEM FOR PROGRESSIVE MAPS
IN THE U. S." ZONE A, U. S. C. & G. S. SPECIAL PUBLICATION NO. 59.
(THE LAST THREE DIGITS OF THE GRID NUMBERS ARE OMITTED.)

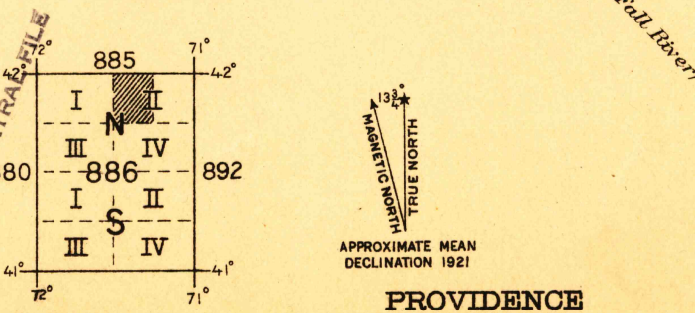

Engineer Reproduction Plant, U. S. Army, Washington Barracks, D.C.
1921