



Middletown, MD
Mapped by the Corps of Engineers, U. S. Army
Edited and published by the Geological Survey

Control by USC&GS and USSCS
Topography from aerial photographs by stereophotogrammetric methods. Aerial photographs taken 1943
Culture revised by the Geological Survey 1953

Polyconic projection. 1927 North American datum
10,000-foot grid based on Maryland coordinate system
1000-meter Universal Transverse Mercator grid ticks.
zone 18, shown in blue

Revisions shown in purple compiled by the Geological Survey from
aerial photographs taken 1971. This information not field checked

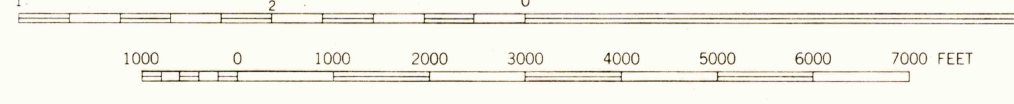
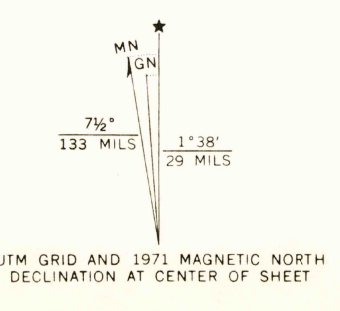

CONTOUR INTERVAL 20 FEET
DATUM IS MEAN SEA LEVEL

THIS MAP COMPLIES WITH NATIONAL MAP ACCURACY STANDARDS
FOR SALE BY U. S. GEOLOGICAL SURVEY, WASHINGTON, D. C. 20242
A FOLDER DESCRIBING TOPOGRAPHIC MAPS AND SYMBOLS IS AVAILABLE ON REQUEST

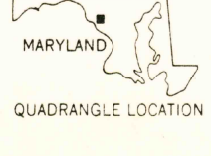

ROAD CLASSIFICATION

Heavy duty	Light duty
Medium duty	Unimproved dirt
U. S. Route	State Route

MIDDLETOWN, MD.
NE/4 ANTIETAM 15' QUADRANGLE
N3922.5-W7730.7.5

1953
PHOTOREVISED 1971
AMS 5462 1 NE-SERIES V833

USGS
HISTORICAL FILE
TOPOGRAPHIC DIVISION

MAR 21 1972